

# MINI-RIB

# INSTALLATION

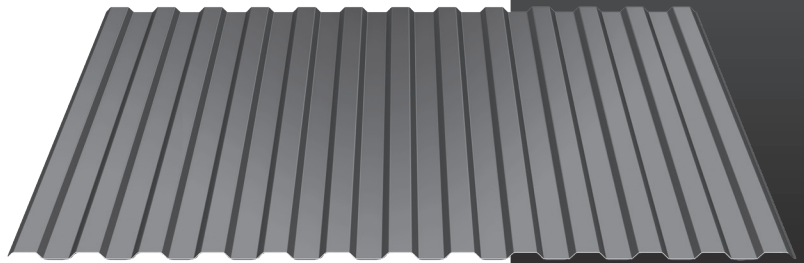

# TABLE OF CONTENTS

PAGE NUMBER:	DETAIL DESCRIPTION
A-1.....	TABLE OF CONTENTS
A-2.....	GENERAL NOTES
B-1.....	FASTENER PATTERNS
<u>STANDARD VERTICAL INSTALLATION DETAILS - STEEL FRAMING</u>	
C-1.....	VERTICAL BASE DETAIL
C-2.....	VERTICAL JAMB DETAIL
C-3.....	VERTICAL JAMB (OFF MODULE) DETAIL
C-4.....	VERTICAL HEAD DETAIL
C-5.....	VERTICAL SILL DETAIL
C-6.....	VERTICAL OUTSIDE CORNER DETAIL
C-7.....	VERTICAL OUTSIDE CORNER (OFF MODULE) DETAIL
C-8.....	VERTICAL INSIDE CORNER DETAIL
C-9.....	VERTICAL INSIDE CORNER (OFF MODULE) DETAIL
<u>STANDARD VERTICAL INSTALLATION DETAILS - PLYWOOD</u>	
C-10.....	VERTICAL BASE DETAIL
C-11.....	VERTICAL JAMB DETAIL
C-12.....	VERTICAL JAMB (OFF MODULE) DETAIL
C-13.....	VERTICAL HEAD DETAIL
C-14.....	VERTICAL SILL DETAIL
C-15.....	VERTICAL OUTSIDE CORNER DETAIL
C-16.....	VERTICAL OUTSIDE CORNER (OFF MODULE) DETAIL
C-17.....	VERTICAL INSIDE CORNER DETAIL
C-18.....	VERTICAL INSIDE CORNER (OFF MODULE) DETAIL
<u>STANDARD HORIZONTAL INSTALLATION DETAILS - STEEL FRAMING</u>	
C-19.....	HORIZONTAL BASE DETAIL
C-20.....	HORIZONTAL JAMB DETAIL
C-21.....	HORIZONTAL HEAD DETAIL
C-22.....	HORIZONTAL HEAD (OFF MODULE) DETAIL
C-23.....	HORIZONTAL SILL DETAIL
C-24.....	HORIZONTAL SILL (OFF MODULE) DETAIL
C-25.....	HORIZONTAL OUTSIDE CORNER DETAIL
C-26.....	HORIZONTAL INSIDE CORNER DETAIL
<u>STANDARD HORIZONTAL INSTALLATION DETAILS - PLYWOOD</u>	
C-27.....	HORIZONTAL BASE DETAIL
C-28.....	HORIZONTAL JAMB DETAIL
C-29.....	HORIZONTAL HEAD DETAIL
C-30.....	HORIZONTAL HEAD (OFF MODULE) DETAIL
C-31.....	HORIZONTAL SILL DETAIL
C-32.....	HORIZONTAL SILL (OFF MODULE) DETAIL
C-33.....	HORIZONTAL OUTSIDE CORNER DETAIL
C-34.....	HORIZONTAL INSIDE CORNER DETAIL
C-35.....	TYPICAL TRIM LAPS DETAILS



## GENERAL NOTES

The details shown on the following pages are suggestions or guidelines for installing the Mini-Rib wall panel system over wall girts and plywood. The installation details shown here are proven methods of construction, but they are not intended to cover all building requirements, designs or codes. The details may require changes or revisions due to individual project conditions.

Installation procedures shall be in accordance with the manufacturer's printed instructions, details or approved shop drawings. Installers should thoroughly familiarized themselves with all instructions prior to beginning the installation process.

The designer/installer is responsible to ensure the following:

That the details here meet the particular building requirements.

Awareness of and allowance for expansion/contraction of the wall panels.

That adequate water-tightness is maintained.

That a proper uniform substructure is used to avoid panel distortion and that the substructure meets necessary code requirements.

That all supporting members have been examined and are straight, level and plumb.

McElroy Metal can provide all flashings and accessories shown in the installation drawings unless noted otherwise. Panels, flashing and trim shall be installed true and in proper alignment with any exposed fasteners equally spaced for the best appearance. Sealant shall be field applied on a clean, dry surface.

Some field cutting and fitting of panels and flashings is to be expected and to be considered a part of normal installation work. Workmanship shall be of the best industry standards and with installation performed by experienced metal craftsmen.

Oil canning of metal panels is inherent in metal and is not a cause for rejection. Striated panels are recommended to reduce the appearance of oil canning.

Contents of this manual are subject to change without notice. To confirm this book is the most current copy, please visit McElroy Metal's website at [www.mcelroymetal.com](http://www.mcelroymetal.com).

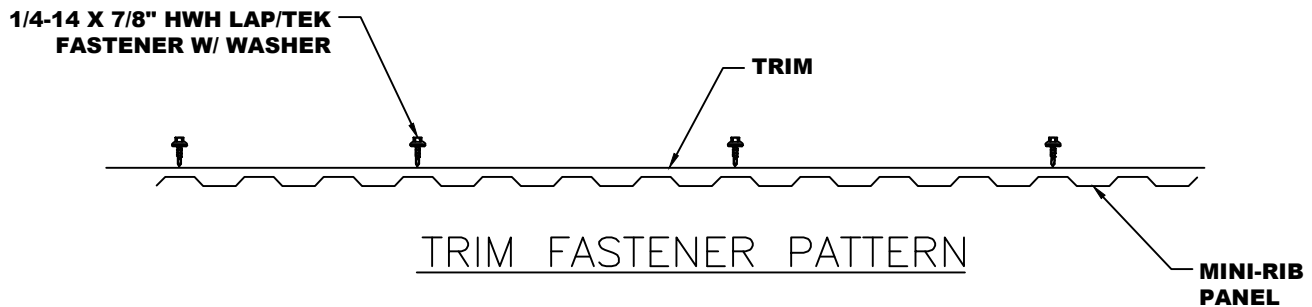
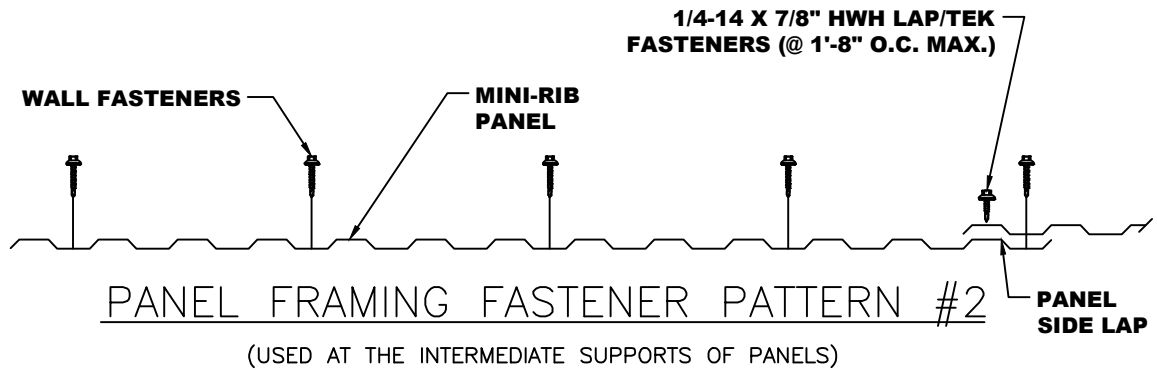
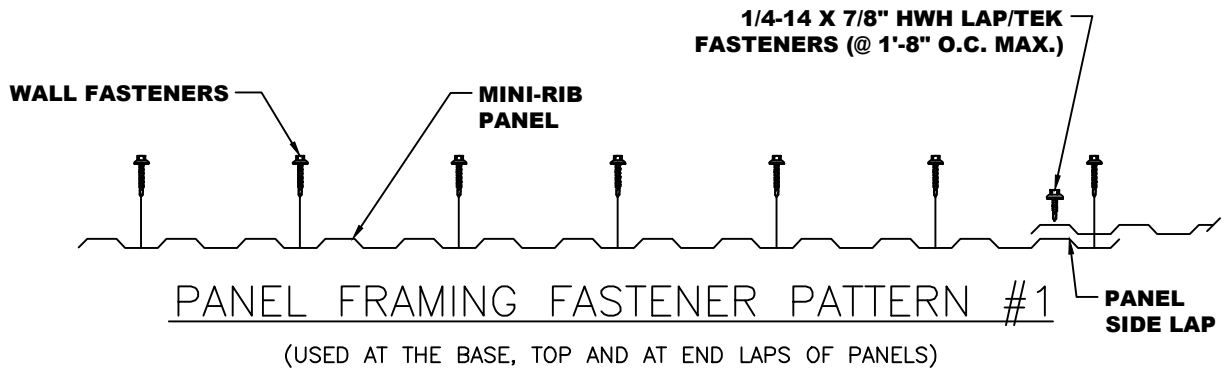

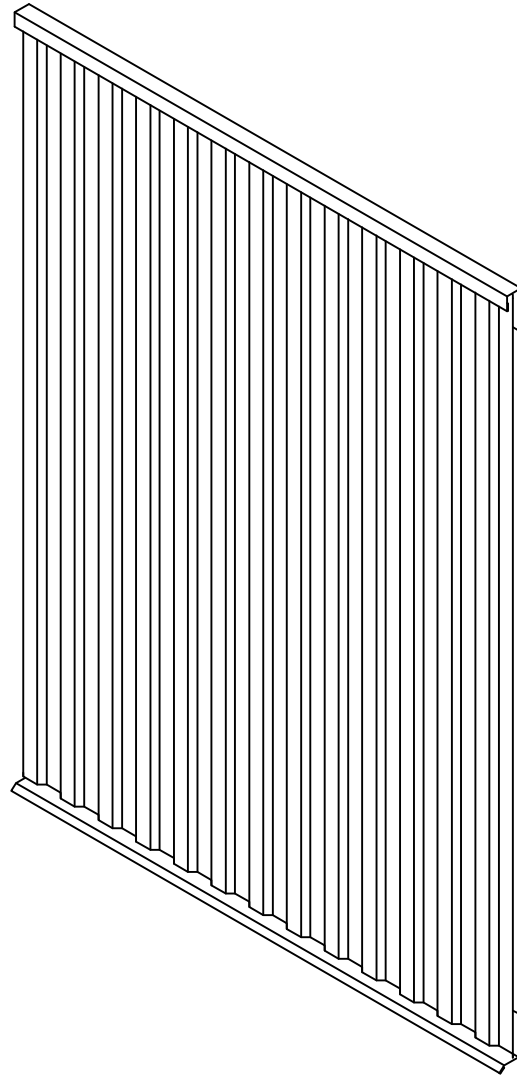

**STANDARD VERTICAL INSTALLATION DETAILS**

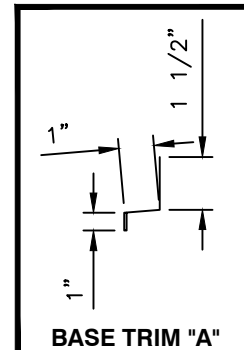
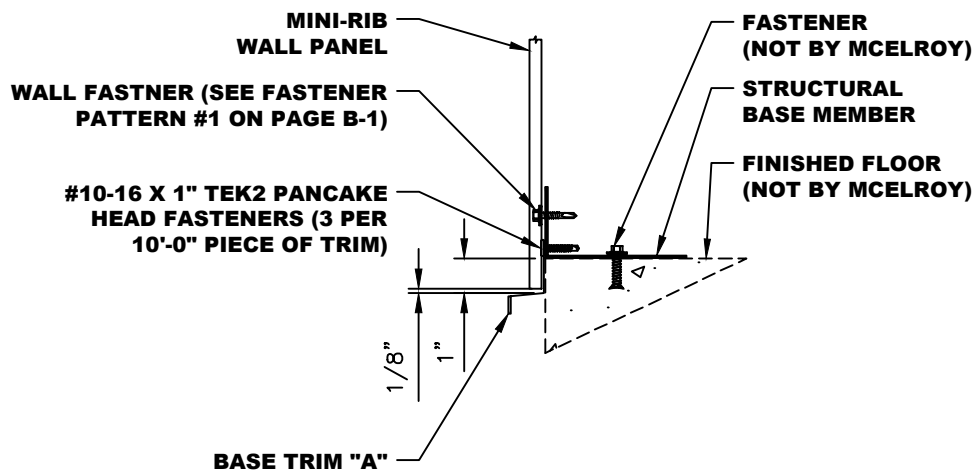

- NOTES:**
1. Base Structural Member set flush with edge of finished floor.
  2. Set Base Trim "A" 1" down face of finished floor and attach to Structural Base Member with #10-16 x 1" Tek2 Pancake Head Fasteners. Use three (3) fasteners per 10'-0" piece of trim.
  3. Set Mini-Rib Wall Panel in place. Make sure to leave a 1/8" gap between base trim and panel.
  4. Attach Mini-Rib Panel with Wall Fasteners per Fastening Pattern #1 shown on page B-1 of this manual.

\*NOTE: SOME TRIM ITEMS AND FASTENERS HAVE BEEN REMOVED FOR CLARITY OF ISOMETRIC DETAIL.

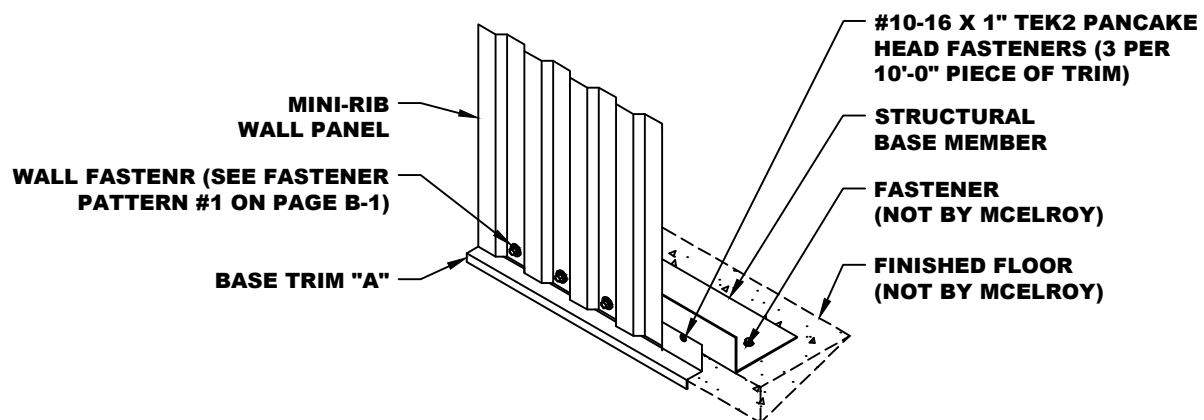

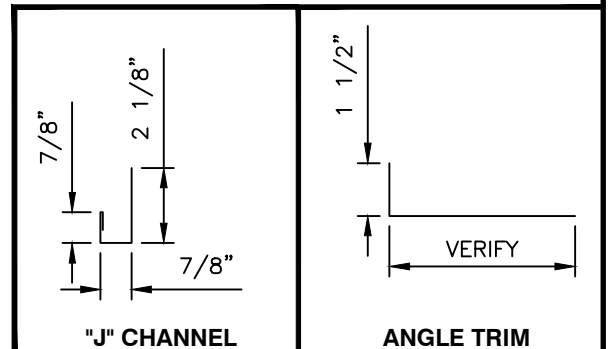
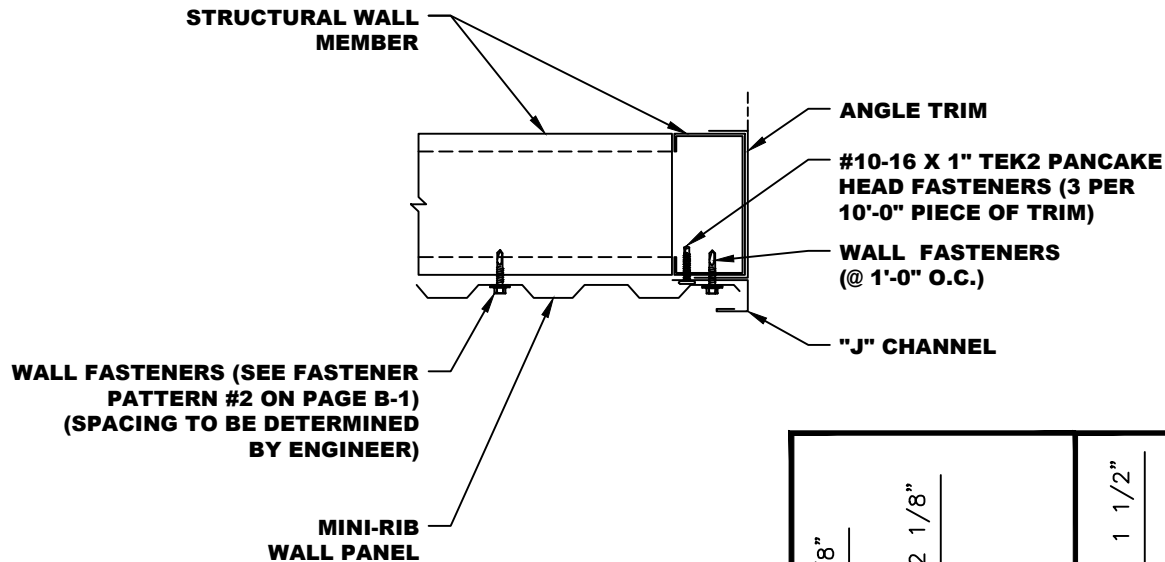

- NOTES:**
1. Attach Angle Trim to Structural Wall Member. If you ordered trim wider than Structural Member, fold back as shown in detail. You can hold in place with temporary fasteners if needed.
  2. Set "J" Channel in place as shown and attach to Structural Wall Member with #10-16 x 1" Tek2 Pancake Head Fasteners. Use three (3) fasteners per 10'-0" piece of trim.
  3. Set Mini-Rib Wall Panel in place and fasten to Structural Wall Members with Wall Fasteners per Fastener Pattern #2 shown on page B-1 of this manual.

\*NOTE: SOME TRIM ITEMS AND FASTENERS HAVE BEEN REMOVED FOR CLARITY OF ISOMETRIC DETAIL.

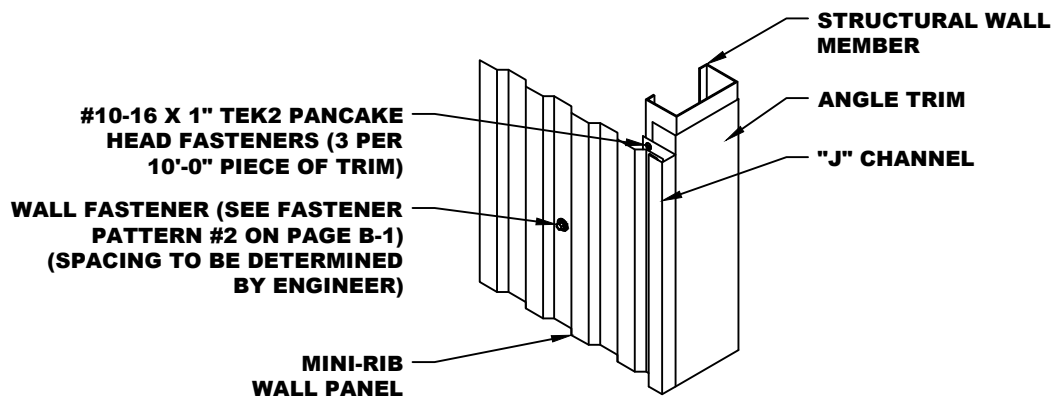

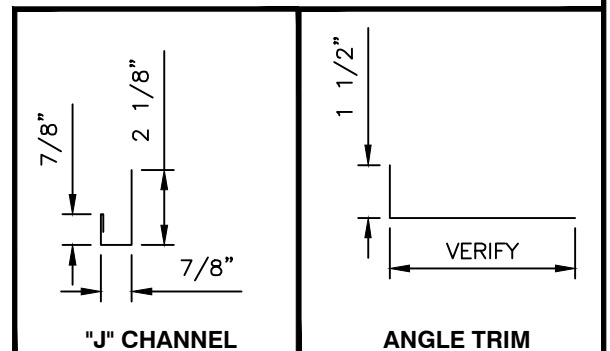
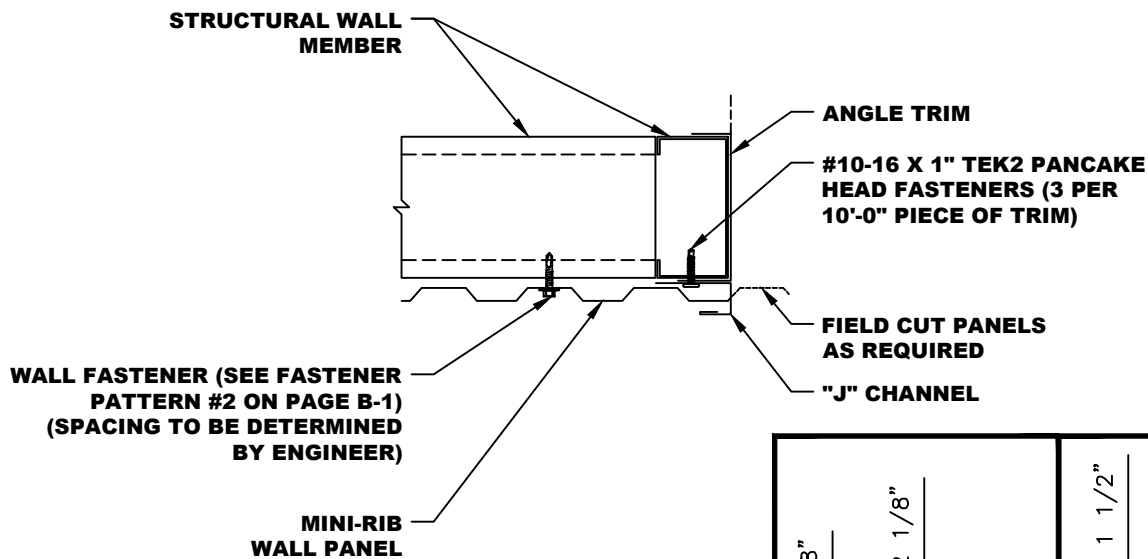

- NOTES:**
1. Attach Angle Trim to Structural Wall Member. If you ordered trim wider than Structural Member, fold back as shown in detail. You can hold in place with temporary fasteners if needed.
  2. Set "J" Channel in place as shown and attach to Structural Wall Member with #10-16 x 1" Tek2 Pancake Head Fasteners. Use three (3) fasteners per 10'-0" piece of trim.
  3. Field Cut Mini-Rib Panel as required and set in place and fasten to Structural Wall Members with Wall Fasteners per Fastener Pattern #2 on page B-1 on this manual.

\*NOTE: SOME TRIM ITEMS AND FASTENERS HAVE BEEN REMOVED FOR CLARITY OF ISOMETRIC DETAIL.

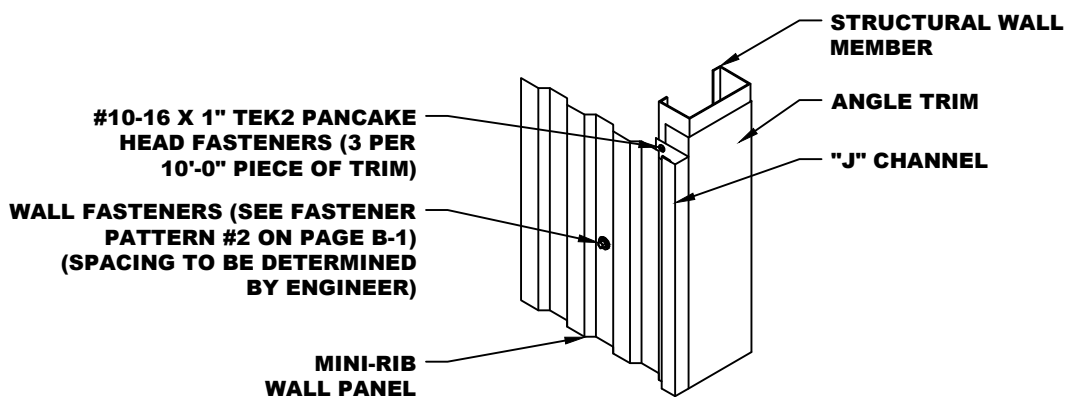



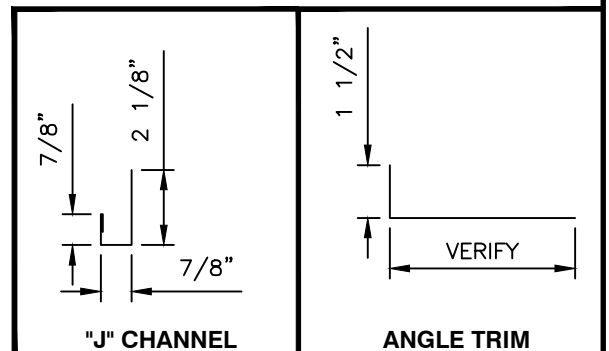
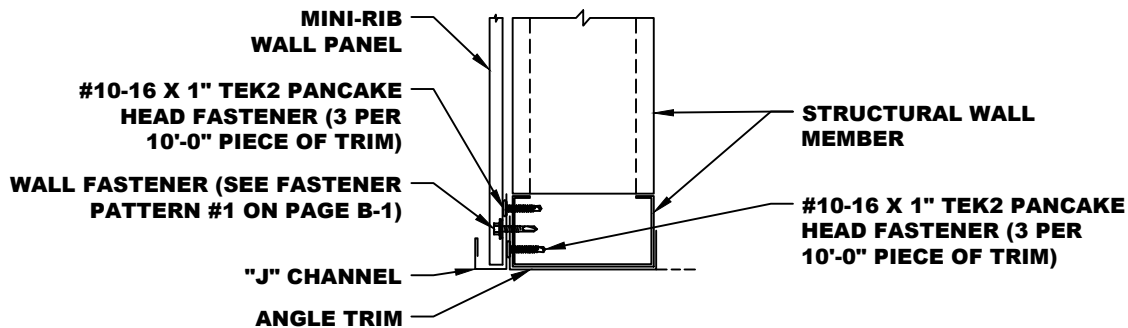

- NOTES:**
1. Attach Angle Trim to Structural Wall Member. If you ordered trim wider than Structural Member, fold back as shown in detail. Attach with #10-16 x 1" Tek2 Pancake Head Fasteners three (3) per 10'-0" piece of trim.
  2. Set "J" Channel in place as shown and attach to Structural Wall Member with #10-16 x 1" Tek2 Pancake Head Fasteners three (3) fasteners per 10'-0" piece of trim.
  3. Set Mini-Rib Wall Panel in place and fasten to Structural Wall Members with Wall Fasteners per Fastener Pattern #1 on page B-1 of this manual.

\*NOTE: SOME TRIM ITEMS AND FASTENERS HAVE BEEN REMOVED FOR CLARITY OF ISOMETRIC DETAIL.

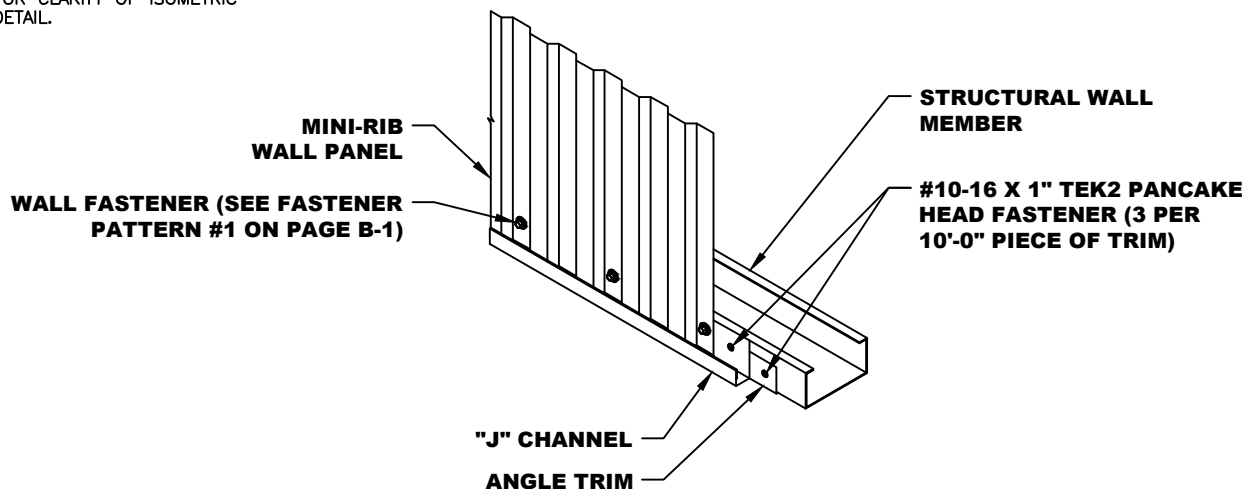

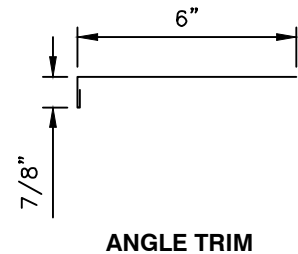
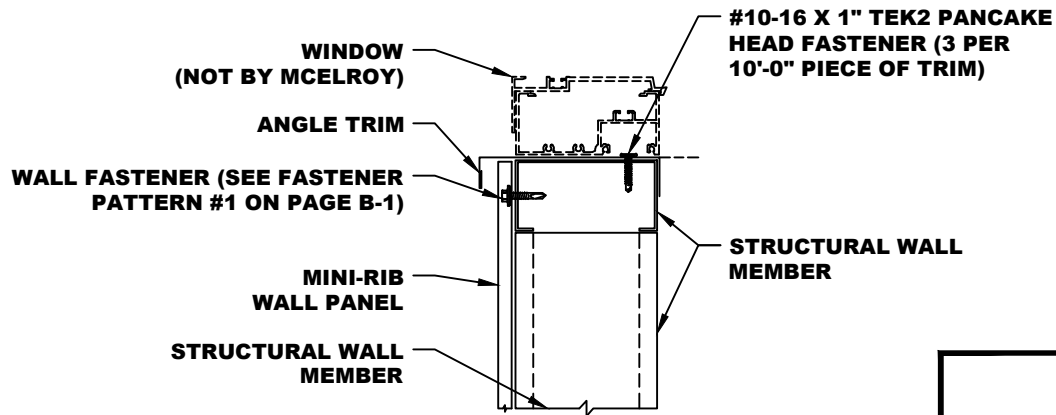

- NOTES:**
1. Measure and cut Mini-Rib Panel to fit around window as required.
  2. Set Mini-Rib Panel in place and attach to Structural Wall Member with Wall Fasteners per Fastener Pattern #1 on page B-1 of this manual.
  3. Cut Angle Trim to fit as required and attach to Structural Wall Member with #10-16 x 1" Tek2 Pancake Fasteners at three (3) per 10'-0" piece of trim.

\*NOTE: SOME TRIM ITEMS AND FASTENERS HAVE BEEN REMOVED FOR CLARITY OF ISOMETRIC DETAIL.

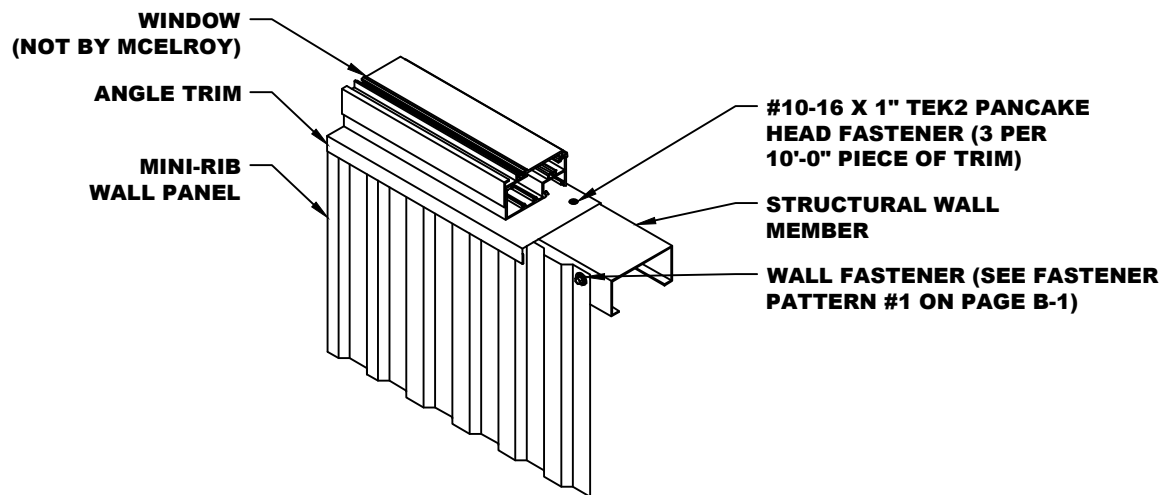

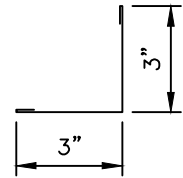
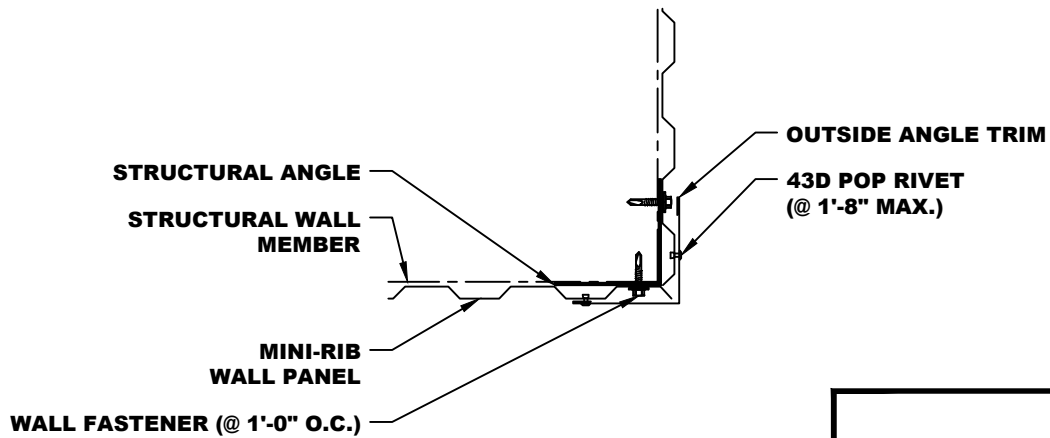

**OUTSIDE ANGLE TRIM**

- NOTES:**
1. Attach Mini-Rib Panels to framework with Wall Fasteners at 1'-0" O.C.
  2. Outside Corner Trim to run from Base Trim to top of wall panel.
  3. Attach Outside Corner Trim to Mini-Rib Panel with 43D Pop Rivets at 1'-8" O.C. (Max.).

\*NOTE: SOME TRIM ITEMS AND FASTENERS HAVE BEEN REMOVED FOR CLARITY OF ISOMETRIC DETAIL.

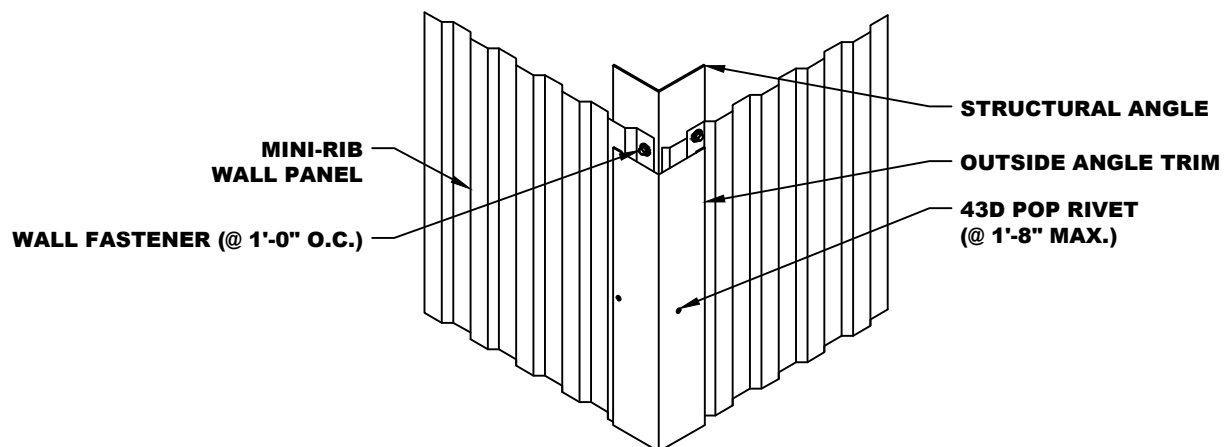

# VERTICAL OUTSIDE CORNER (OFF MODULE) DETAIL

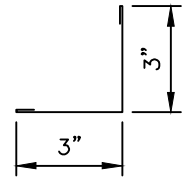
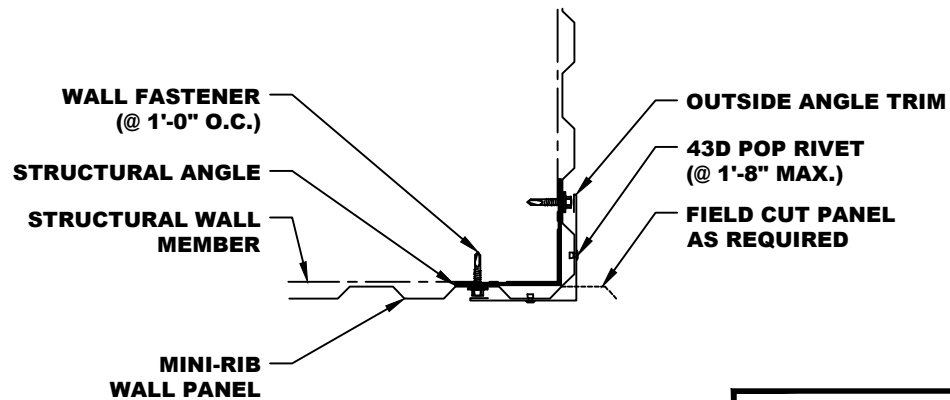

OUTSIDE ANGLE TRIM

- NOTES:** 1. Measure and Field Cut Mini-Rib Panel as required. Attach panels to framework with Wall Fasteners at 1'-0" O.C.  
 2. Outside Corner Trim to run from Base Trim to top of wall panel.  
 3. Attach Outside Corner Trim to Mini-Rib Panel with 43D Pop Rivets at 1'-8" O.C. (Max.).

\*NOTE: SOME TRIM ITEMS AND FASTENERS HAVE BEEN REMOVED FOR CLARITY OF ISOMETRIC DETAIL.

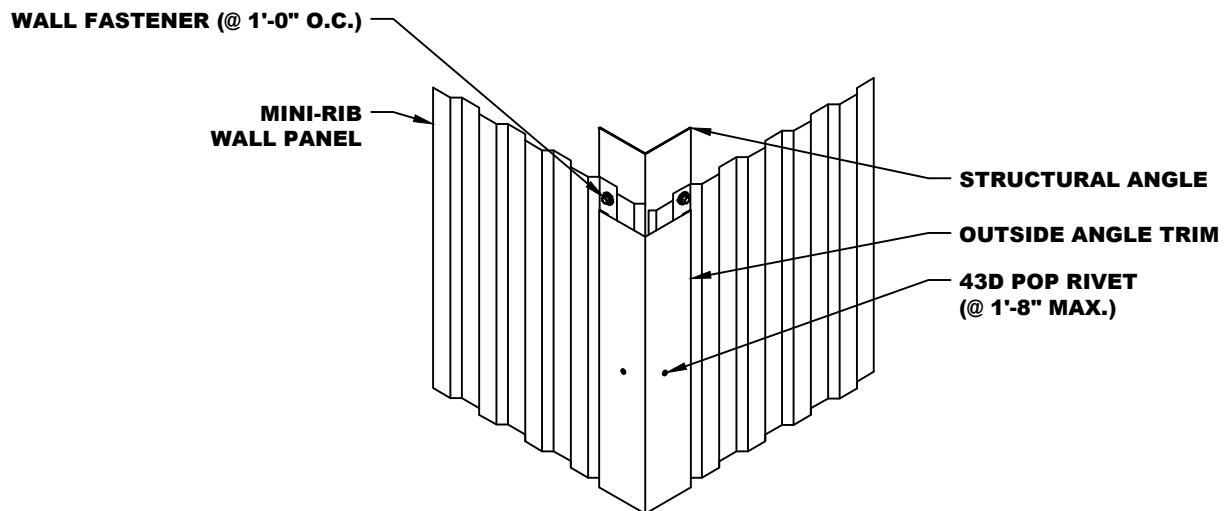

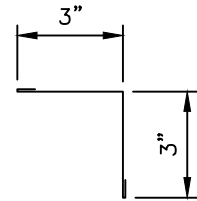
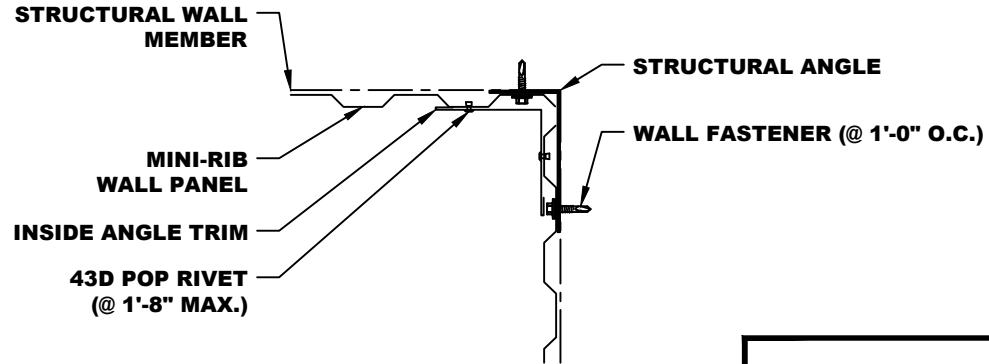

INSIDE ANGLE TRIM

- NOTES:**
1. Attach Mini-Rib Panels to framework with Wall Fasteners at 1'-0" O.C.
  2. Inside Corner Trim to run from Base Trim to top of wall panel.
  3. Attach Inside Corner Trim to Mini-Rib Panel with 43D Pop Rivets at 1'-8" O.C. (Max.).

\*NOTE: SOME TRIM ITEMS AND FASTENERS HAVE BEEN REMOVED FOR CLARITY OF ISOMETRIC DETAIL.

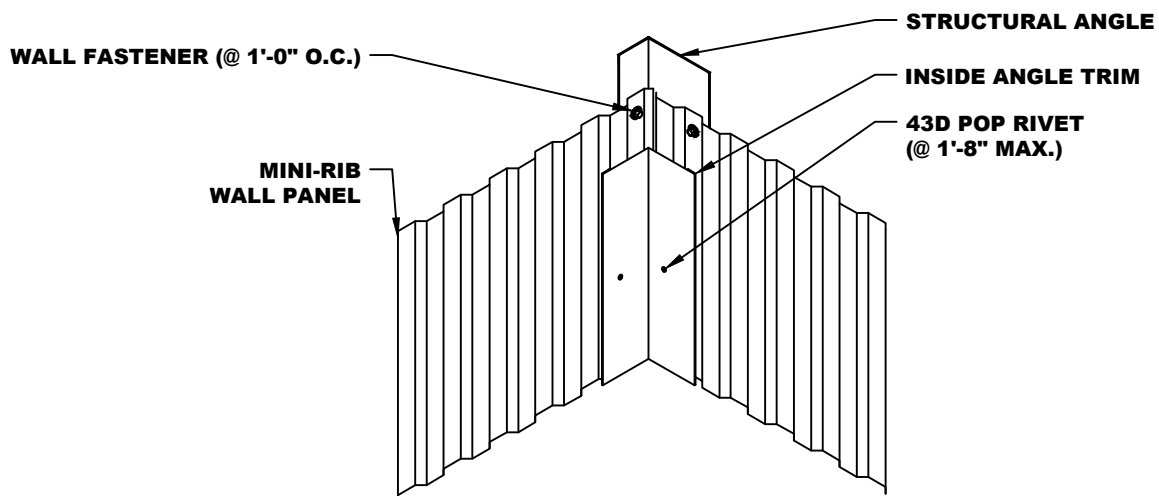

# **VERTICAL INSIDE CORNER (OFF MODULE) DETAIL**

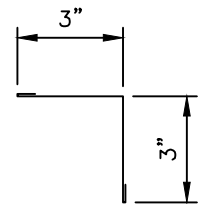
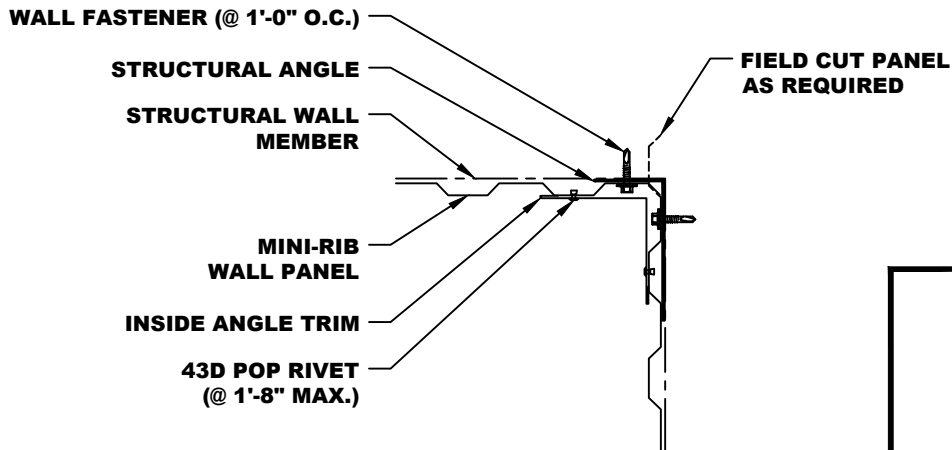

**INSIDE ANGLE TRIM**

- NOTES:** 1. Measure and Field Cut Mini-Rib Panel as require. Attach panels to framework with Wall Fastener at 1'-0" O.C.  
 2. Inside Corner Trim to run from Base Trim to top of wall panel.  
 3. Attach Inside Corner Trim to Mini-Rib Panel with 43D Pop Rivets at 1'-8" O.C. (Max.).

\*NOTE: SOME TRIM ITEMS AND FASTENERS HAVE BEEN REMOVED FOR CLARITY OF ISOMETRIC DETAIL.

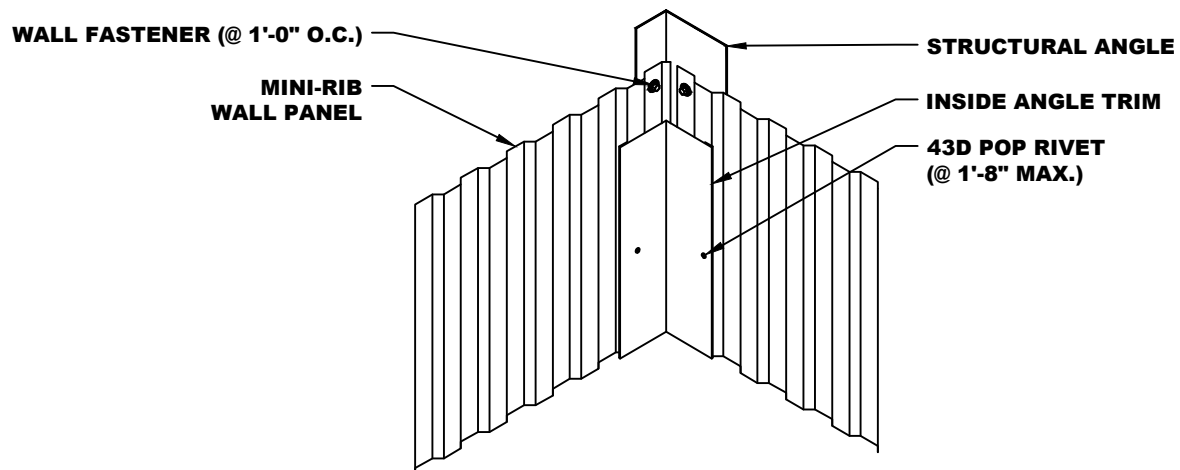

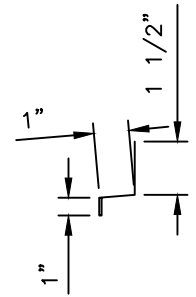
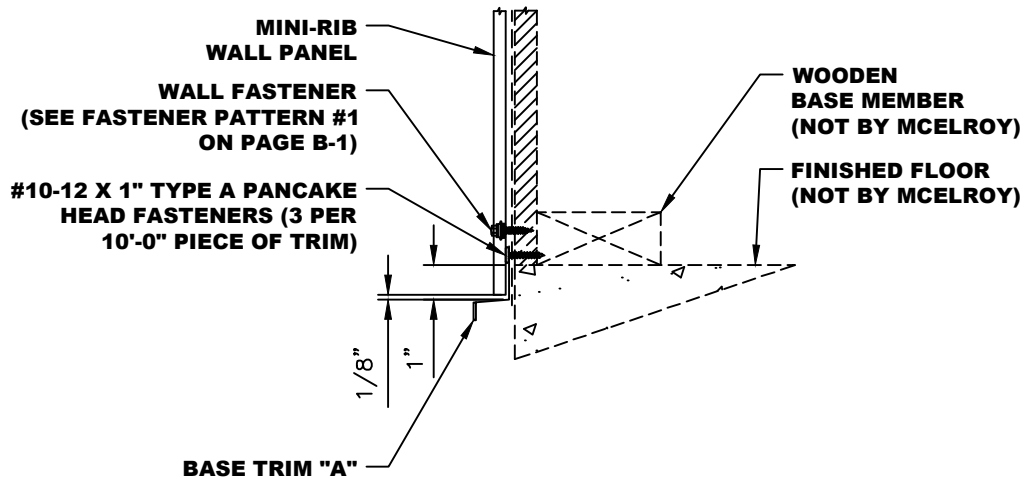

BASE TRIM "A"

- NOTES:**
1. Plywood set flush with edge of finished floor.
  2. Set Base Trim "A" 1" down face of finished floor and attach to Plywood with #10-12 x 1" Type A Pancake Head Fasteners. Use three (3) fasteners per 10'-0" piece of trim.
  3. Set Mini-Rib Wall Panel into place. Make sure to leave a 1/8" gap between base trim and panel.
  4. Attach panel with Wall Fasteners per Fastening Pattern #1 shown on page B-1 of this manual.

\*NOTE: SOME TRIM ITEMS AND FASTENERS HAVE BEEN REMOVED FOR CLARITY OF ISOMETRIC DETAIL.

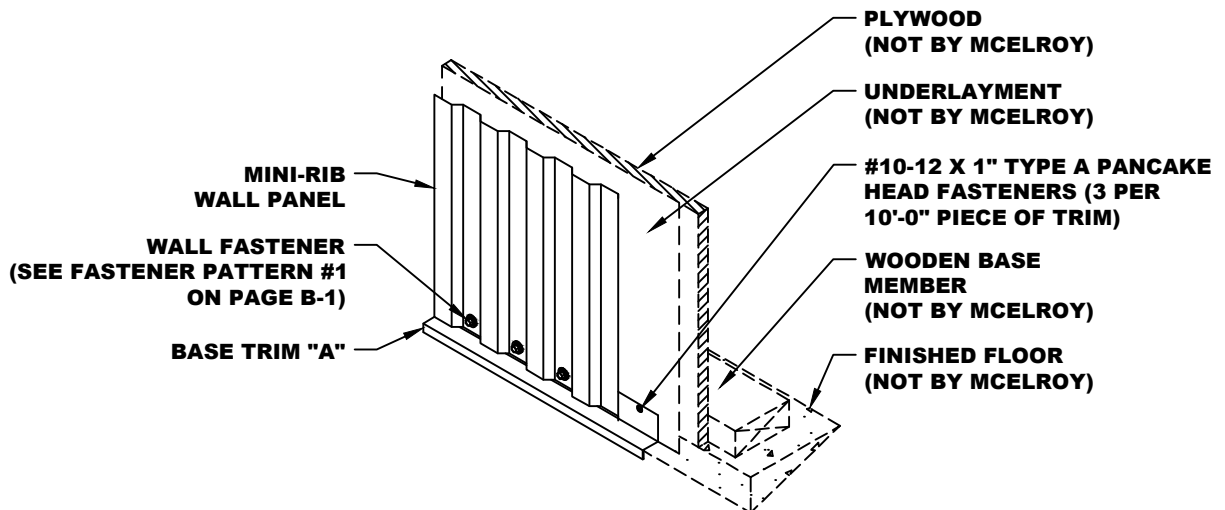

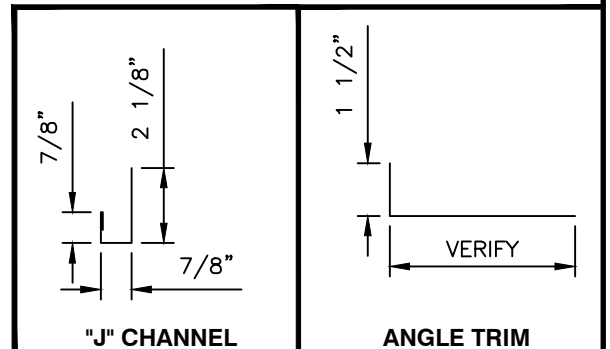
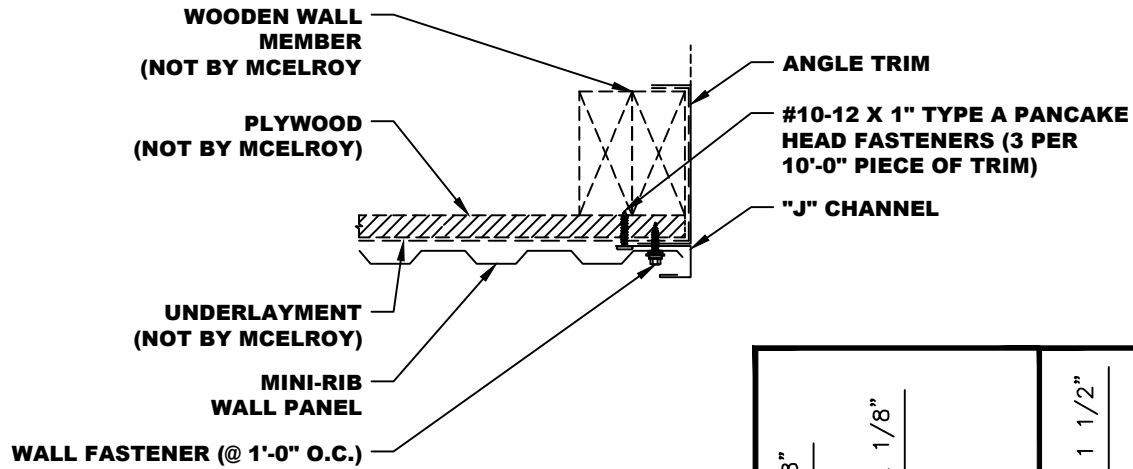

- NOTES:**
1. Attach Angle Trim to Structural Wall Member. If you ordered trim wider than Structural Member, fold back as shown in detail. You can hold in place with temporary fasteners if needed.
  2. Set "J" Channel in place as shown and attach to Structural Wall Member with #10-12 x 1" Type A Pancake Head Fasteners. Use three (3) fasteners per 10'-0" piece of trim.
  3. Set Mini-Rib Wall Panel in place and fasten to Plywood with Wall Fasteners at 1'-0" O.C.

\*NOTE: SOME TRIM ITEMS AND FASTENERS HAVE BEEN REMOVED FOR CLARITY OF ISOMETRIC DETAIL.

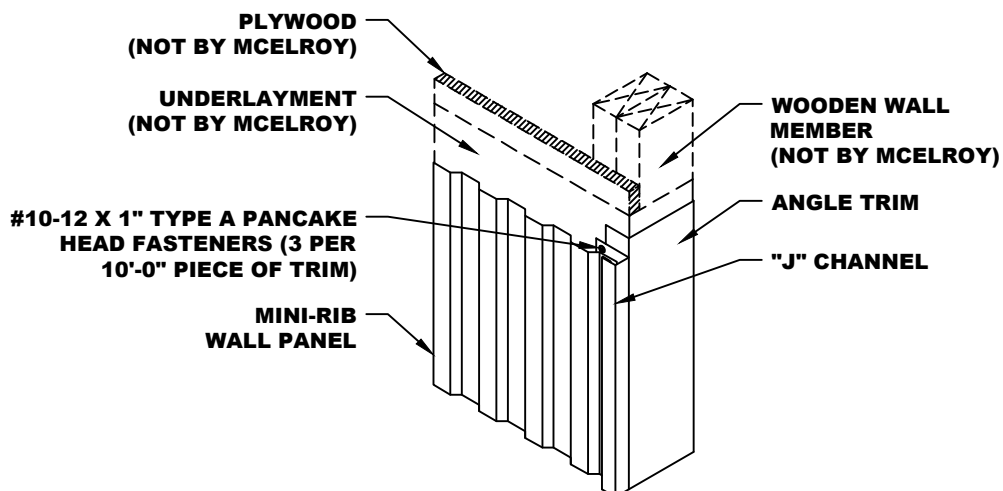



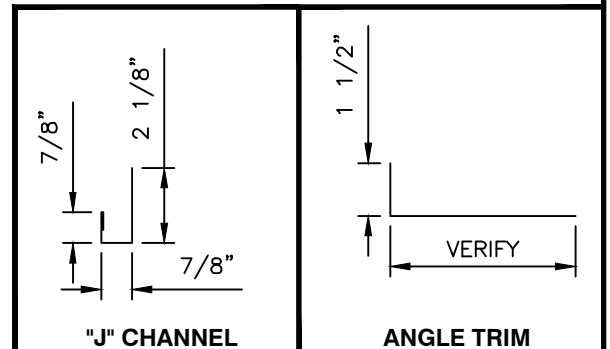
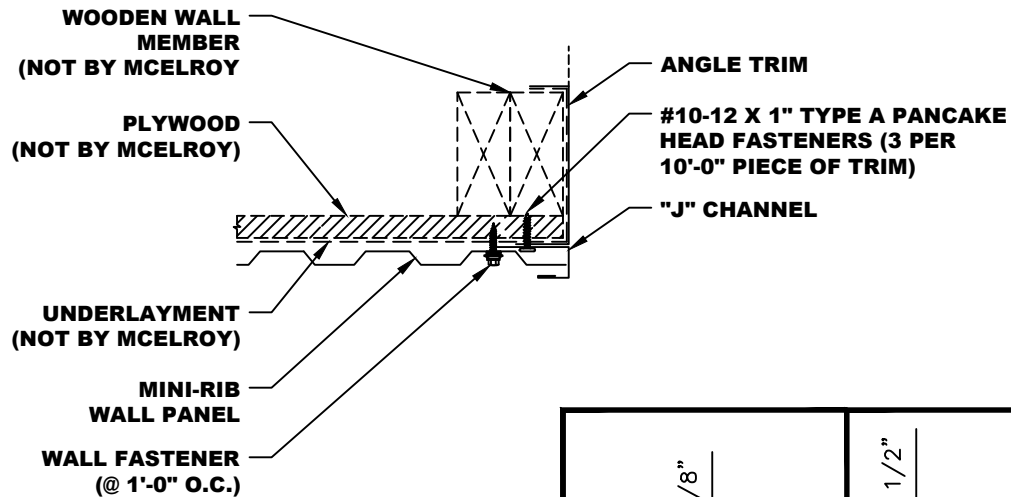

- NOTES:**
1. Attach Angle Trim to Structural Wall Member. If you ordered trim wider than Structural Member, fold back as shown in detail. You can hold in place with temporary fasteners if needed.
  2. Set "J" Channel in place as shown and attach to Structural Wall Member with #10-12 x 1" Type A Pancake Head Fasteners. Use three (3) fasteners per 10'-0" piece of trim.
  3. Field Cut Mini-Rib Panel as required and set in place and attach to Plywood with Wall Fasteners at 1'-0" O.C.

\*NOTE: SOME TRIM ITEMS AND FASTENERS HAVE BEEN REMOVED FOR CLARITY OF ISOMETRIC DETAIL.

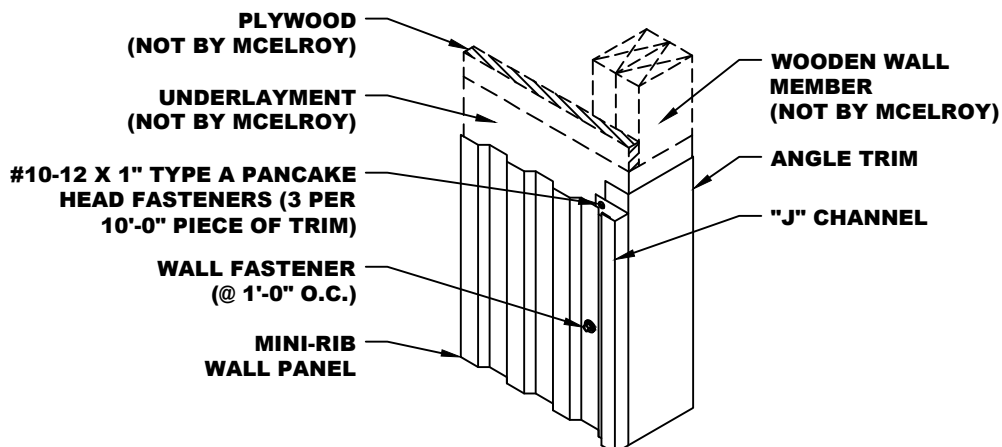

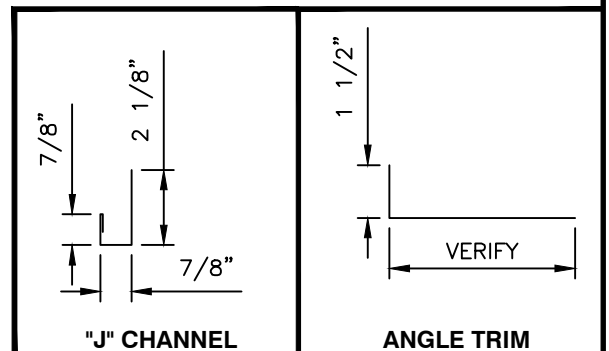
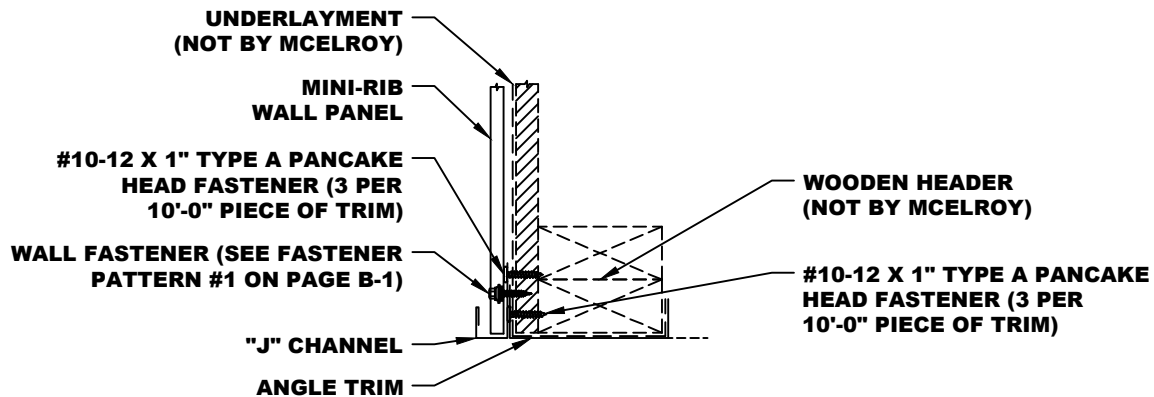

- NOTES:**
1. Attach Angle Trim to Structural Wall Member. If you ordered trim wider than Structural Member, fold back as shown in detail. Attach with #10-12 x 1" Type A Pancake Head Fasteners three (3) per 10'-0" piece of trim.
  2. Set "J" Channel in place as shown and attach to Structural Wall Member with #10-16 x 1" Tek2 Pancake Head Fasteners three (3) fasteners per 10'-0" piece of trim.
  3. Set Mini-Rib Wall Panel in place and fasten to Plywood with Wall Fasteners per Fastener Pattern #1 on page B-1 of this manual.

\*NOTE: SOME TRIM ITEMS AND FASTENERS HAVE BEEN REMOVED FOR CLARITY OF ISOMETRIC DETAIL.

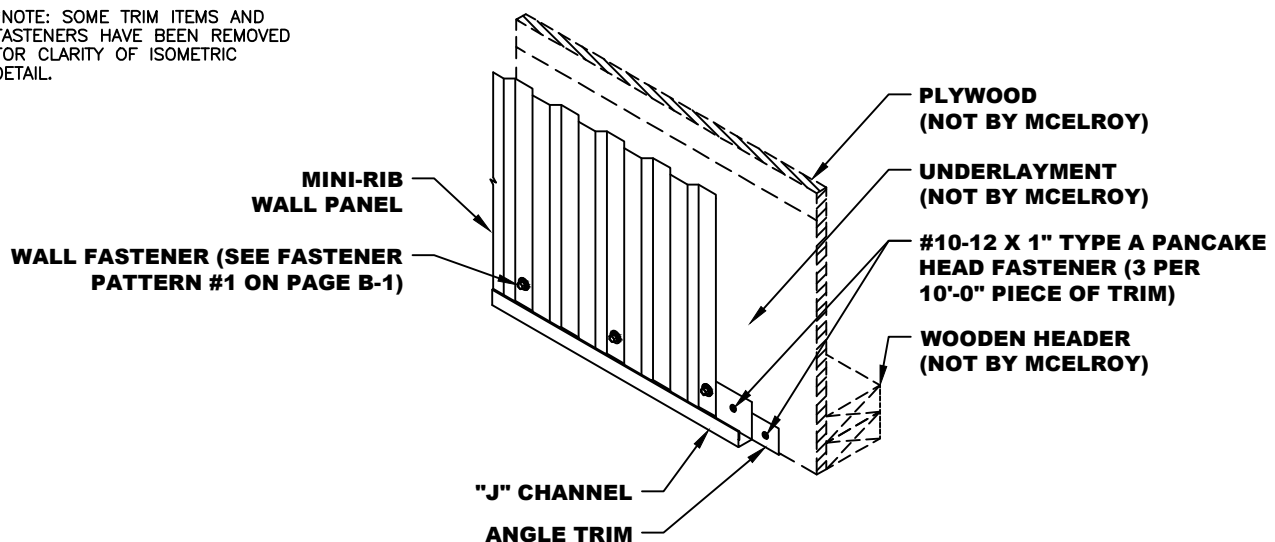

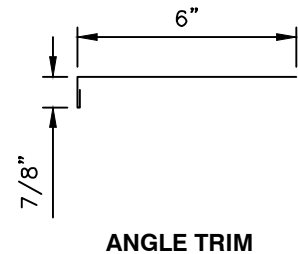
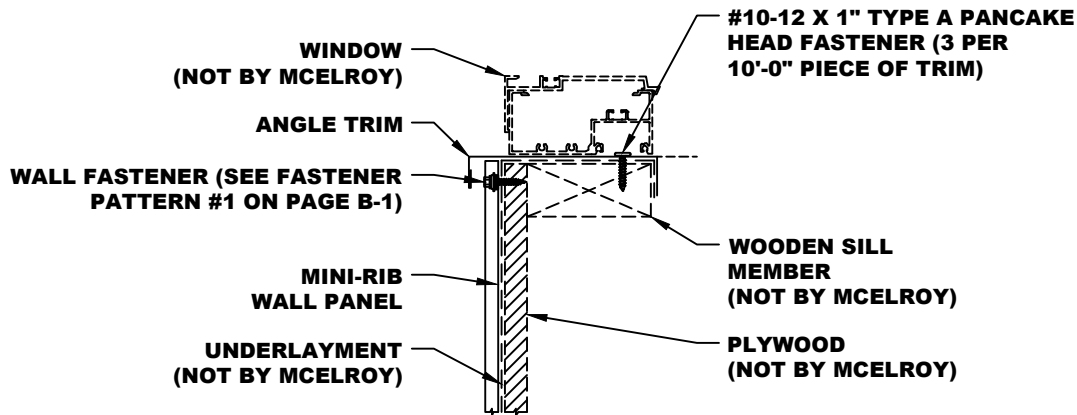

- NOTES:**
1. Measure and cut Mini-Rib Panel to fit around window as required.
  2. Set Mini-Rib Panel in place and attach to Plywood with Wall Fasteners per Fastener Pattern #1 on page B-1.
  3. Cut Angle Trim to fit as required and attach to Structural Wall Member with #10-12 x 1" Type A Pancake Head Fasteners at three (3) per 10'-0" piece of trim.

\*NOTE: SOME TRIM ITEMS AND FASTENERS HAVE BEEN REMOVED FOR CLARITY OF ISOMETRIC DETAIL.

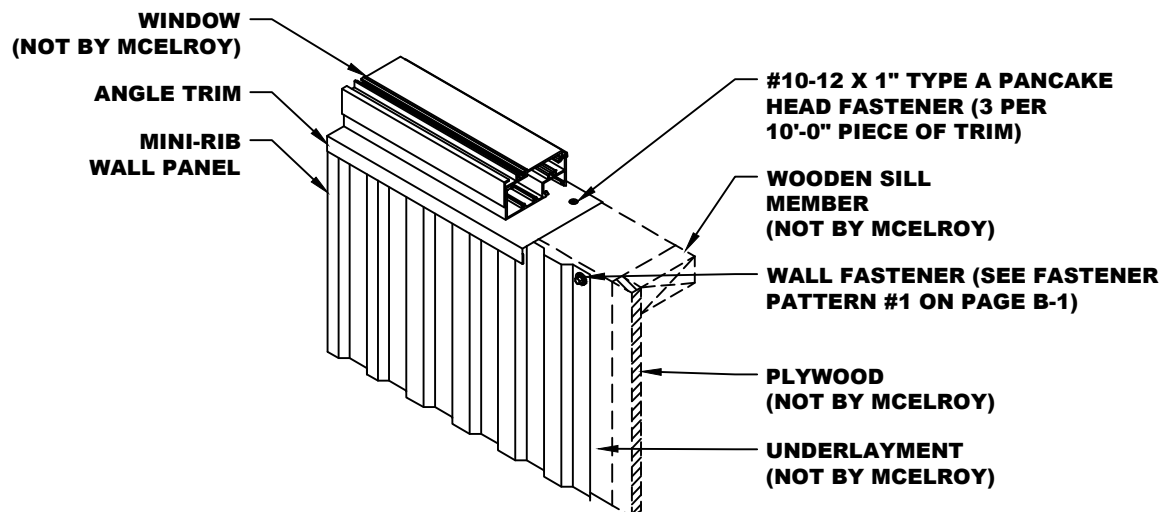

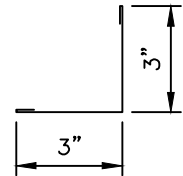
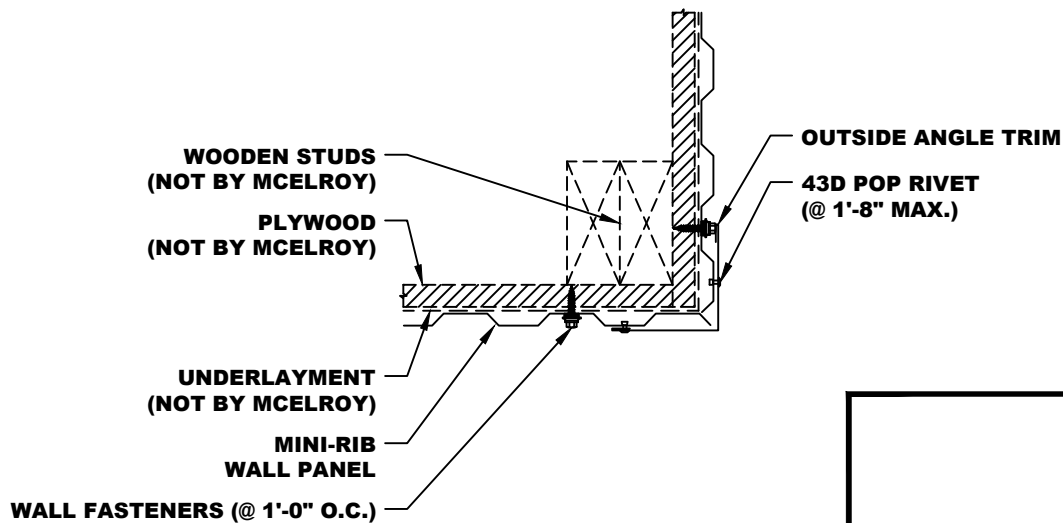

**OUTSIDE ANGLE TRIM**

- NOTES:** 1. Attach Mini-Rib Panels to Plywood with Wall Fasteners at 1'-0" O.C.  
 2. Outside Corner Trim to run from Base Trim to top of wall panel.  
 3. Attach Outside Corner Trim to Mini-Rib Panel with 43D Pop Rivets at 1'-8" O.C. (Max.).

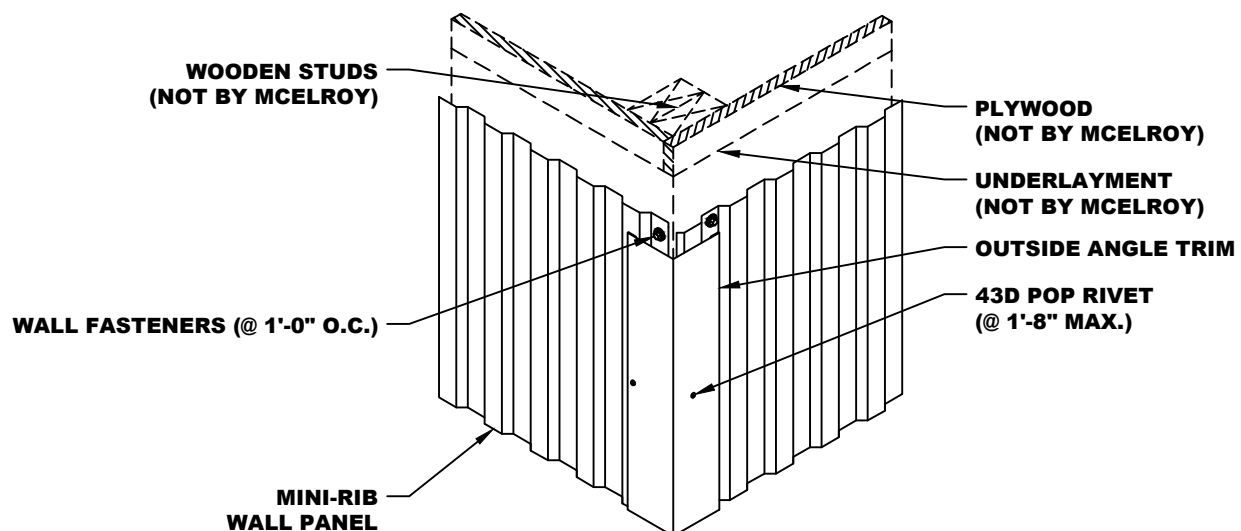

\*NOTE: SOME TRIM ITEMS AND FASTENERS HAVE BEEN REMOVED FOR CLARITY OF ISOMETRIC DETAIL.

# VERTICAL OUTSIDE CORNER DETAIL (OFF MODULE) DETAIL

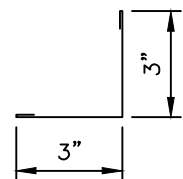
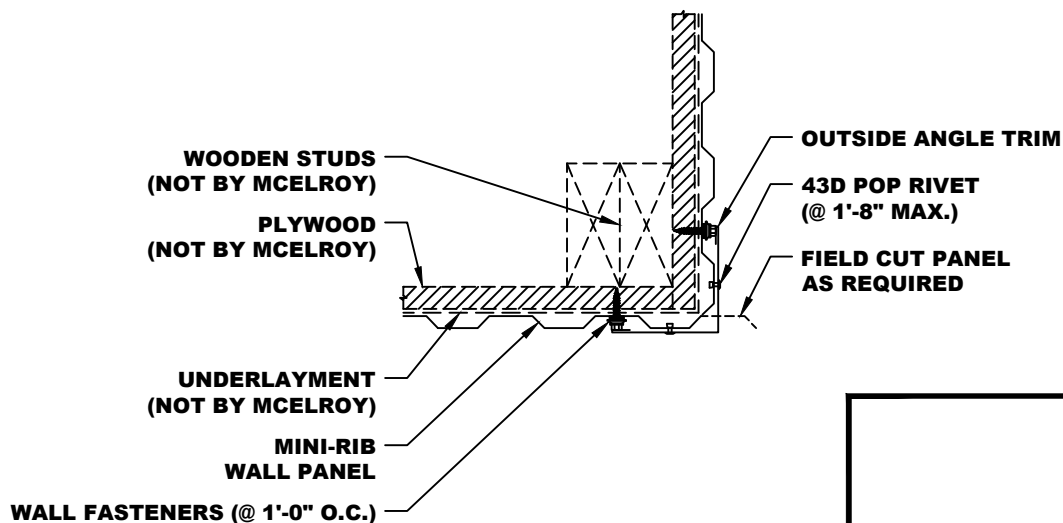

OUTSIDE ANGLE TRIM

- NOTES:** 1. Measure and Field Cut Mini-Rib Panel as required. Attach panels to Plywood with Wall Fasteners at 1'-0" O.C.  
2. Outside Corner Trim to run from Base Trim to top of wall panel.  
3. Attach Outside Corner Trim to Mini-Rib Panel with 43D Pop Rivets at 1'-8" O.C. (Max.).

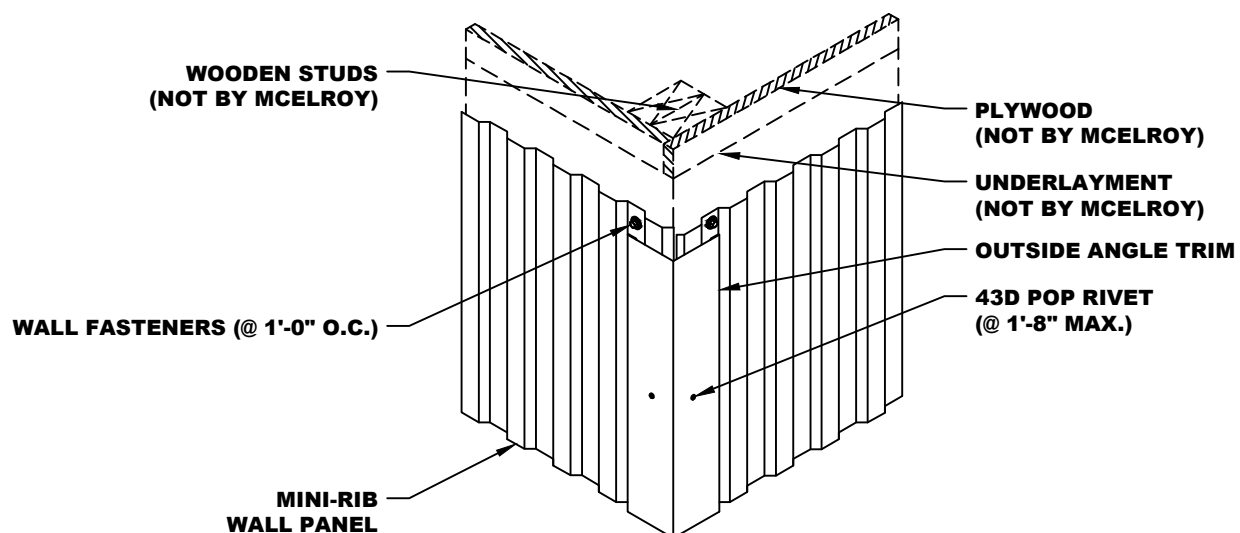

\*NOTE: SOME TRIM ITEMS AND FASTENERS HAVE BEEN REMOVED FOR CLARITY OF ISOMETRIC DETAIL.

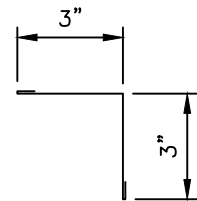
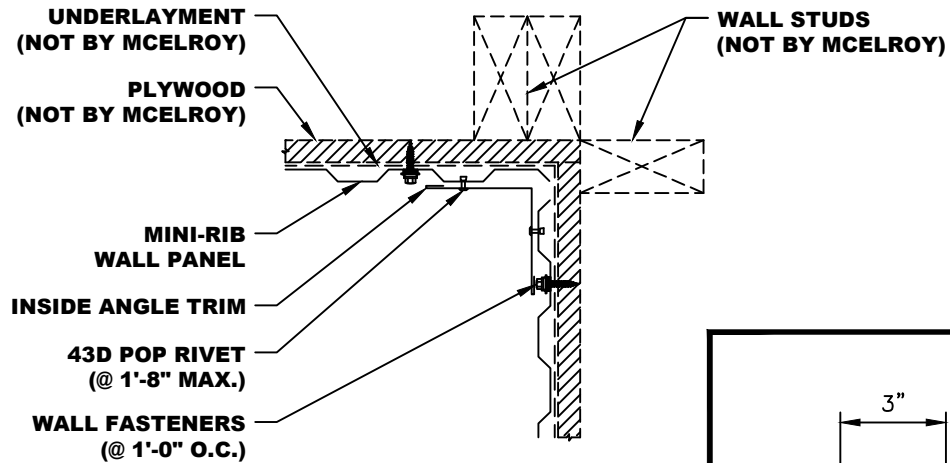

- NOTES:**
1. Attach Mini-Rib Panels to Plywood with Wall Fasteners at 1'-0" O.C.
  2. Inside Corner Trim to run from Base Trim to top of wall panel.
  3. Attach Inside Corner Trim to Mini-Rib Panel with 43D Pop Rivets at 1'-8" O.C. (Max.).

\*NOTE: SOME TRIM ITEMS AND FASTENERS HAVE BEEN REMOVED FOR CLARITY OF ISOMETRIC DETAIL.

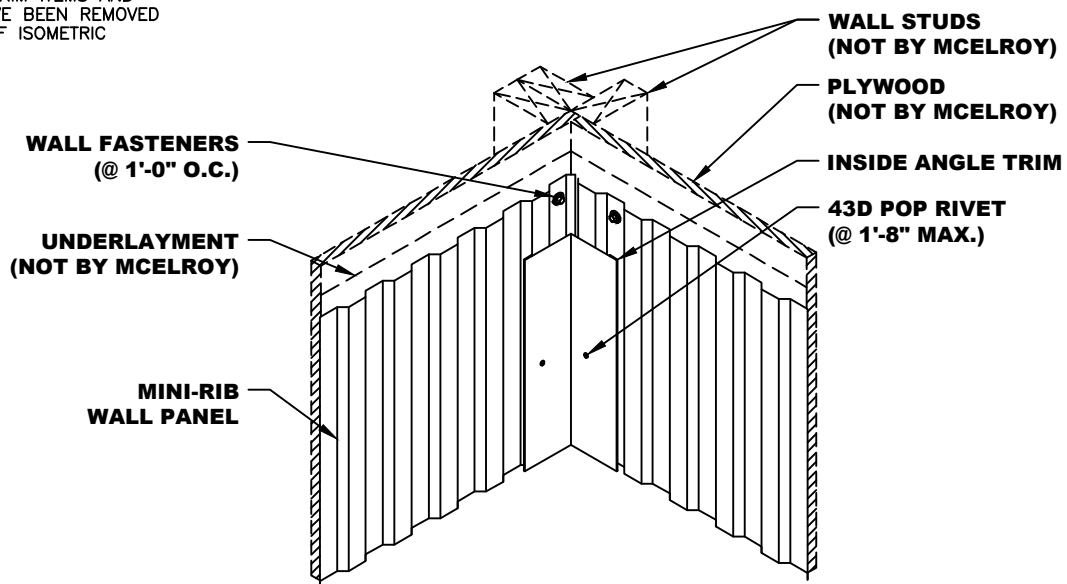

# VERTICAL INSIDE CORNER (OFF MODULE) DETAIL

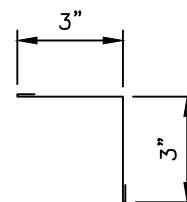
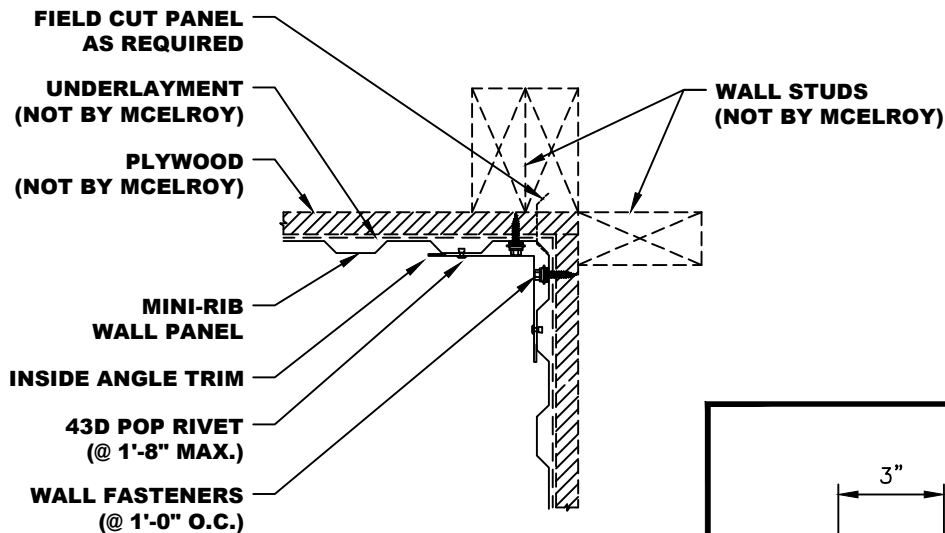

INSIDE ANGLE TRIM

- NOTES:** 1. Measure and Field Cut Mini-Rib Panel as require. Attach panels to Plywood with Wall Fasteners at 1'-0" O.C.  
 2. Inside Corner Trim to run from Base Trim to top of wall panel.  
 3. Attach Inside Corner Trim to Mini-Rib Panel with 43D Pop Rivets at 1'-8" O.C. (Max.).

\*NOTE: SOME TRIM ITEMS AND FASTENERS HAVE BEEN REMOVED FOR CLARITY OF ISOMETRIC DETAIL.

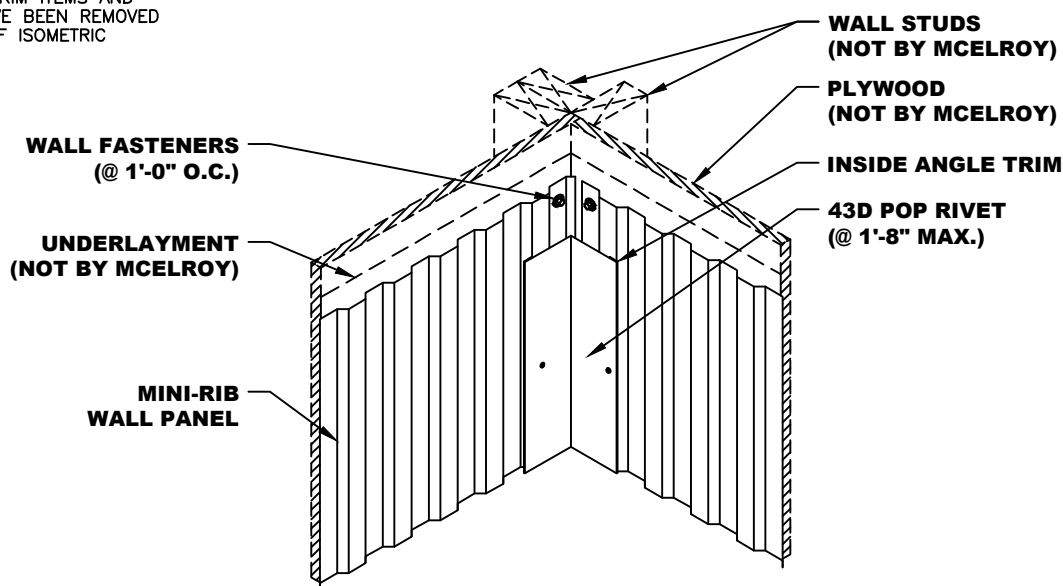

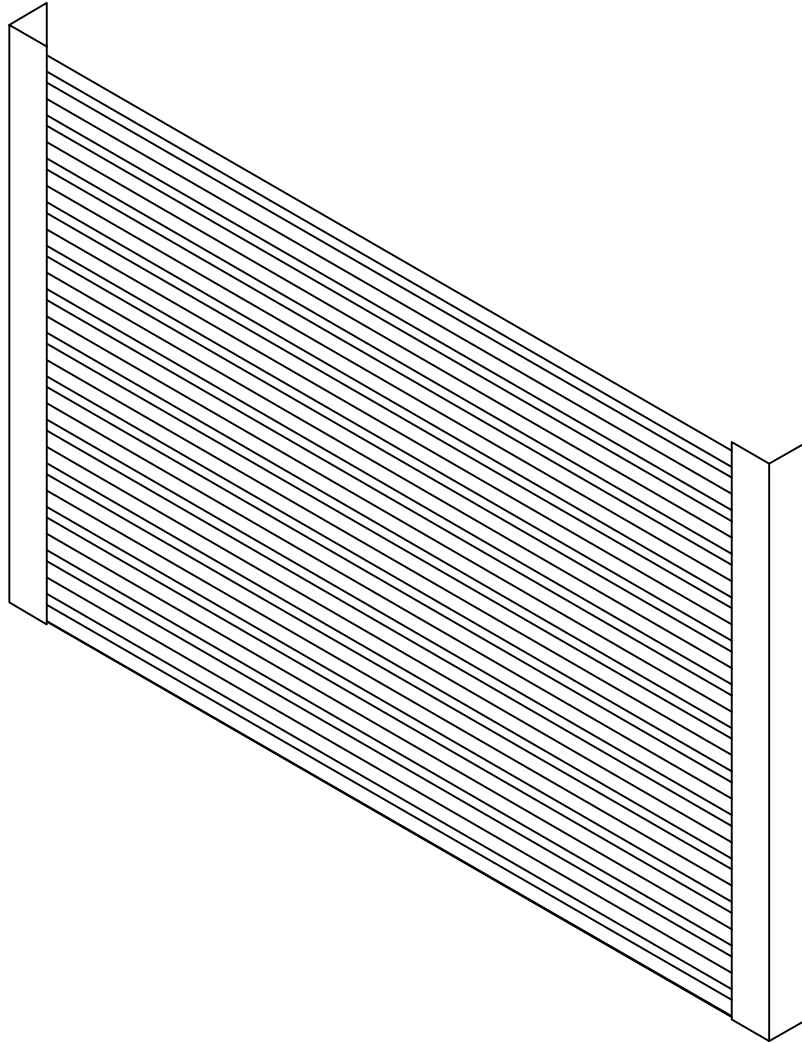

**STANDARD HORIZONTAL INSTALLATION DETAILS**



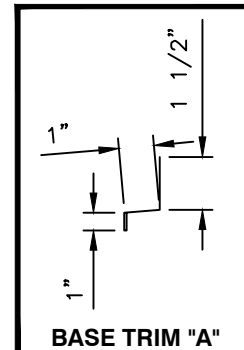
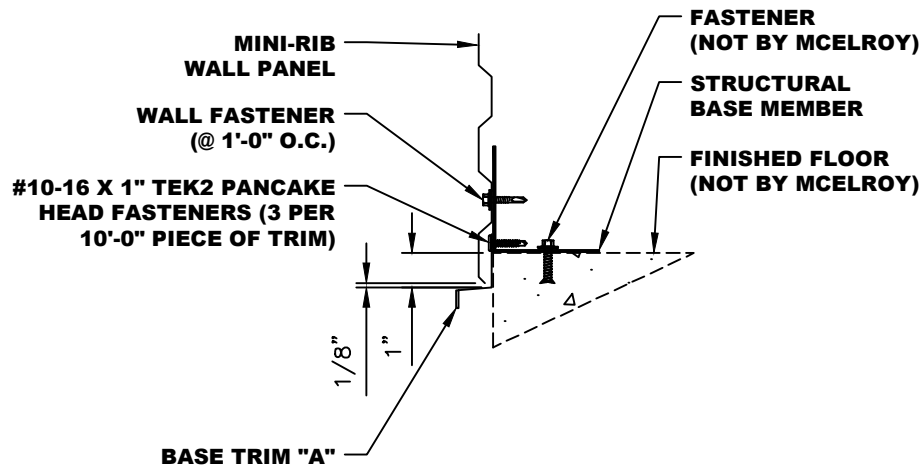

- NOTES:**
1. Base Structural Member set flush with edge of finished floor.
  2. Set Base Trim "A" 1" down face of finished floor and attach to Structural Base Member with #10-16 x 1" Tek2 Pancake Head Fasteners. Use three (3) fasteners per 10'-0" piece of trim.
  3. Set Mini-Rib Wall Panel into place. Make sure to leave a 1/8" gap between base trim and panel.
  4. Attach Mini-Rib Panel with Wall Fasteners at 1'-0" O.C.

\*NOTE: SOME TRIM ITEMS AND FASTENERS HAVE BEEN REMOVED FOR CLARITY OF ISOMETRIC DETAIL.

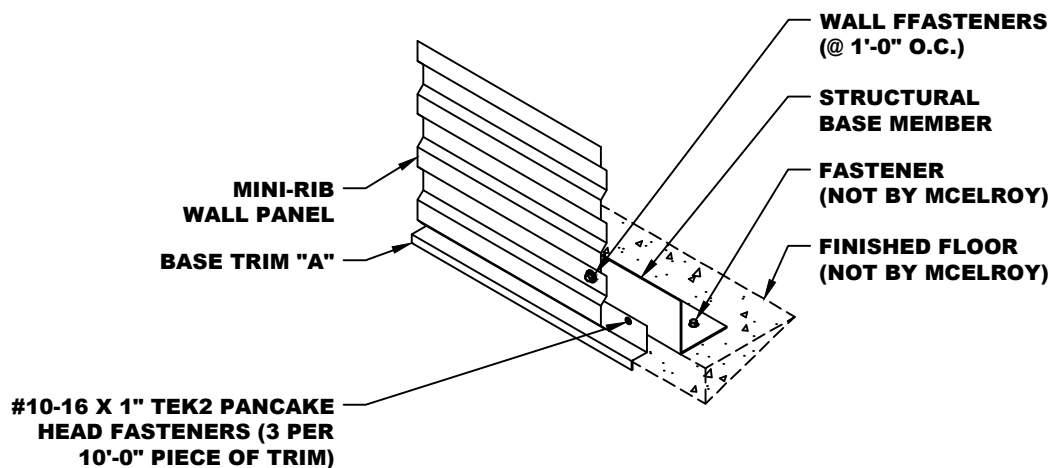

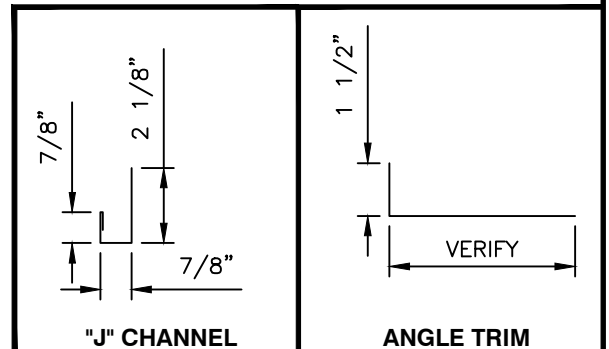
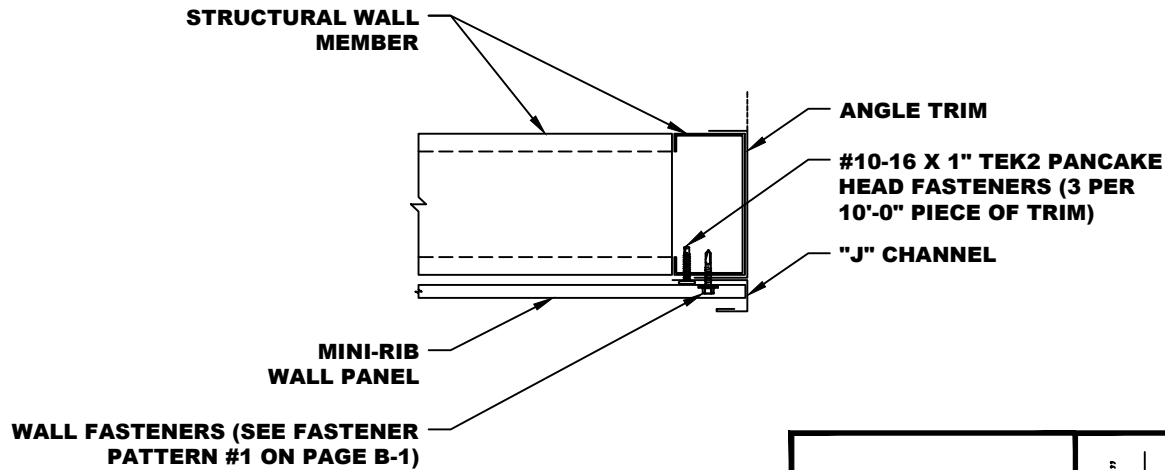

- NOTES:**
1. Attach Angle Trim to Structural Wall Member. If you ordered trim wider than Structural Member, fold back as shown in detail. You can hold in place with temporary fasteners if needed.
  2. Set "J" Channel in place as shown and attach to Structural Wall Member with #10-16 x 1" Tek2 Pancake Head Fasteners. Use three (3) fasteners per 10'-0" piece of trim.
  3. Set Mini-Rib Wall Panel in place and fasten to Structural Wall Members with Wall Fasteners per Fastener Pattern #1 on page B-1 of this manual.

\*NOTE: SOME TRIM ITEMS AND FASTENERS HAVE BEEN REMOVED FOR CLARITY OF ISOMETRIC DETAIL.

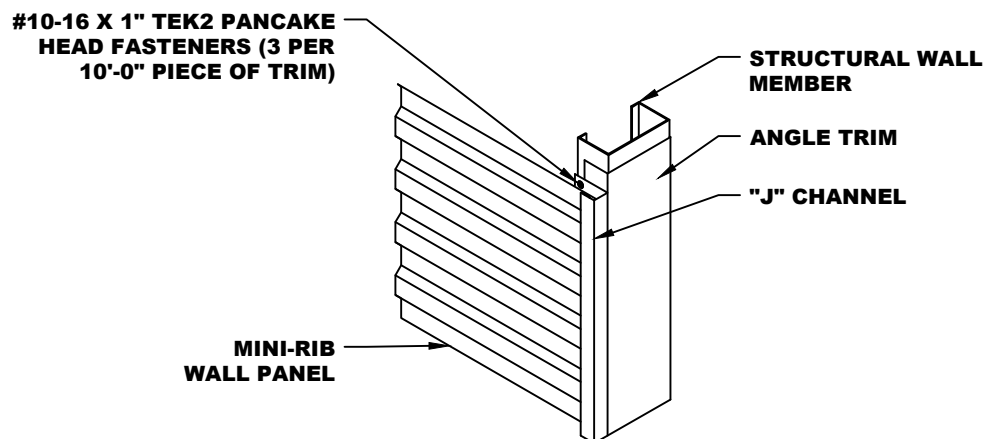

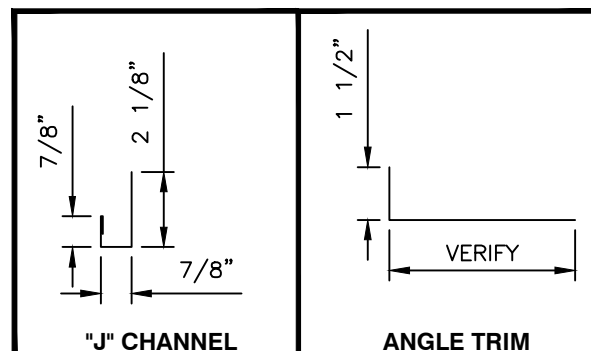
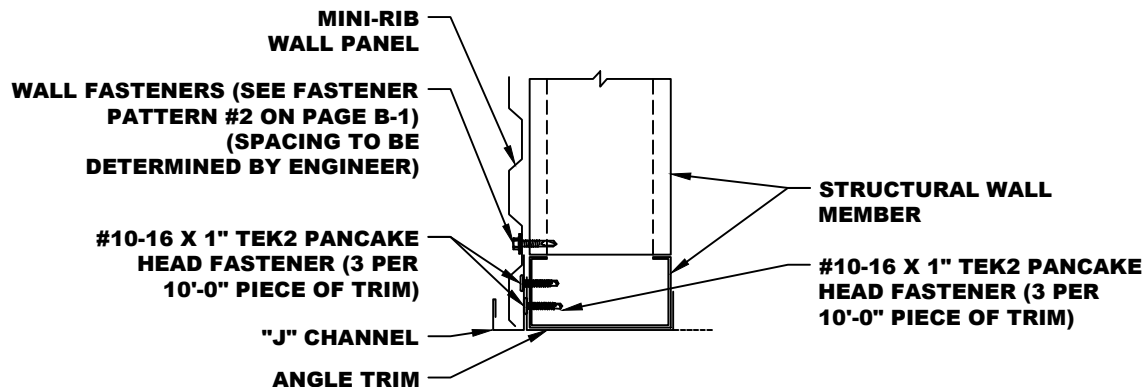

- NOTES:**
1. Attach Angle Trim to Structural Wall Member. If you ordered trim wider than Structural Member, fold back as shown in detail. Attach with #10-16 x 1" Tek2 Pancake Head Fasteners three (3) per 10'-0" piece of trim.
  2. Set "J" Channel in place as shown and attach to Structural Wall Member with #10-16 x 1" Tek2 Pancake Head Fasteners three (3) fasteners per 10'-0" piece of trim.
  3. Attach Mini-Rib Panel with Wall Fasteners per Fastener Pattern #2 on page B-1 of this manual. Spacing of fasteners to be determined by an Engineer.

\*NOTE: SOME TRIM ITEMS AND FASTENERS HAVE BEEN REMOVED FOR CLARITY OF ISOMETRIC DETAIL.

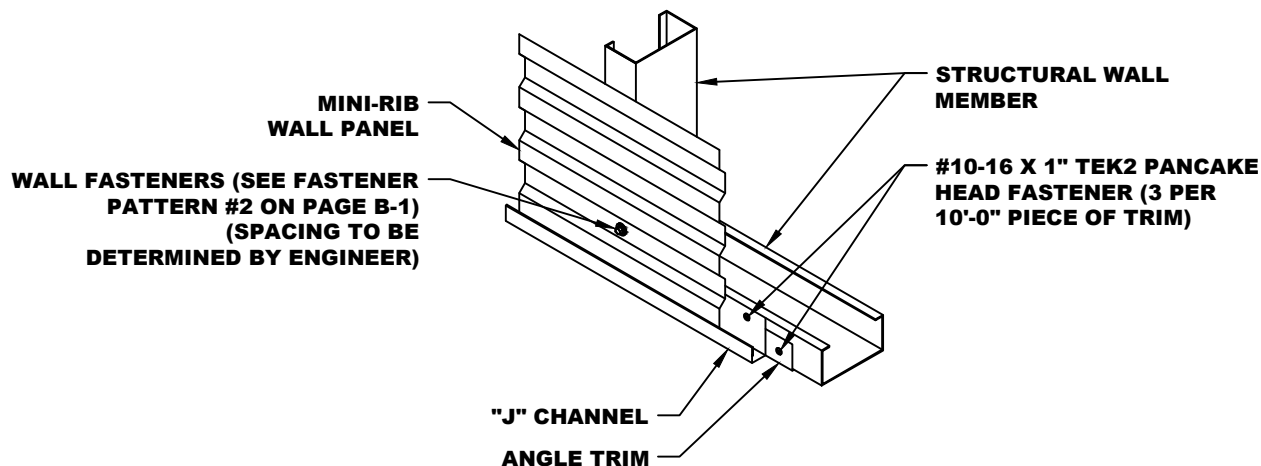

# MINI-RIB HORIZONTAL HEAD (OFF MODULE) DETAIL

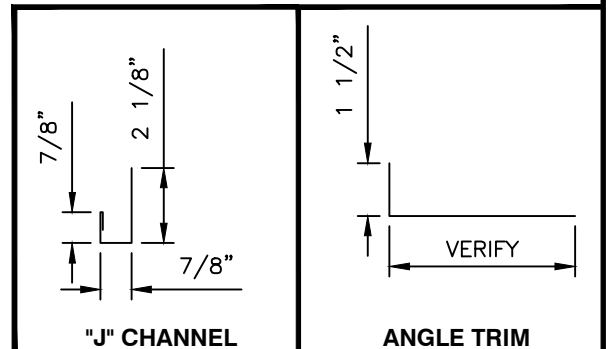
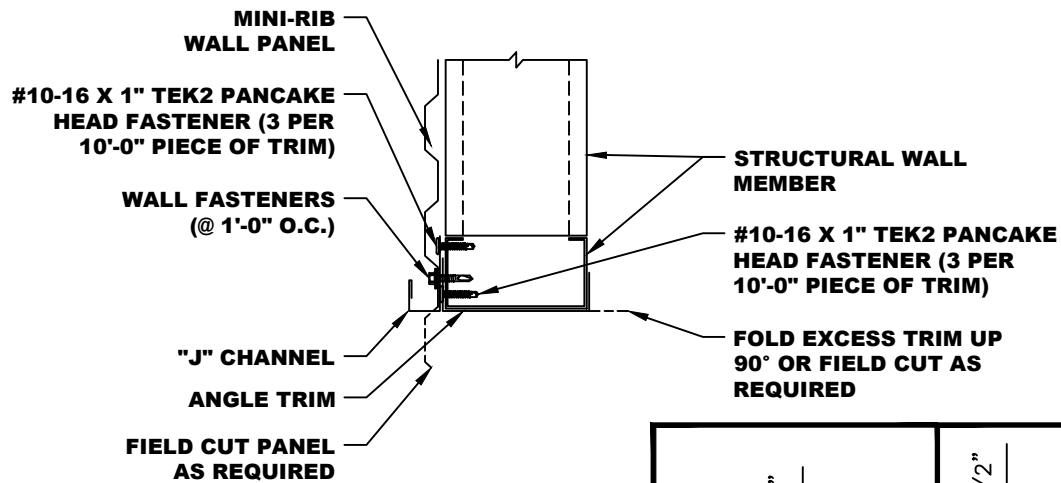

- NOTES:**
1. Attach Angle Trim to Structural Wall Member. If you ordered trim wider than Structural Member, fold back as shown in detail. Attach with #10-16 x 1" Tek2 Pancake Head Fasteners three (3) per 10'-0" piece of trim.
  2. Set "J" Channel in place as shown and attach to Structural Wall Member with #10-16 x 1" Tek2 Pancake Head Fasteners three (3) fasteners per 10'-0" piece of trim.
  3. Field Cut Mini-Rib Panel as required and attach panel with Wall Fasteners at 1'-0" O.C.

\*NOTE: SOME TRIM ITEMS AND FASTENERS HAVE BEEN REMOVED FOR CLARITY OF ISOMETRIC DETAIL.

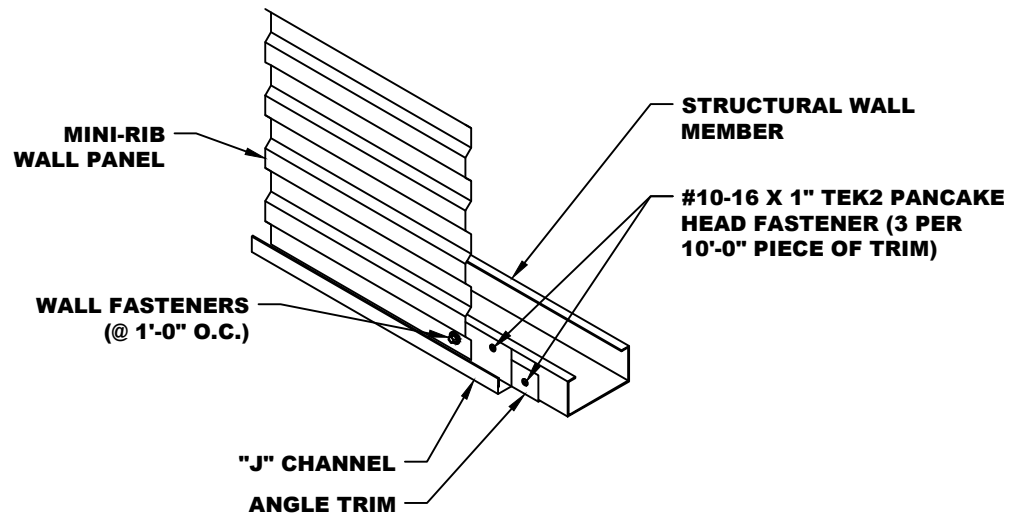

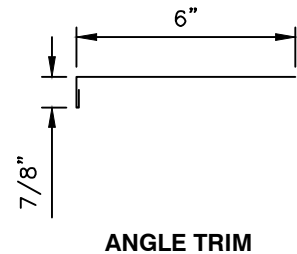
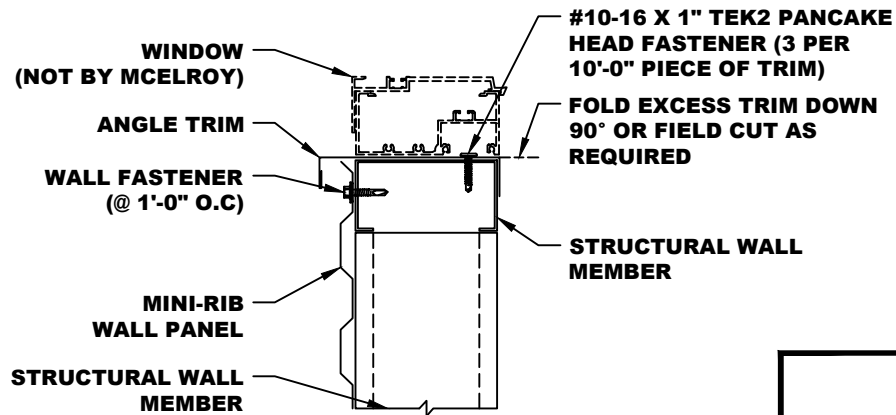

- NOTES:**
1. Measure and cut Mini-Rib Panel to fit around window as required.
  2. Set Mini-Rib Panel in place and attach to Structural Wall Member with Wall Fasteners at 1'-0" O.C.
  3. Cut Angle Trim to fit as required and attach to Structural Wall Member with #10-16 x 1" Tek2 Pancake Fasteners at three (3) per 10'-0" piece of trim.

\*NOTE: SOME TRIM ITEMS AND FASTENERS HAVE BEEN REMOVED FOR CLARITY OF ISOMETRIC DETAIL.

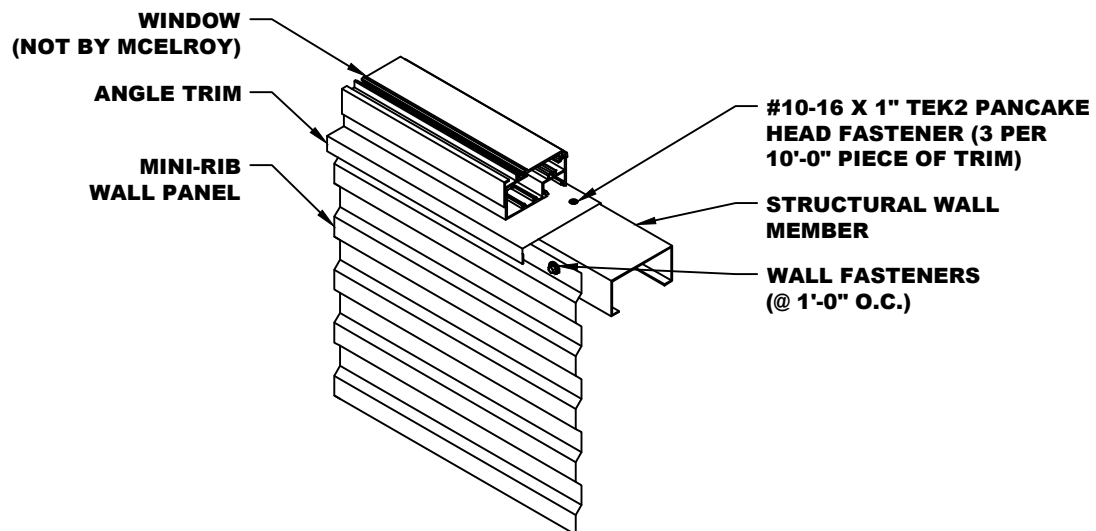

# **MINI-RIB HORIZONTAL SILL (OFF MODULE) DETAIL**

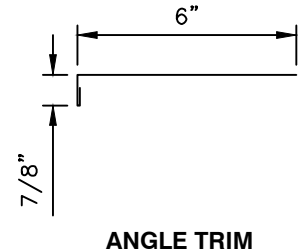
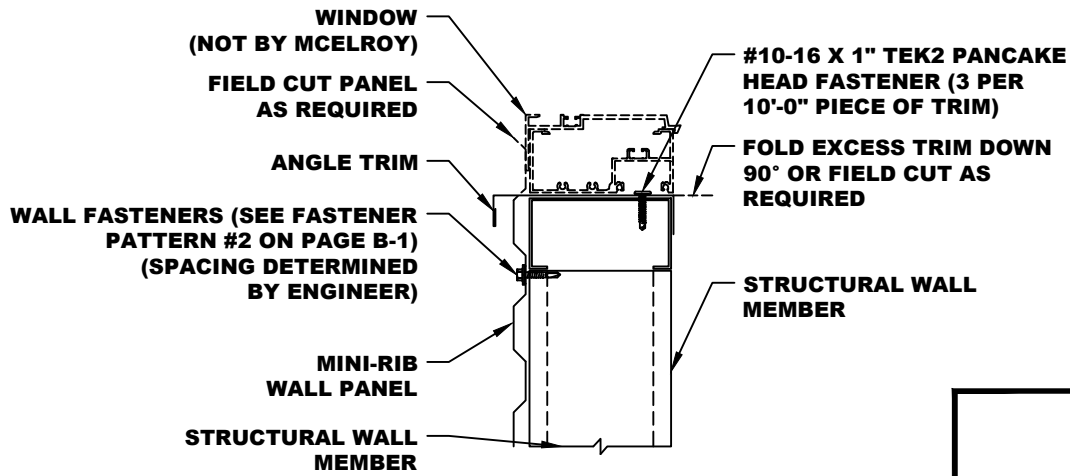

- NOTES:**
1. Measure and cut Mini-Rib Panel to fit around window as required.
  2. Set Mini-Rib Panel in place and attach to Structural Wall Member with Wall Fasteners. Spacing to be determined by an engineer.
  3. Cut Angle Trim to fit as required and attach to Structural Wall Member with #10-16 x 1" Tek2 Pancake Fasteners at three (3) per 10'-0" piece of trim.

\*NOTE: SOME TRIM ITEMS AND  
FASTENERS HAVE BEEN REMOVED  
FOR CLARITY OF ISOMETRIC  
DETAIL.

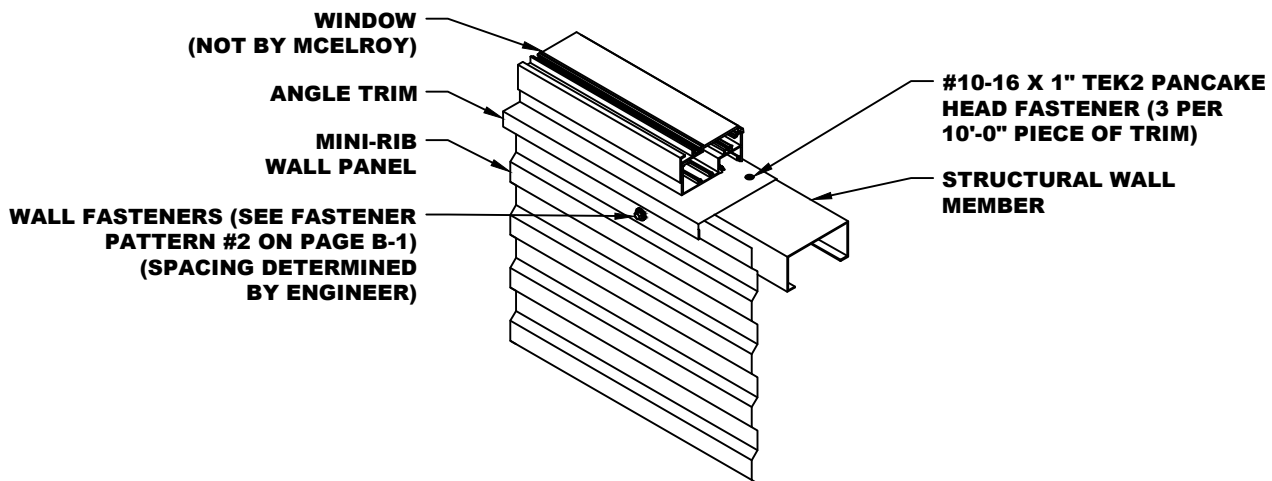

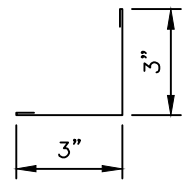
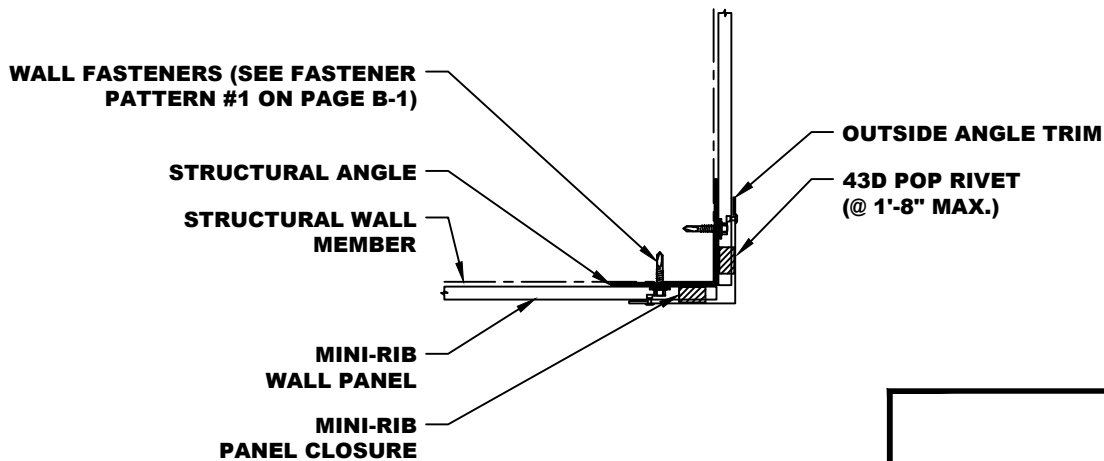

OUTSIDE ANGLE TRIM

- NOTES:**
1. Attach Mini-Rib Panels to framework with Wall Fasteners per Fastener Pattern #1 on page B-1.
  2. Install Mini-Rib Panel Closures.
  3. Outside Corner Trim to run from Base Trim to top of wall panel.
  4. Attach Outside Corner Trim to Mini-Rib Panel with 43D Pop Rivets at 1'-8" O.C. (Max.).

\*NOTE: SOME TRIM ITEMS AND FASTENERS HAVE BEEN REMOVED FOR CLARITY OF ISOMETRIC DETAIL.

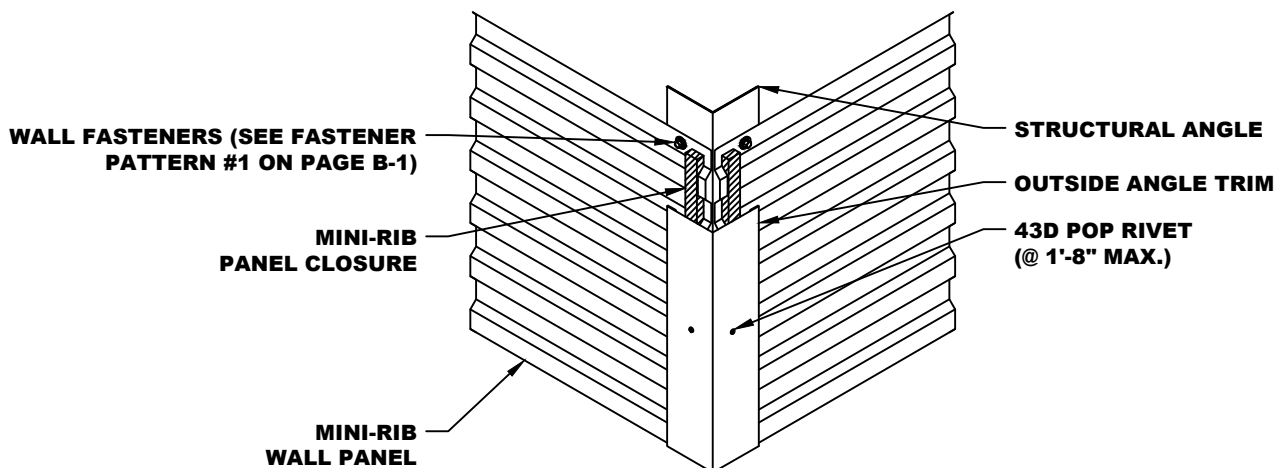

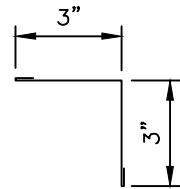
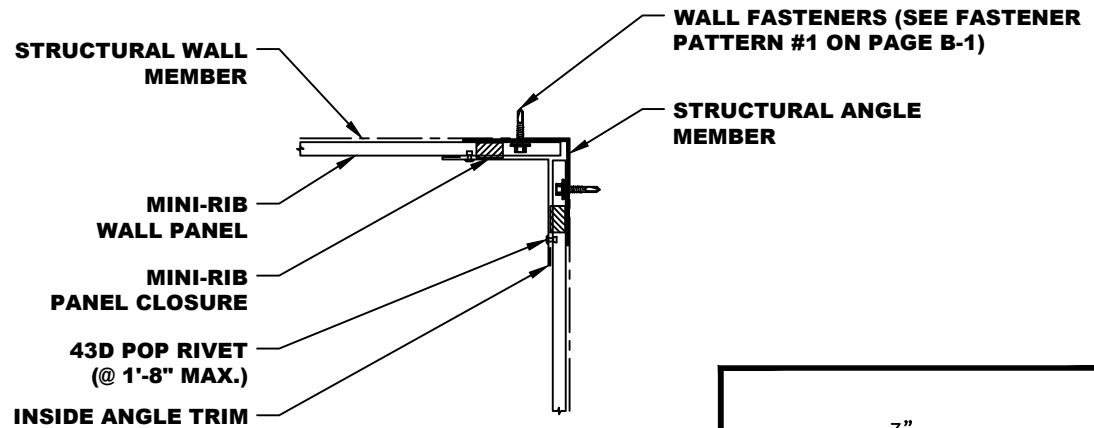

INSIDE ANGLE TRIM

- NOTES:**
1. Attach Mini-Rib Panels to framework with Wall Fasteners per Fastener Pattern #1 on page B-1.
  2. Install Mini-Rib Panel Closures.
  3. Inside Corner Trim to run from Base Trim to top of wall panel.
  4. Attach Inside Corner Trim to Mini-Rib Panel with 43D Pop Rivets at 1'-8" O.C. (Max.).

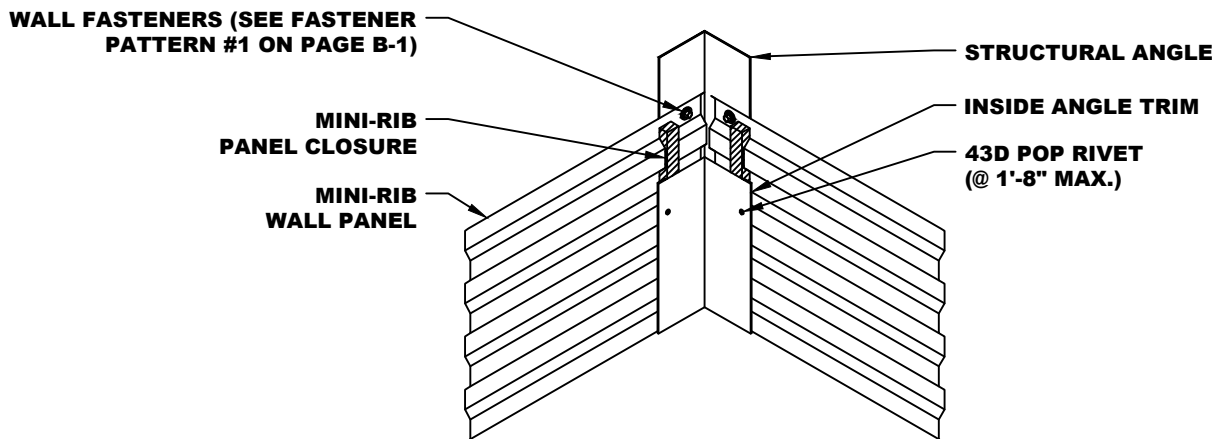

\*NOTE: SOME TRIM ITEMS AND FASTENERS HAVE BEEN REMOVED FOR CLARITY OF ISOMETRIC DETAIL.



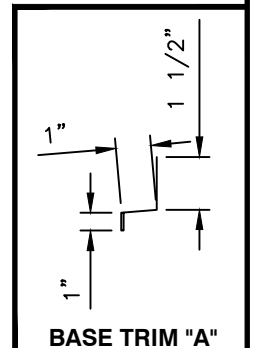
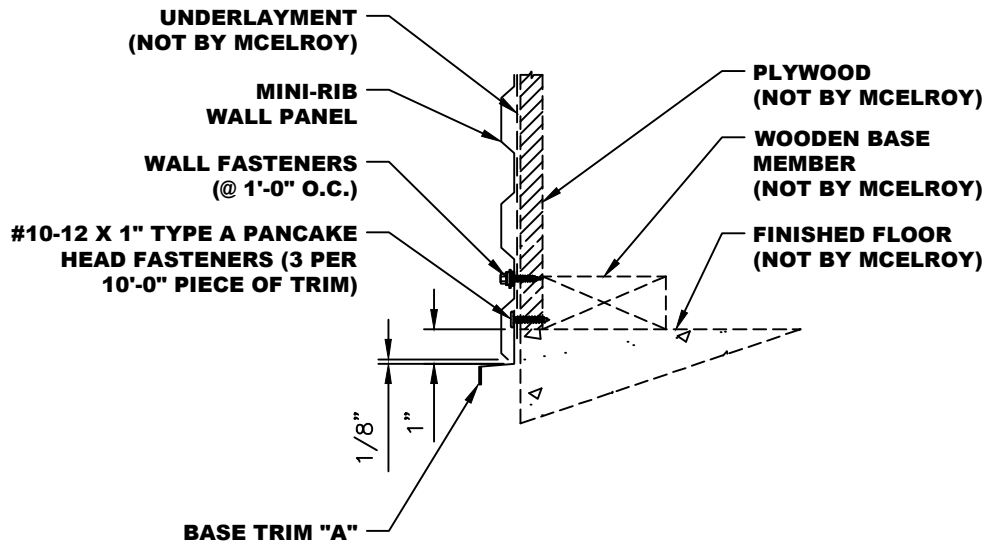

- NOTES:**
1. Plywood set flush with edge of finished floor.
  2. Set Base Trim "A" 1" down face of finished floor and attach to Plywood with #10-12 x 1" Type A Pancake Head Fasteners. Use three (3) fasteners per 10'-0" piece of trim.
  3. Set Mini-Rib Wall Panel into place. Make sure to leave a 1/8" gap between base trim and panel.
  4. Attach Mini-Rib Panel with Wall Fasteners at 1'-0" O.C.

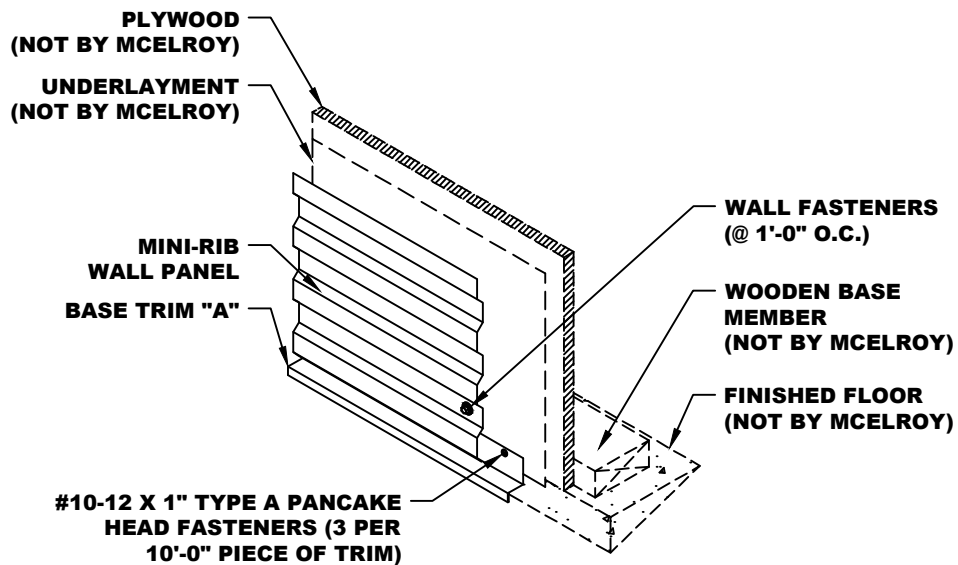

\*NOTE: SOME TRIM ITEMS AND FASTENERS HAVE BEEN REMOVED FOR CLARITY OF ISOMETRIC DETAIL.

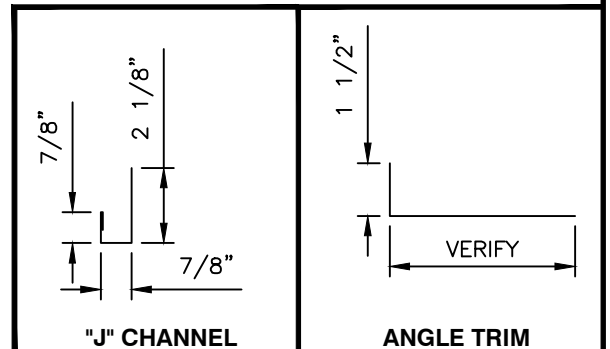
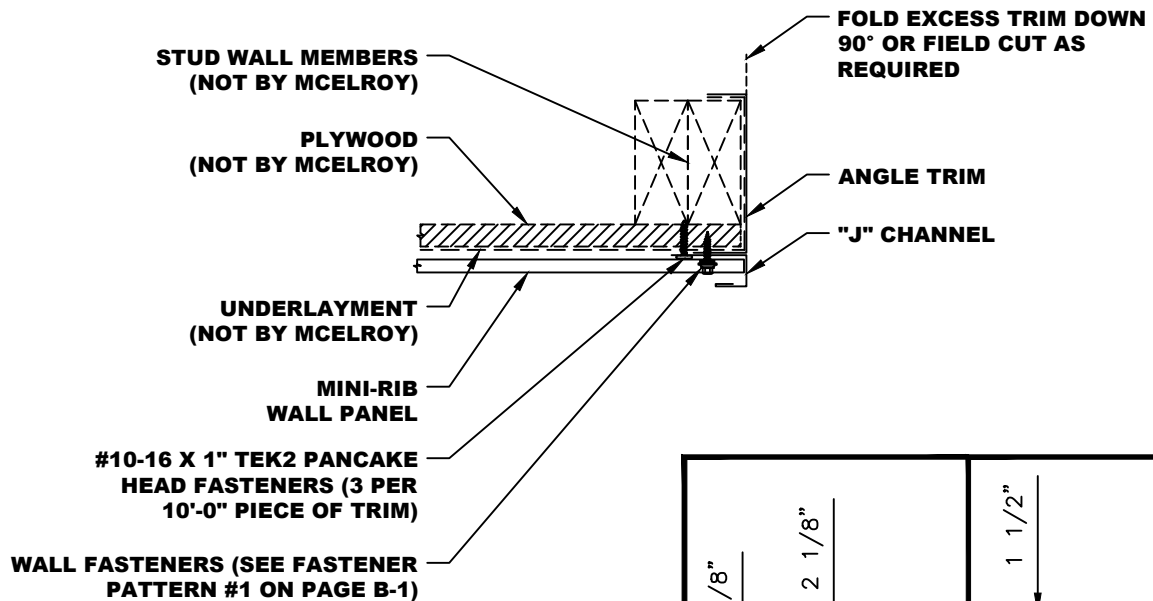

- NOTES:**
1. Attach Angle Trim to Structural Wall Member. If you ordered trim wider than Structural Member, fold back as shown in detail. You can hold in place with temporary fasteners if needed.
  2. Set "J" Channel in place as shown and attach to Structural Wall Member with #10-12 x 1" Type A Pancake Head Fasteners. Use three (3) fasteners per 10'-0" piece of trim.
  3. Set Mini-Rib Wall Panel in place and fasten to Plywood with Wall Fasteners per Fastener Pattern #1 on page B-1 on this manual.

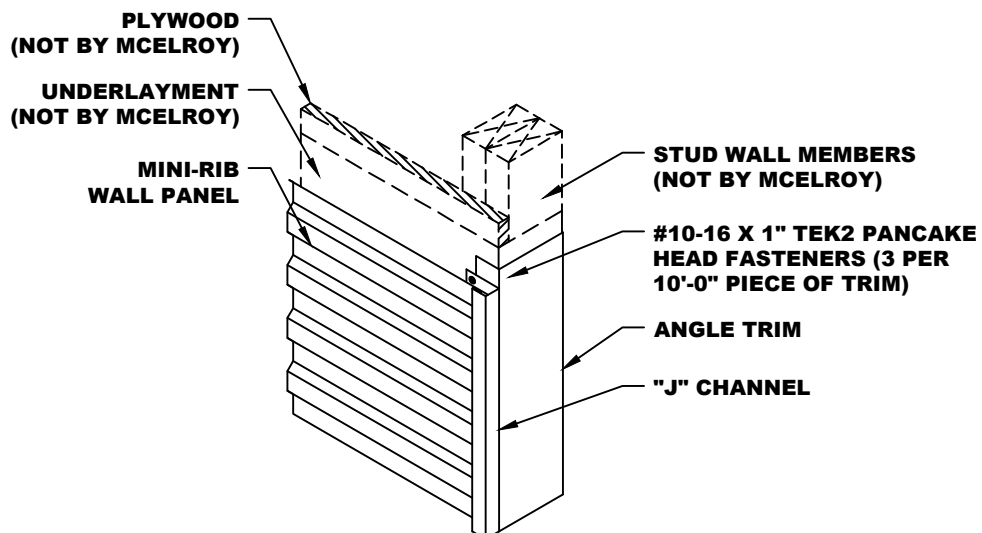

\*NOTE: SOME TRIM ITEMS AND FASTENERS HAVE BEEN REMOVED FOR CLARITY OF ISOMETRIC DETAIL.

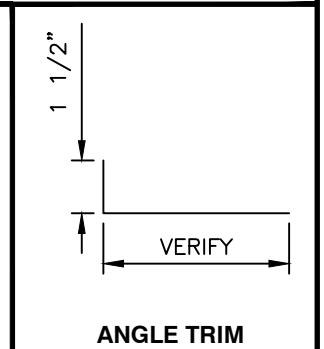
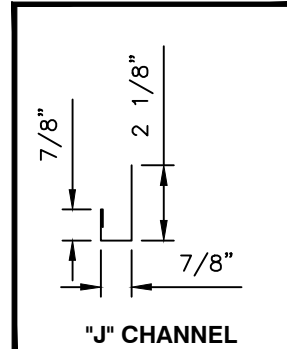
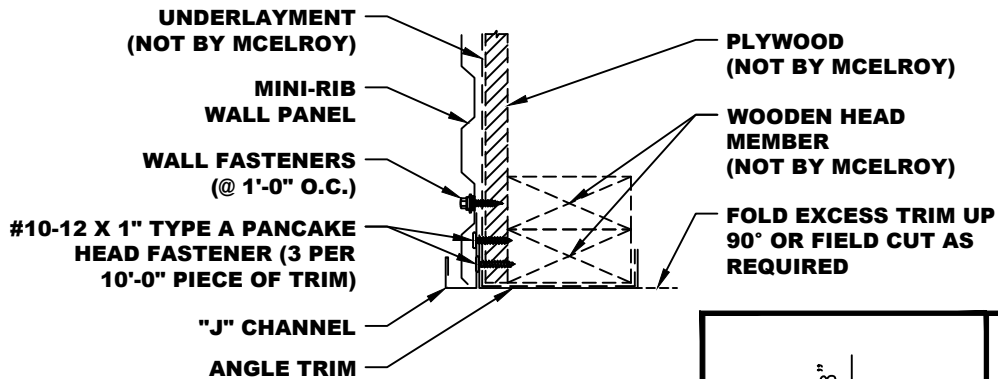

- NOTES:**
1. Attach Angle Trim to Plywood. If you ordered trim wider than Wooden Stud Member, fold back as shown in detail. Attach with #10-12 x 1" Type A Pancake Head Fasteners three (3) per 10'-0" per piece of trim.
  2. Set "J" Channel in place as shown and attach to Structural Wall Member with #10-12 x 1" Type A Pancake Head Fasteners three (3) fasteners per 10'-0" piece of trim.
  3. Set Mini-Rib Wall Panel in place and fasten to Plywood with Wall Fasteners at 1'-0" O.C.

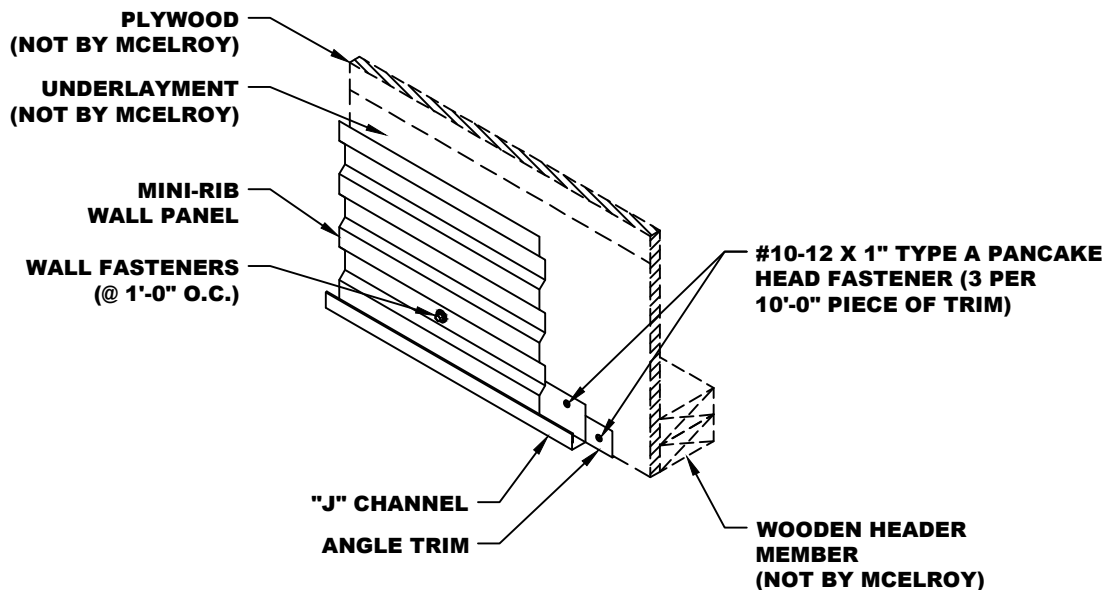

\*NOTE: SOME TRIM ITEMS AND FASTENERS HAVE BEEN REMOVED FOR CLARITY OF ISOMETRIC DETAIL.

# MINI-RIB HORIZONTAL HEAD (OFF MODULE) DETAIL

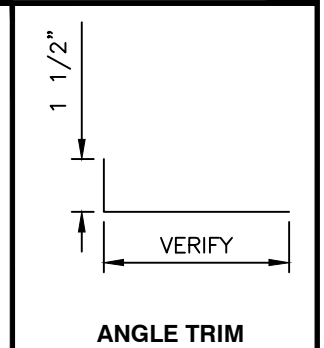
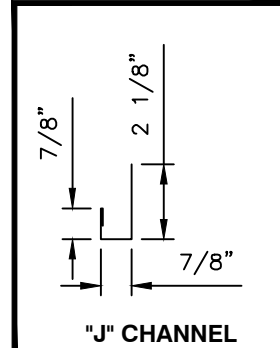
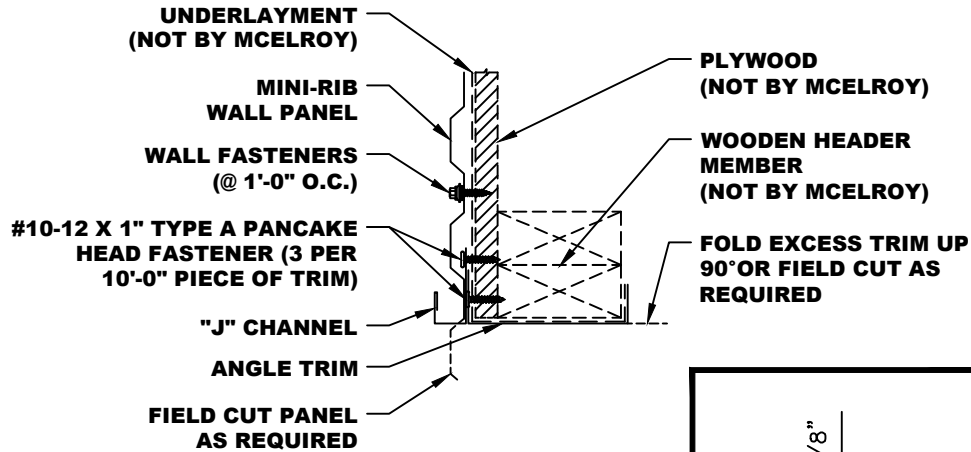

- NOTES:**
1. Attach Angle Trim to Plywood. If you ordered trim wider than Structural Member, fold back as shown in detail. Attach with #10-12 x 1" Type A Pancake Head Fasteners three (3) per 10'-0" piece of trim.
  2. Set "J" Channel in place and attach to Plywood with #10-12 x 1" Type A Pancake Head Fasteners three (3) fasteners per 10'-0" piece of trim.
  3. Set Mini-Rib Panel in place and attach with Wall Fasteners at 1'-0" O.C.

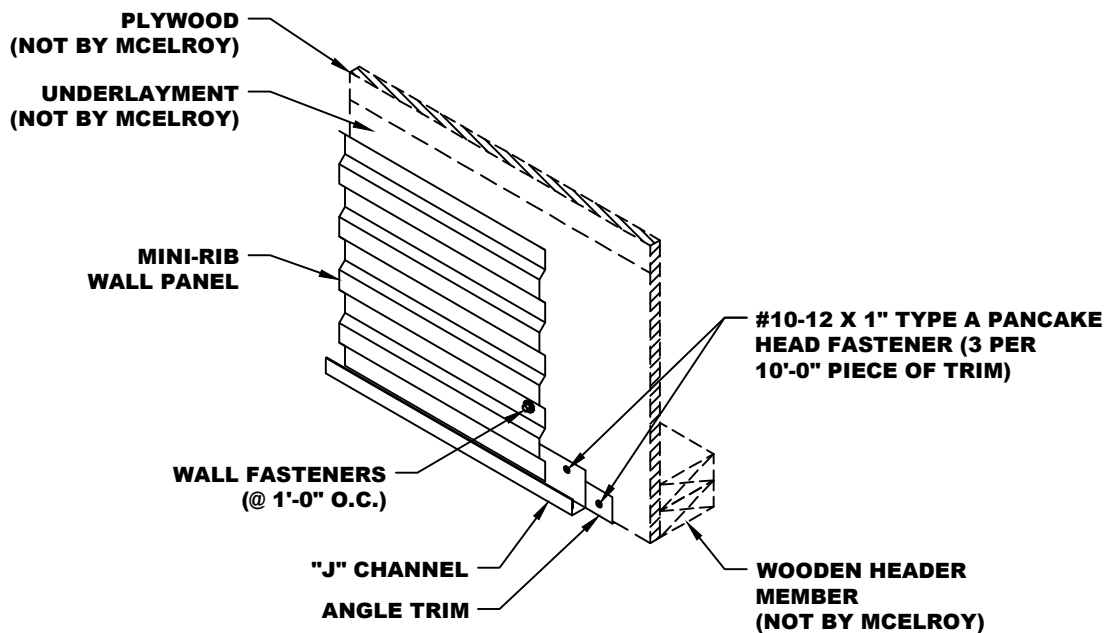

\*NOTE: SOME TRIM ITEMS AND FASTENERS HAVE BEEN REMOVED FOR CLARITY OF ISOMETRIC DETAIL.

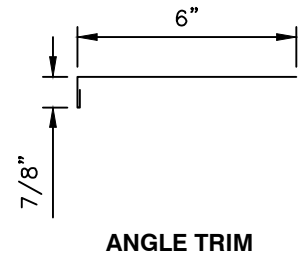
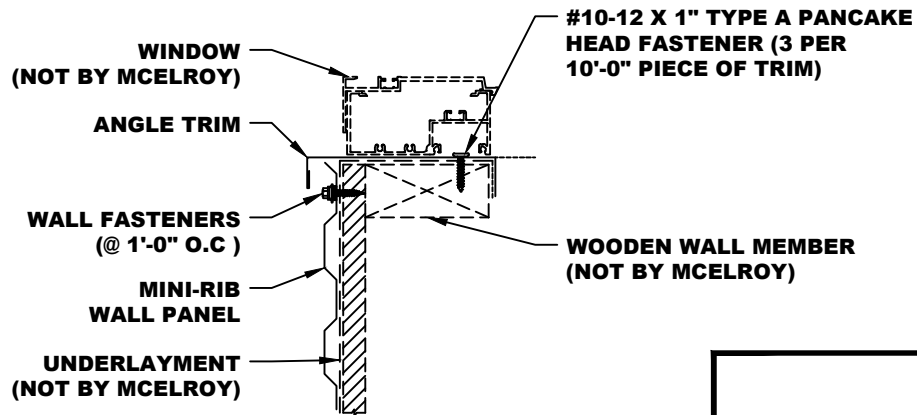

- NOTES:**
1. Measure and cut Mini-Rib Panel to fit around window as required.
  2. Set Mini-Rib Panel in place and attach to Plywood with Wall Fasteners at 1'-0" O.C.
  3. Cut Angle Trim to fit as required and attach to Structural Wall Member with #10-12 x 1" Type A Pancake Head Fasteners at three (3) per 10'-0" piece of trim.

\*NOTE: SOME TRIM ITEMS AND FASTENERS HAVE BEEN REMOVED FOR CLARITY OF ISOMETRIC DETAIL.

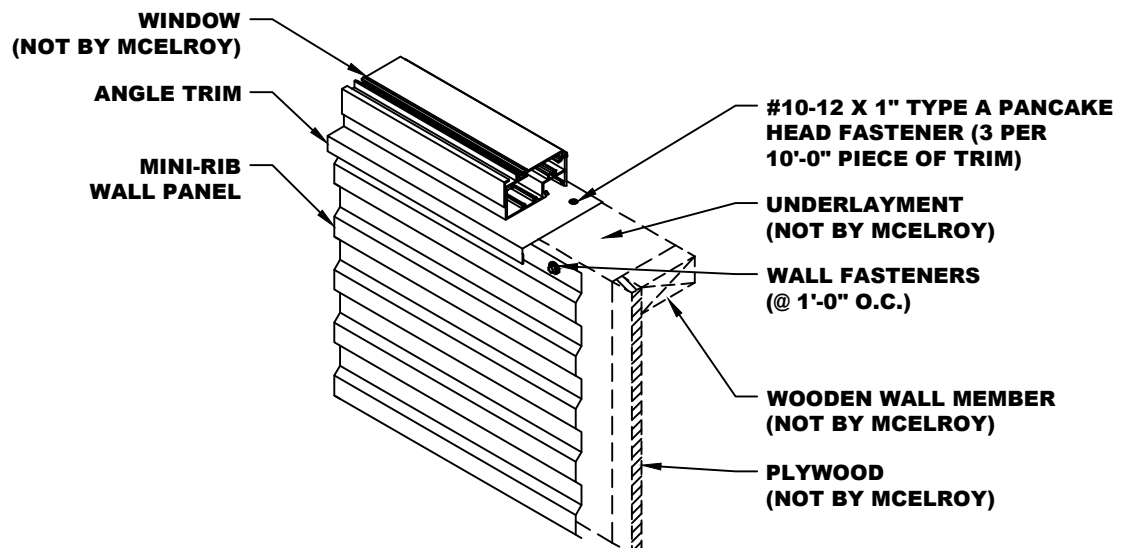

# **MINI-RIB HORIZONTAL SILL (OFF MODULE) DETAIL**

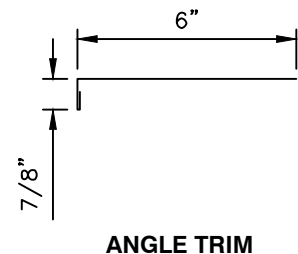
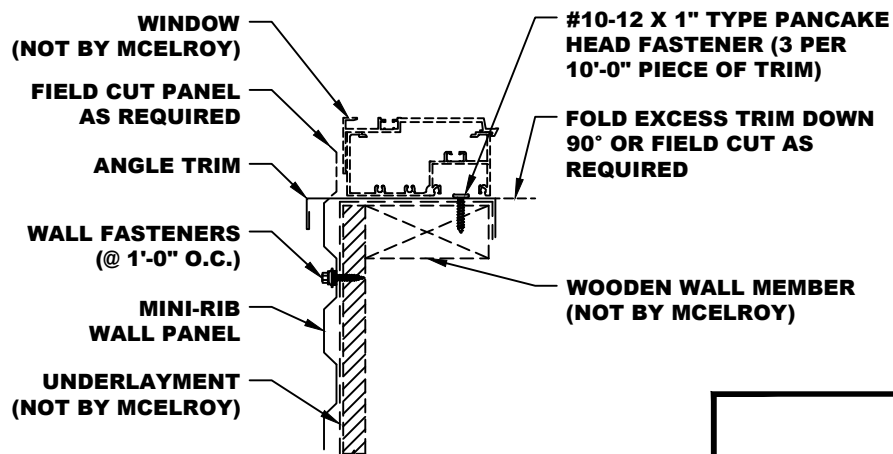

- NOTES:**
1. Measure and cut Mini-Rib Panel to fit around window as required.
  2. Set Mini-Rib Panel in place and attach to Plywood with Wall Fasteners at 1'-0" O.C.
  3. Cut Angle Trim to fit as required and attach to Structural Wall Member with #10-12 x 1" Type A Pancake Head Fasteners at three (3) per 10'-0" piece of trim.

\*NOTE: SOME TRIM ITEMS AND FASTENERS HAVE BEEN REMOVED FOR CLARITY OF ISOMETRIC DETAIL.

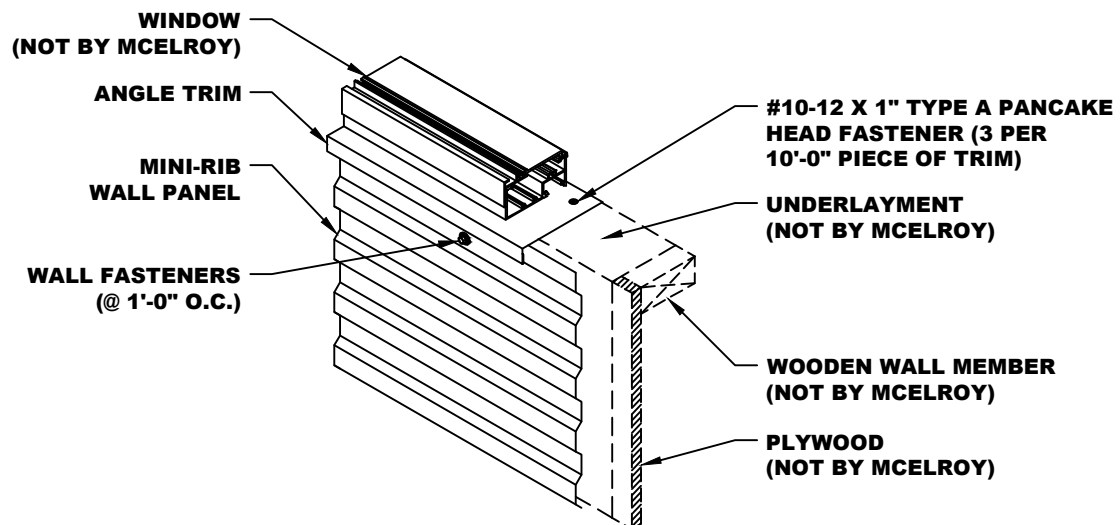

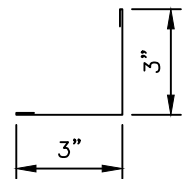
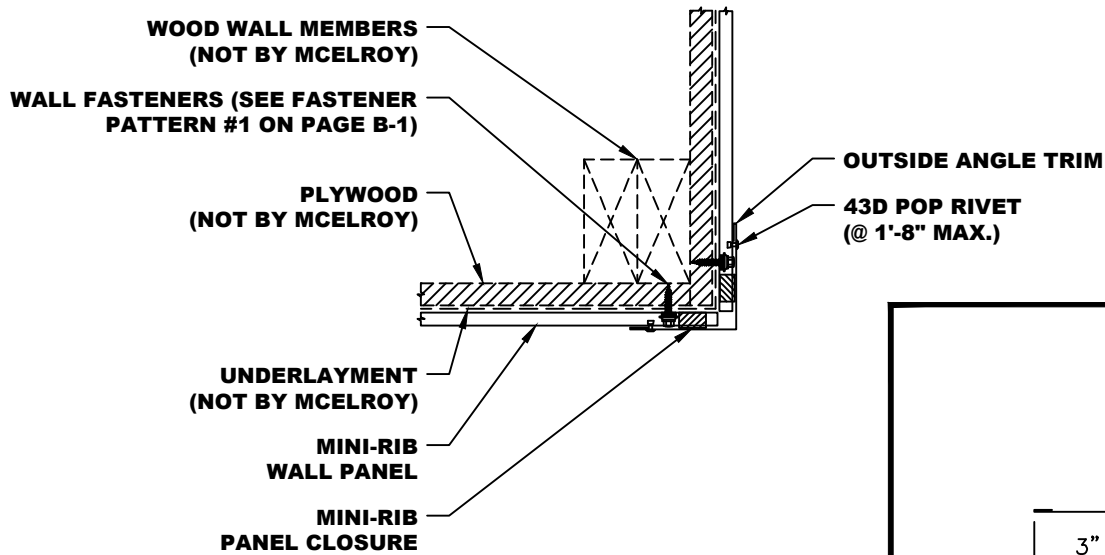

OUTSIDE ANGLE TRIM

- NOTES:** 1. Attach Mini-Rib Panels to Plywood with Wall Fasteners per Fastener Pattern #1 on page B-1 of this manual.  
 2. Install Mini-Rib Panel Closures as required.  
 3. Outside Corner Trim to run from Base Trim to top of wall panel.  
 4. Attach Outside Corner Trim to Mini-Rib Panel with 43D Pop Rivets at 1'-8" O.C. (Max.).

\*NOTE: SOME TRIM ITEMS AND FASTENERS HAVE BEEN REMOVED FOR CLARITY OF ISOMETRIC DETAIL.

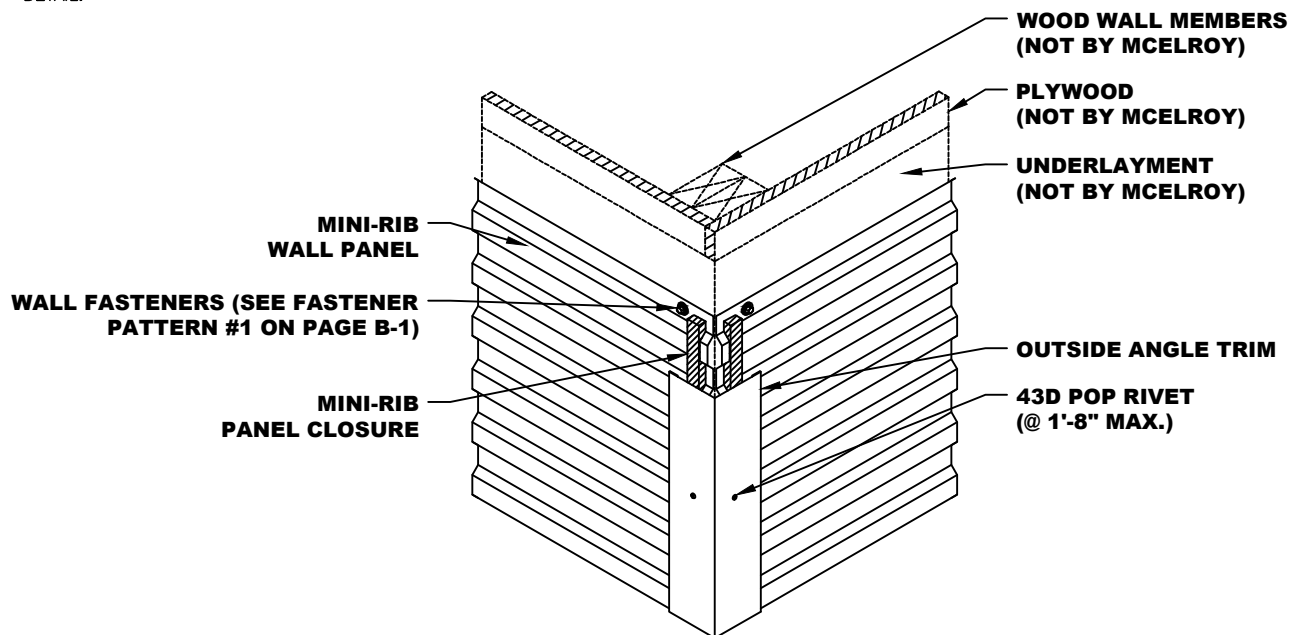

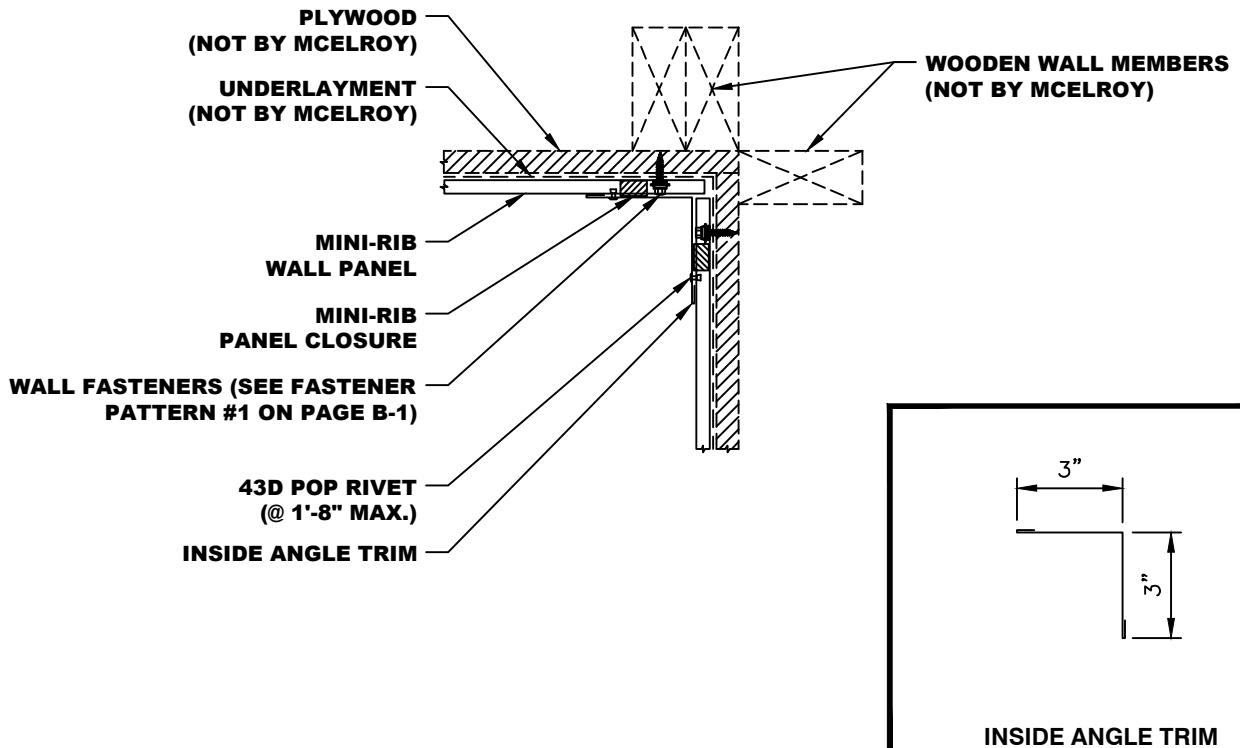

- NOTES:** 1. Attach Mini-Rib Panels to Plywood with Wall Fasteners per Fastener Pattern #1 on page B-1 of this manual.  
 2. Install Mini-Rib Panel Closures as required.  
 3. Inside Corner Trim to run from Base Trim to top of wall panel.  
 4. Attach Inside Corner Trim to Mini-Rib Panel with 43D Pop Rivets at 1'-8" O.C. (Max.).

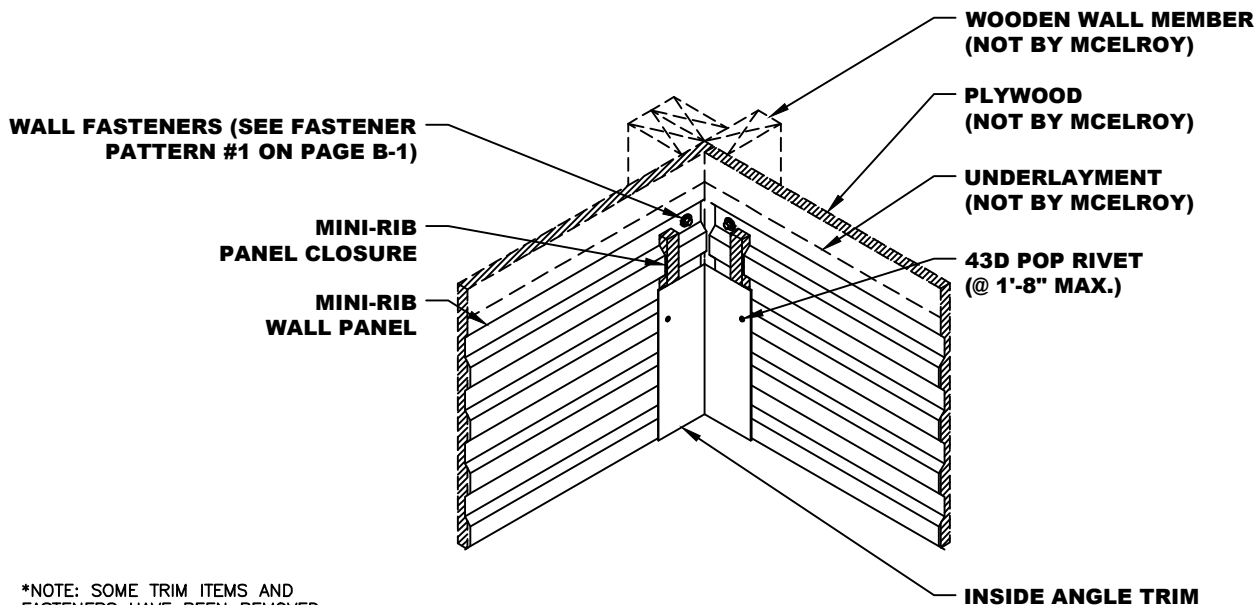

\*NOTE: SOME TRIM ITEMS AND  
FASTENERS HAVE BEEN REMOVED  
FOR CLARITY OF ISOMETRIC  
DETAIL.



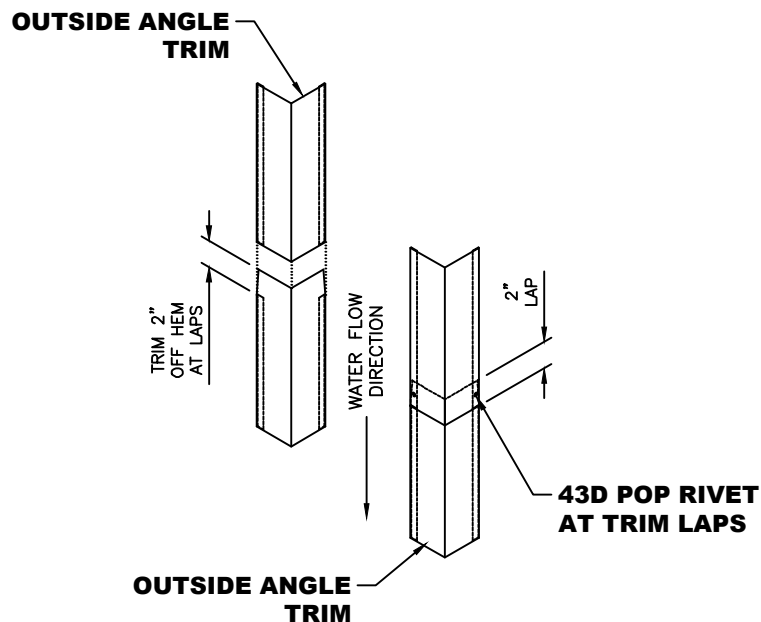
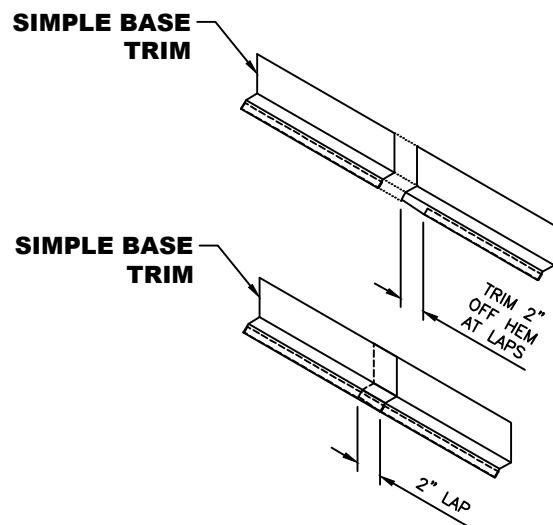
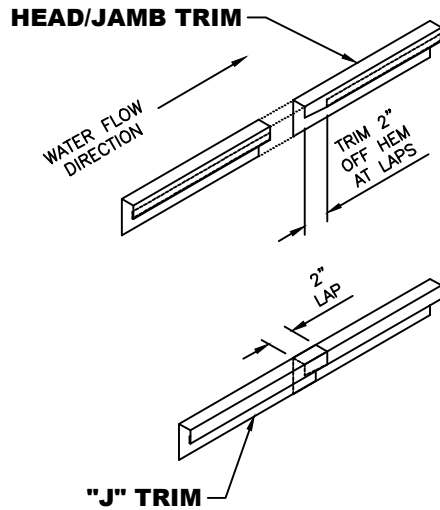

**NOTE:** 1. Apply specified Roll Tape Sealant or a 3/16" Ø bead of Tube Butyl 1 1/2" back from the edge of the trim. Also, apply a piece of tape sealant or bead of Tube Butyl as a Pigtail to completely seal joint.  
2. Notch the hems on the upper trim piece 2" so that the trim will fit flat in the lap joint.  
3. Secure trim laps with Pop Rivets as shown above.



☆ MANUFACTURING LOCATIONS ● SERVICE CENTERS ★ MANUFACTURING AND SERVICE CENTER



**CORPORATE OFFICE**  
1500 HAMILTON RD.  
BOSSIER CITY, LA 71111

## MANUFACTURING LOCATIONS

ADELANTO, CA	ASHBURN, GA	BOSSIER CITY, LA	CLINTON, IL	DIAMOND, MO
HOUSTON, TX	LEWISPORT, KY	LOCKHART, TX	MARSHALL, MI	MAUSTON, WI
MERKEL, TX	PEACHTREE CITY, GA	SUNNYVALE, TX	WINCHESTER, VA	

**McELROY METAL**  
**SERVICE**  
**CENTER**  
EMPLOYEE OWNED

17031 Koala Road  
Adelanto, CA 92301

3052 Yadkin Road  
Chesapeake, VA 23323

409 Lovejoy Road  
Ft. Walton Beach, FL 32548

10504 E. 59th Street  
Indianapolis, IN 46236

1020 Veterans Street  
Mauston, WI 53948

613 North Bierdeman Rd.  
Pearl, MS 39208

8200 Berry Ave. Suite 100  
Sacramento, CA 95828

325 McGhee Rd.  
Winchester, VA 22603

5215 Leo St.  
Alexandria, LA 71301

9476 Meadowbrook Rd.  
Clinton, IL 61727

3014 Lincoln Court  
Garland, TX 75041

32 Industrial Circle  
Lancaster, PA 17601

5123 Terminal Dr.  
McFarland, WI 53558

8511 Industrial Drive  
Pearland, TX 77584

1365 Dean Forest Rd.  
Savannah, GA 31405

1007 Wilso Dr,  
Baltimore, MD 21223

3215 Highway 59  
Diamond, MO 64840

1440 Aldine Bender Road  
Houston, TX 77032

9435 US Hwy. 60 W.  
Lewisport, KY 42351

514 Cave Road  
Nashville, TN 37210

2755 Hwy 60  
Pendergrass, GA 30567

7355 Oakley Industrial Blvd.  
Union City, GA 30291

1500 Hamilton Rd.  
Bossier City, LA 71111

390 N. Valley Dell Dr.  
Fenton, MO 63026

221 Benelli Drive  
Hutto, TX 78634

2701 Cahill Street  
Lockhart, TX 78644

8304 Hwy. 70 E.  
North Little Rock, AR 72117

7450 Tower Street  
Richland Hills, TX 76118

1144 Silstar Rd.  
West Columbia, SC 29170

Website: [www.mcelroymetal.com](http://www.mcelroymetal.com) • E-mail: [info@mcelroymetal.com](mailto:info@mcelroymetal.com)