

# MULTI-COR M-COR

## INSTALLATION

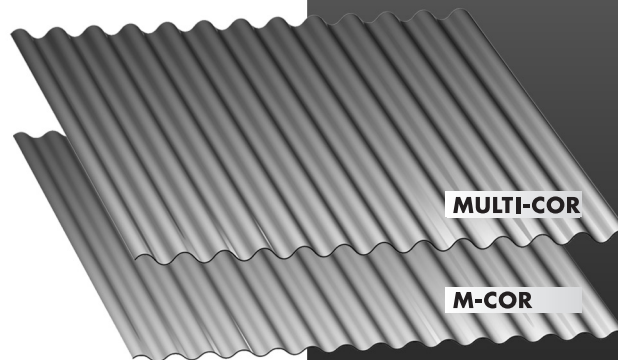

  
**MCELROY  
METAL**

# TABLE OF CONTENTS

PAGE NUMBER:	DETAIL DESCRIPTION
--------------	--------------------

A-1.....	TABLE OF CONTENTS
A-2.....	GENERAL NOTES
B-1.....	FASTENER PATTERN

## WALL DETAILS:

C-1.....	SIMPLE BASE DETAIL
C-2.....	BASE DETAIL
C-3.....	WALL TO GIRT DETAIL
C-4.....	OUTSIDE CORNER DETAIL
C-5.....	HEADER DETAIL
C-6.....	JAMB DETAIL

## ROOF DETAILS:

C-7.....	EAVE DETAIL
C-8.....	EAVE w/ GUTTER DETAIL
C-9.....	END LAP DETAIL
C-10.....	INTERMEDIATE PURLIN DETAIL
C-11.....	RIDGE DETAIL
C-12.....	RAKE DETAIL
C-13.....	RAKE TIE-IN DETAIL
C-14.....	HIGH SIDE EAVE DETAIL
C-15.....	HIGH SIDE TIE-IN DETAIL
C-16.....	MASONARY WAINSCOTT DETAIL
C-17.....	TRIM LAP DETAILS

# GENERAL NOTES

The details shown on the following pages are suggestions or guidelines for installing the Multi-Cor and M-Cor wall and roof panel system. The installation details shown here are proven methods of construction, but they are not intended to cover all building requirements, designs or codes. The details may require changes or revisions due to individual project conditions.

Installation procedures shall be in accordance with the manufacturer's printed instructions, details or approved shop drawings. Installers should thoroughly familiarized themselves with all instructions prior to beginning the installation process.

The designer/installer is responsible to ensure the following:

That the details here meet the particular building requirements.

That adequate water tightness is maintained.

That a proper uniform substructure is used to avoid panel distortion and that the substructure meets necessary code requirements.

That all supporting members have been examined and are straight, level and plumb.

McElroy Metal can provide all flashings and accessories shown in the installation drawings unless noted otherwise. Panels, flashing and trim shall be installed true and in proper alignment with any exposed fasteners equally spaced for the best appearance. Sealant shall be field applied on a clean, dry surface.

Some field cutting and fitting of panels and flashings is to be expected and to be considered a part of normal installation work. Workmanship shall be of the best industry standards and with installation performed by experienced metal craftsmen.

Oil canning of metal panels is inherent in the product and is not a cause for rejection.

Contents of this manual are subject to change without notice. To confirm this book is the most current copy, please visit McElroy Metal's website at [www.mcelroymetal.com](http://www.mcelroymetal.com).

## FASTENER PATTERNS

1/4"-14 X 7/8" LAP TEK ZAC  
FASTENER (@ EVERY THIRD RIB)

TRIM

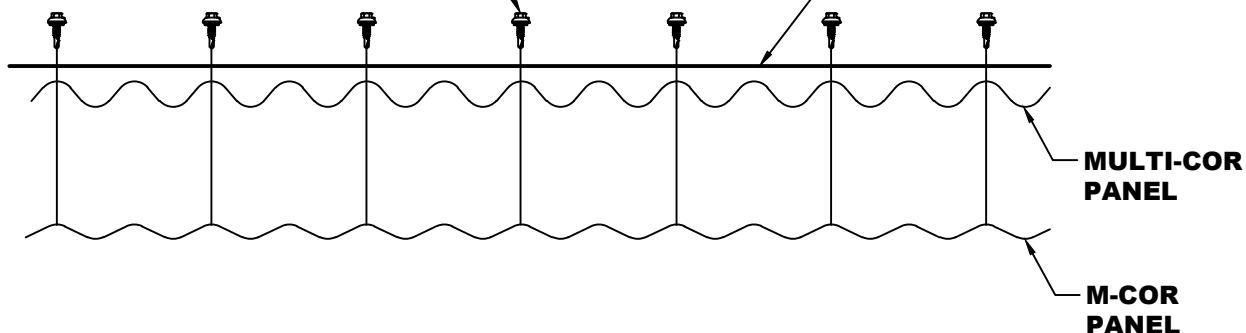

TRIM FASTENER PATTERN

FASTENER (PATTERN #1)

STITCH FASTENER  
(1'-8 O.C.)



FASTENER (PATTERN #2)

STITCH FASTENER  
(1'-8 O.C.)



FASTENER (PATTERN #1)

STITCH FASTENER  
(1'-8 O.C.)

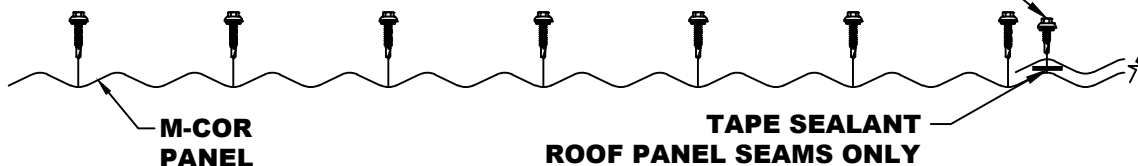

FASTENER (PATTERN #2)

STITCH FASTENER  
(1'-8 O.C.)

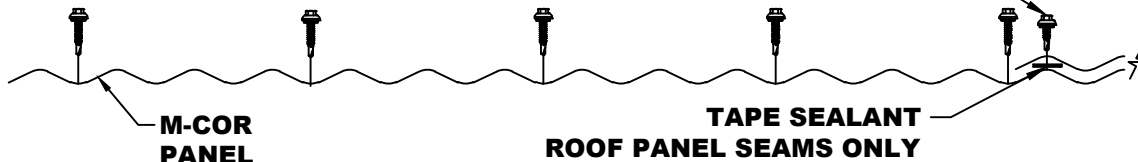

PANEL FRAMING AND STITCH FASTENER PATTERNS

# SIMPLE BASE DETAIL

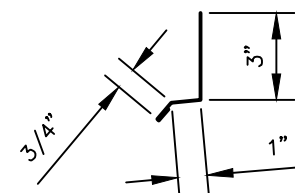
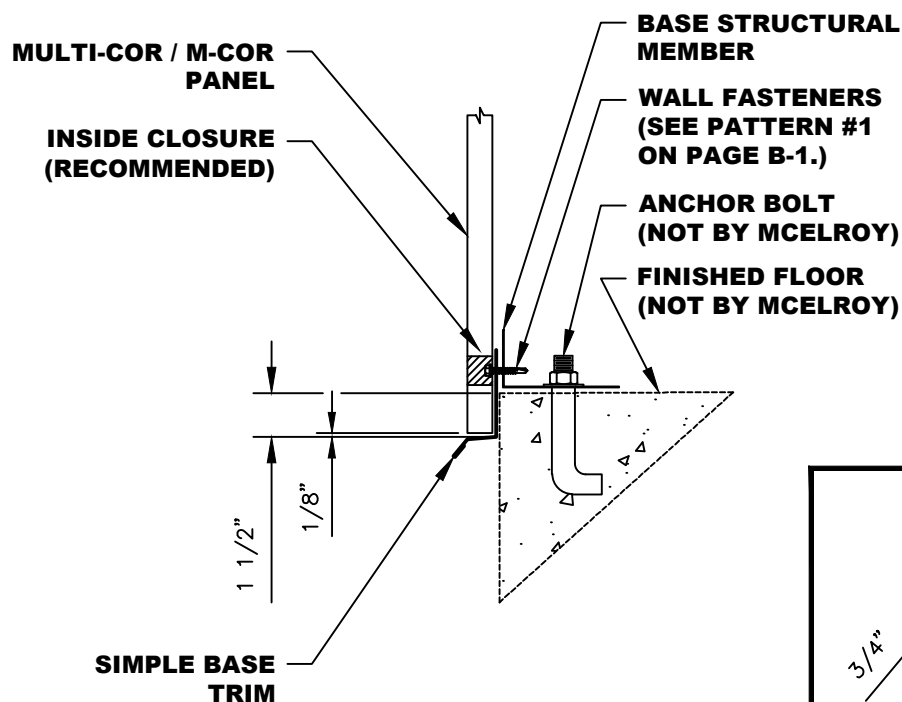

**SIMPLE BASE TRIM**

- NOTES:**
1. Base Structural Member set flush with edge of Finished Floor.
  2. Set Simple Base Trim 1 1/2" down face of finished floor.
  3. Set Closure in position on Simple Base Trim.
  4. Set Multi-Cor / M-Cor Wall Panel into Place. Make sure to leave a 1/8" gap between trim and panel.
  5. Attach panel with Wall Fasteners per Fastening Pattern (See Fastener Pattern #1 on Page B-1.)

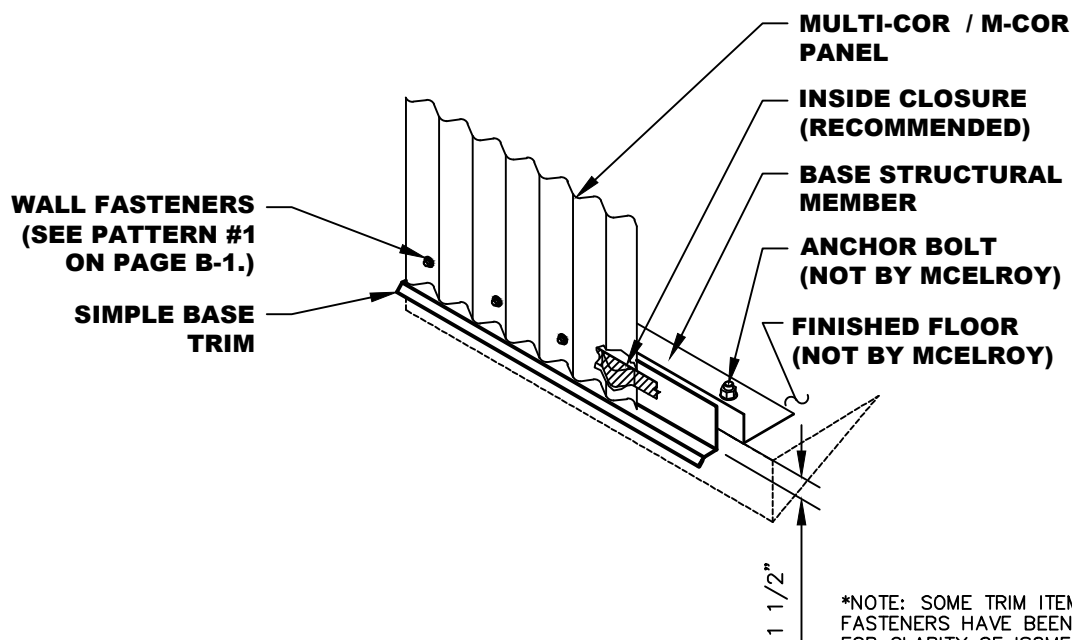

\*NOTE: SOME TRIM ITEMS AND FASTENERS HAVE BEEN REMOVED FOR CLARITY OF ISOMETRIC DETAIL.

## BASE DETAIL

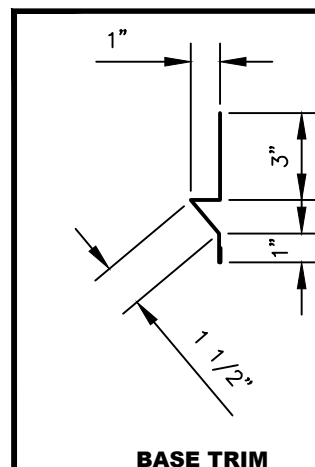
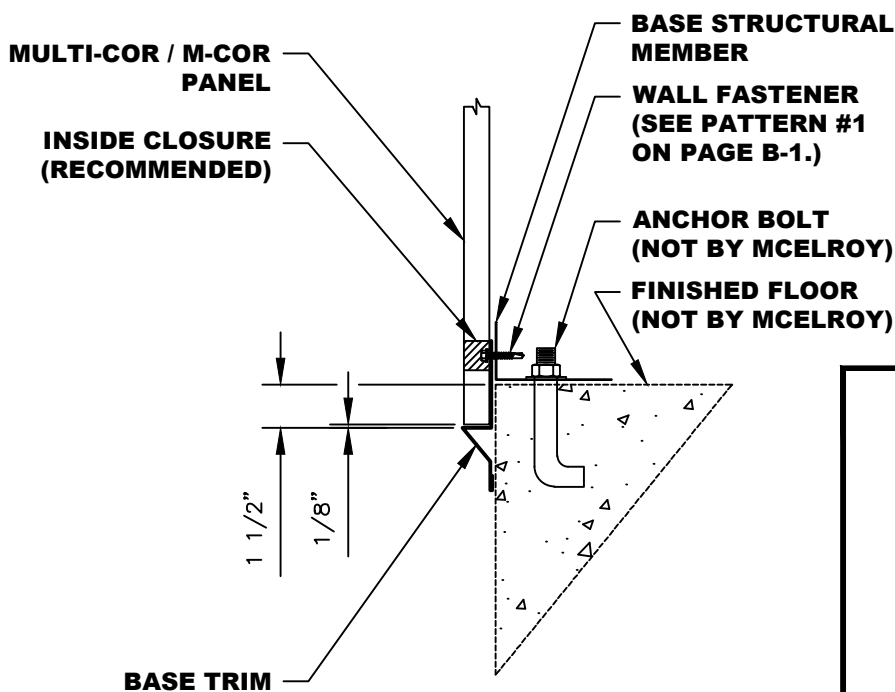

- NOTES:**
1. Base Structural Member set flush with edge of Finished Floor.
  2. Set Base Trim 1 1/2" down face of finished floor.
  3. Set Closure in position on Base Trim.
  4. Set Multi-Cor / M-Cor Wall Panel into place. Make sure to leave a 1/8" gap between trim and panel.
  5. Attach panel with Wall Fasteners per Fastening Pattern (See Fastener Pattern #1 on Page B-1).

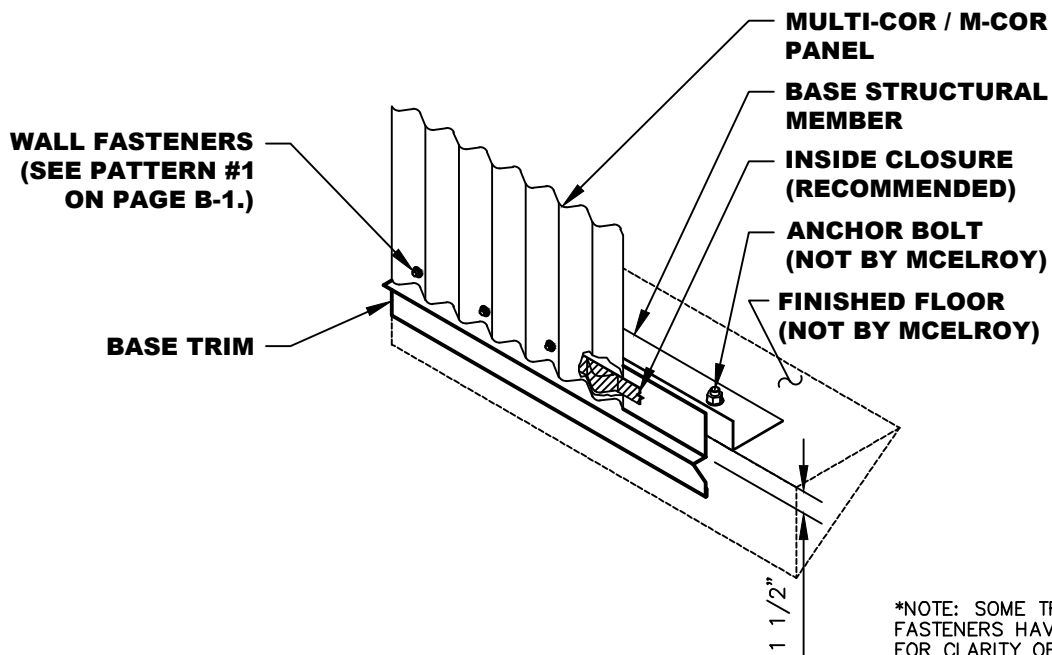

\*NOTE: SOME TRIM ITEMS AND FASTENERS HAVE BEEN REMOVED FOR CLARITY OF ISOMETRIC DETAIL.

## WALL PANEL TO GIRT DETAIL

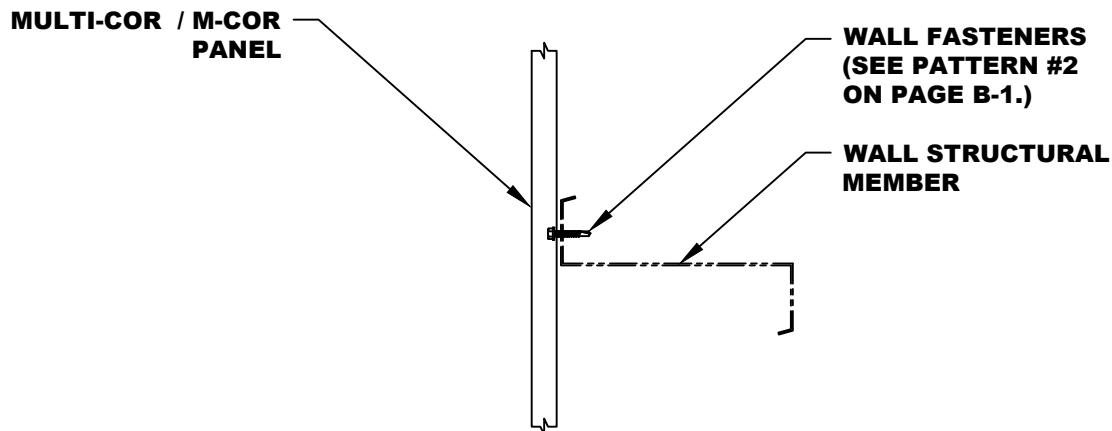

**NOTES: 1. Attach Multi-Cor / M-Cor Wall Panel to Wall Structural Member with Wall Fasteners (see Fastener Fastener Pattern #2 On Page B-1).**

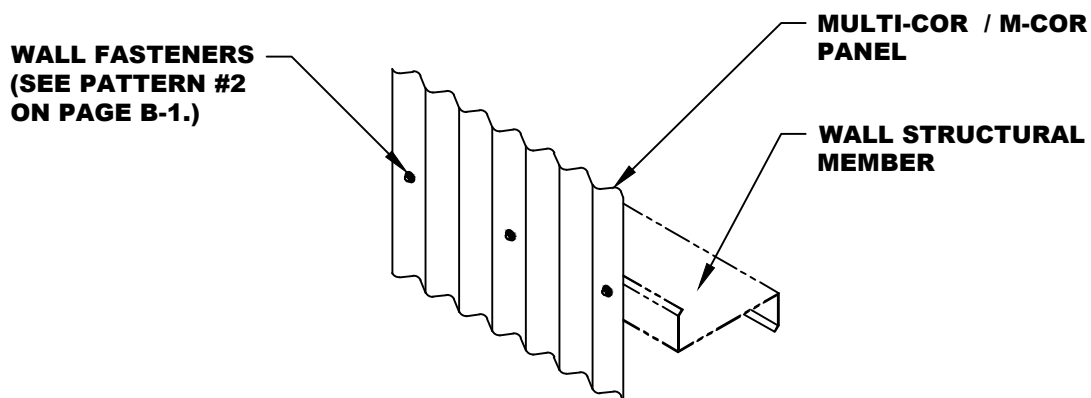

\*NOTE: SOME TRIM ITEMS AND FASTENERS HAVE BEEN REMOVED FOR CLARITY OF ISOMETRIC

# OUTSIDE CORNER DETAIL

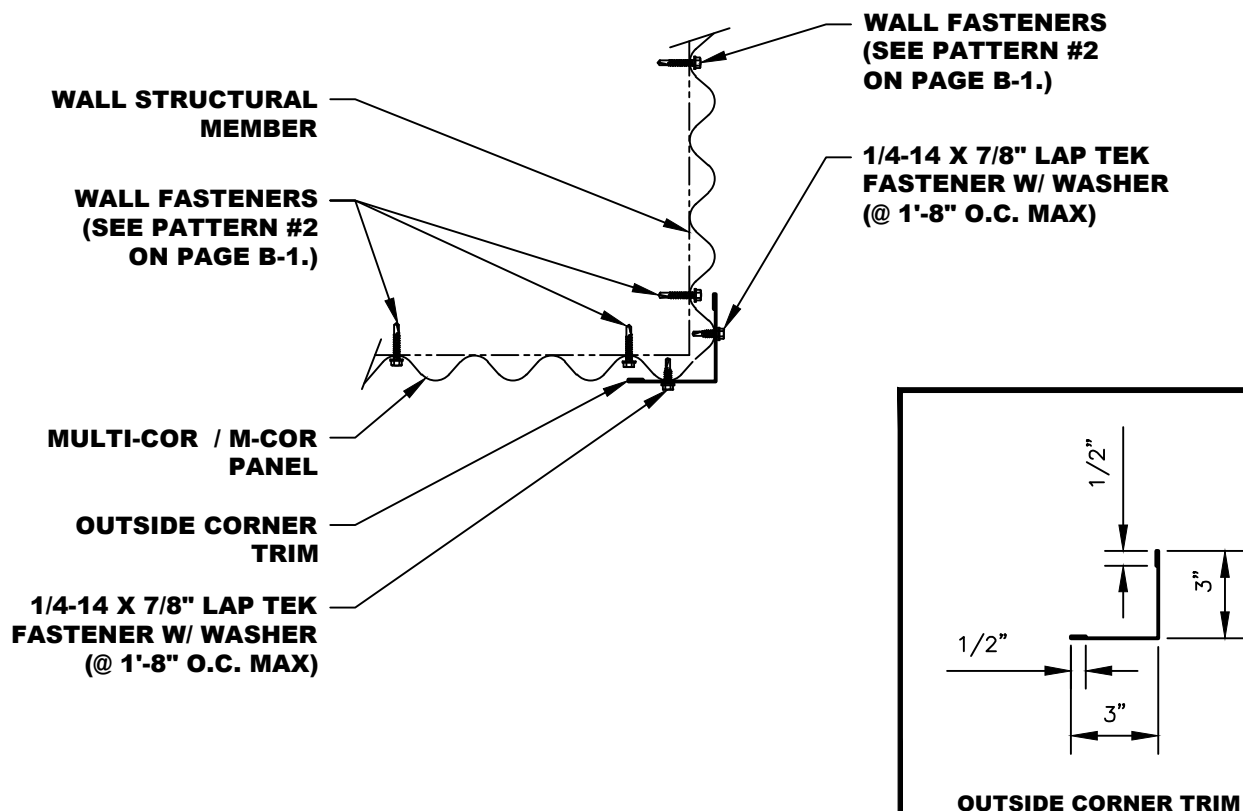

**NOTES: 1. Attach Multi-Cor / M-Cor Wall Panel to Wall Structural Member with Wall Fasteners using Fastener Pattern #2. (See Fastener Pattern #2 On Page B-1.)**

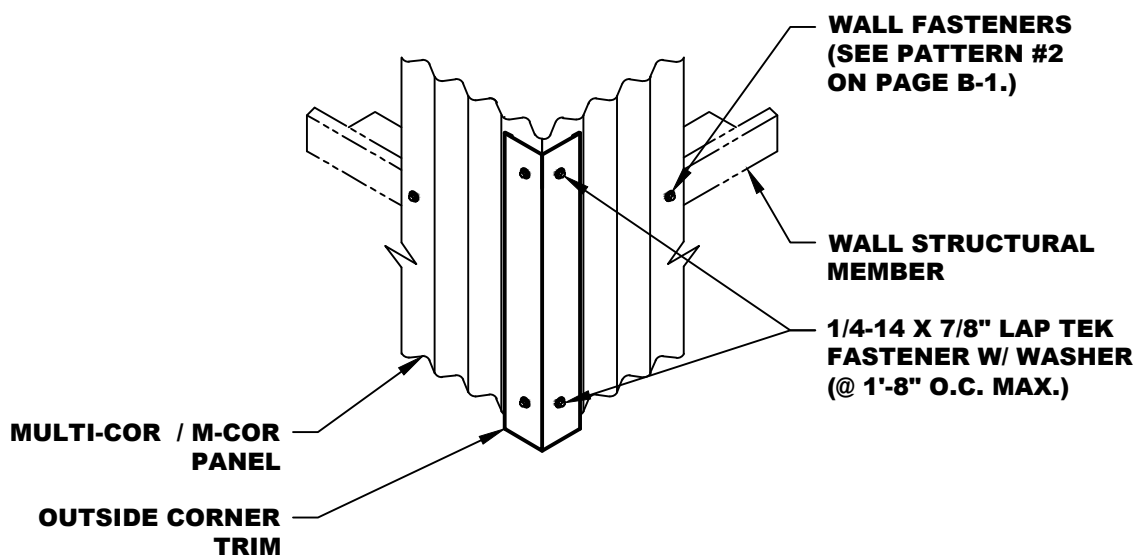

\*NOTE: SOME TRIM ITEMS AND FASTENERS HAVE BEEN REMOVED FOR CLARITY OF ISOMETRIC DETAIL.



# HEADER DETAIL

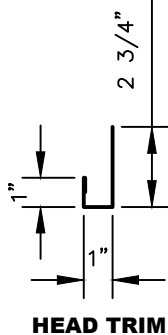
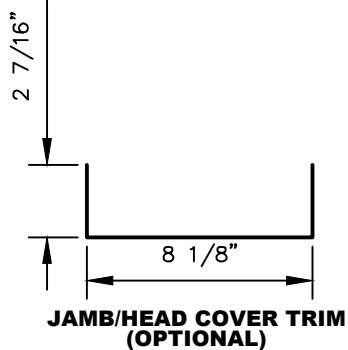
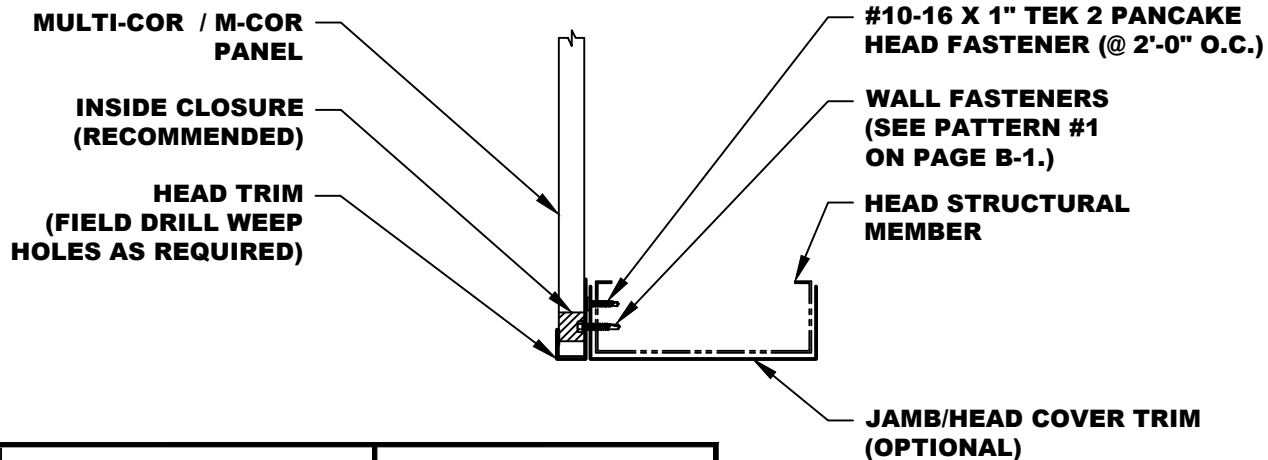

- NOTES:** 1. Attach Head Trim to Header using #10-16 x 1" TEK 2 Pancake Head Fastener every 2'-0" O.C.  
2. Set Inside Closure in position on Head Trim.  
3. Install Multi-Cor / M-Cor Panel to Header Structural Member with Wall Fasteners. (See Fastener Pattern #1 On Page B-1)

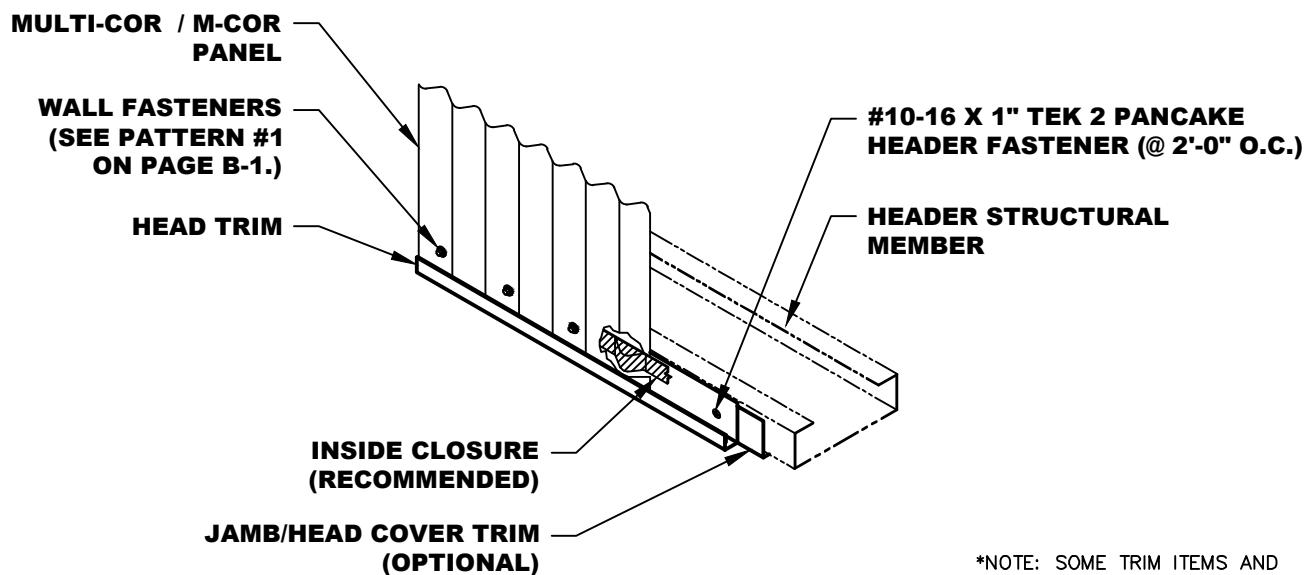

\*NOTE: SOME TRIM ITEMS AND FASTENERS HAVE BEEN REMOVED FOR CLARITY OF ISOMETRIC

# JAMB DETAIL

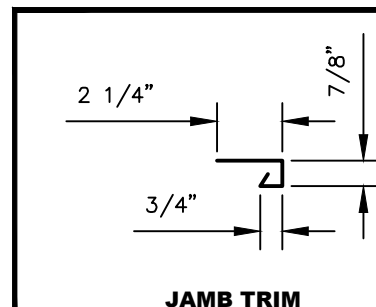
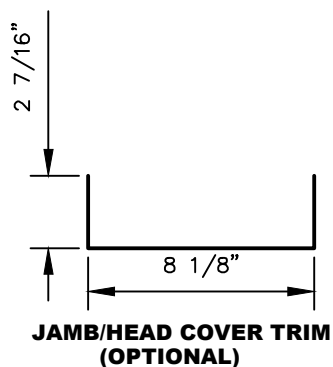
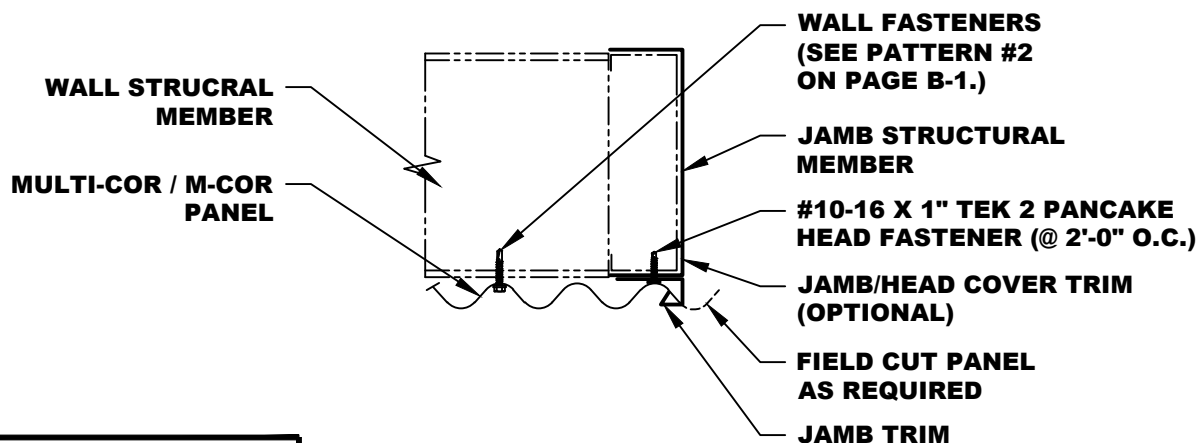

- NOTES:** 1. Attach Jamb Trim to Jamb Structural Member using #10-16 x 1" TEK 2 Pancake Head Fasteners (See Fastener Pattern #2).  
2. Install MULTI-COR / M-COR Panel to Wall Structural Member with Wall Fasteners. (See Fastener Pattern #2 on Page B-1).

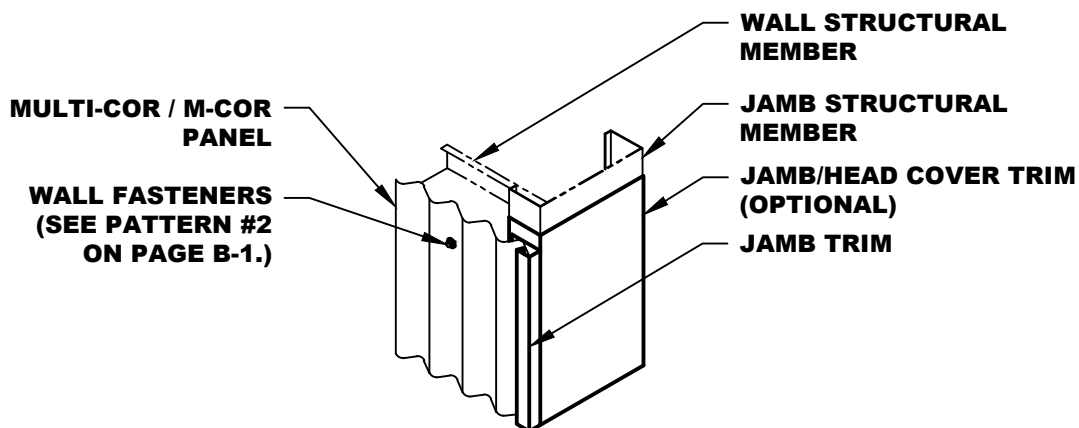

\*NOTE: SOME TRIM ITEMS AND FASTENERS HAVE BEEN REMOVED FOR CLARITY OF ISOMETRIC

## EAVE DETAIL

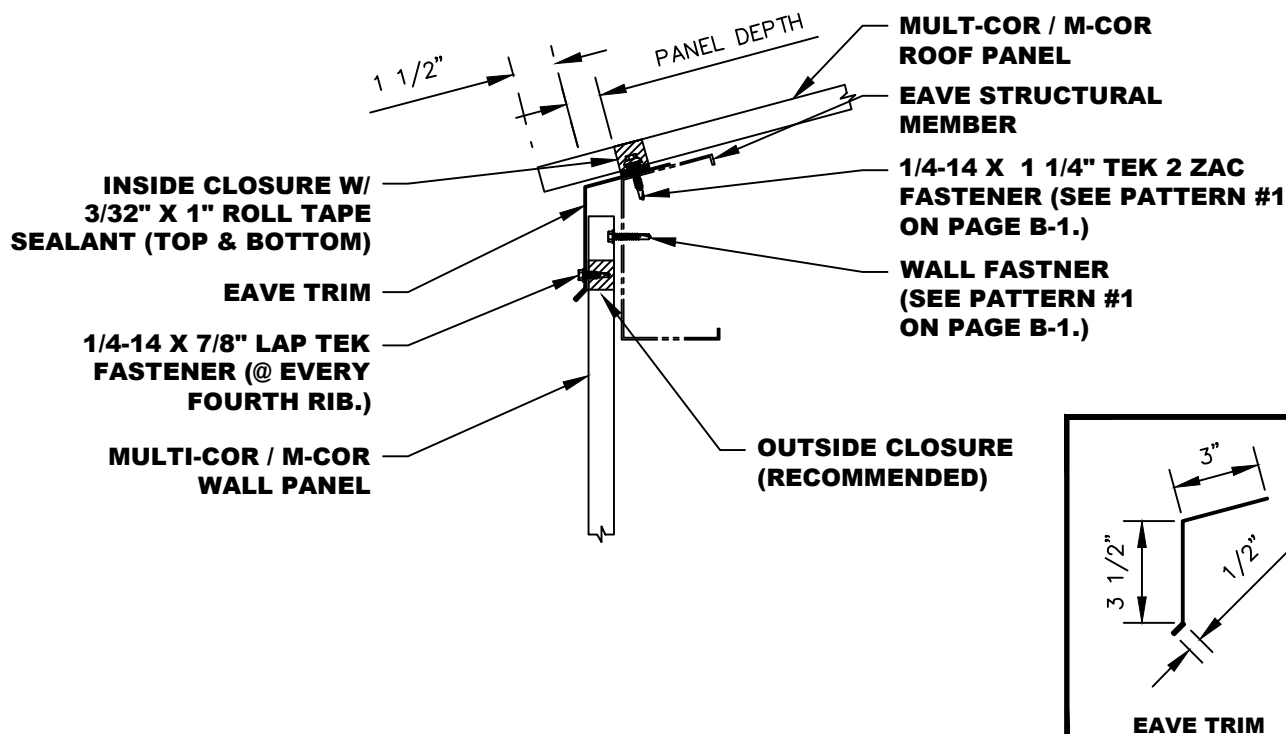

- NOTES:**
1. Attach Wall Panel to Eave Structural Member with Wall Fastener per Fastener Pattern. (See Fastener Pattern #1 On Page B-1)
  2. Eave Trim to run from out of wall to out of wall.
  3. Trim pieces lap 2". Apply 3/32" x 3/8" Butyl Tape Sealant in trim laps and Pop Rivet trims as on page C-17.
  4. Attach Eave Trim to Wall Panel at major ribs with 1/4-14 x 7/8" Lap TEK Fasteners.
  5. Apply continuous run of 1" Butyl Tape Sealant on top of Simple Eave Trim.
  6. Set Closures in tape and apply another continuous run of 1" Butyl Tape Sealant on top of closures.
  7. Attach Multi-Cor / M-Cor Roof Panels in place with 1/4-14 x 1 1/4" TEK 2 ZAC with Washer. (See Pattern Fastener #1).

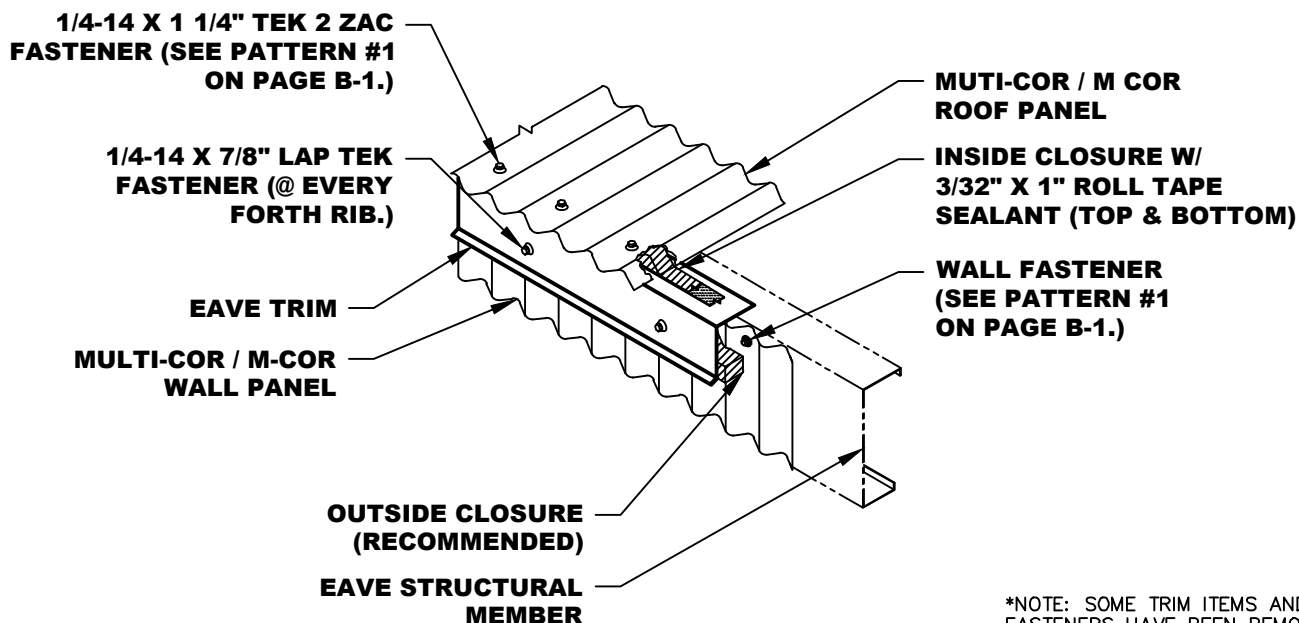

\*NOTE: SOME TRIM ITEMS AND FASTENERS HAVE BEEN REMOVED FOR CLARITY OF ISOMETRIC

# EAVE w/ GUTTER DETAIL

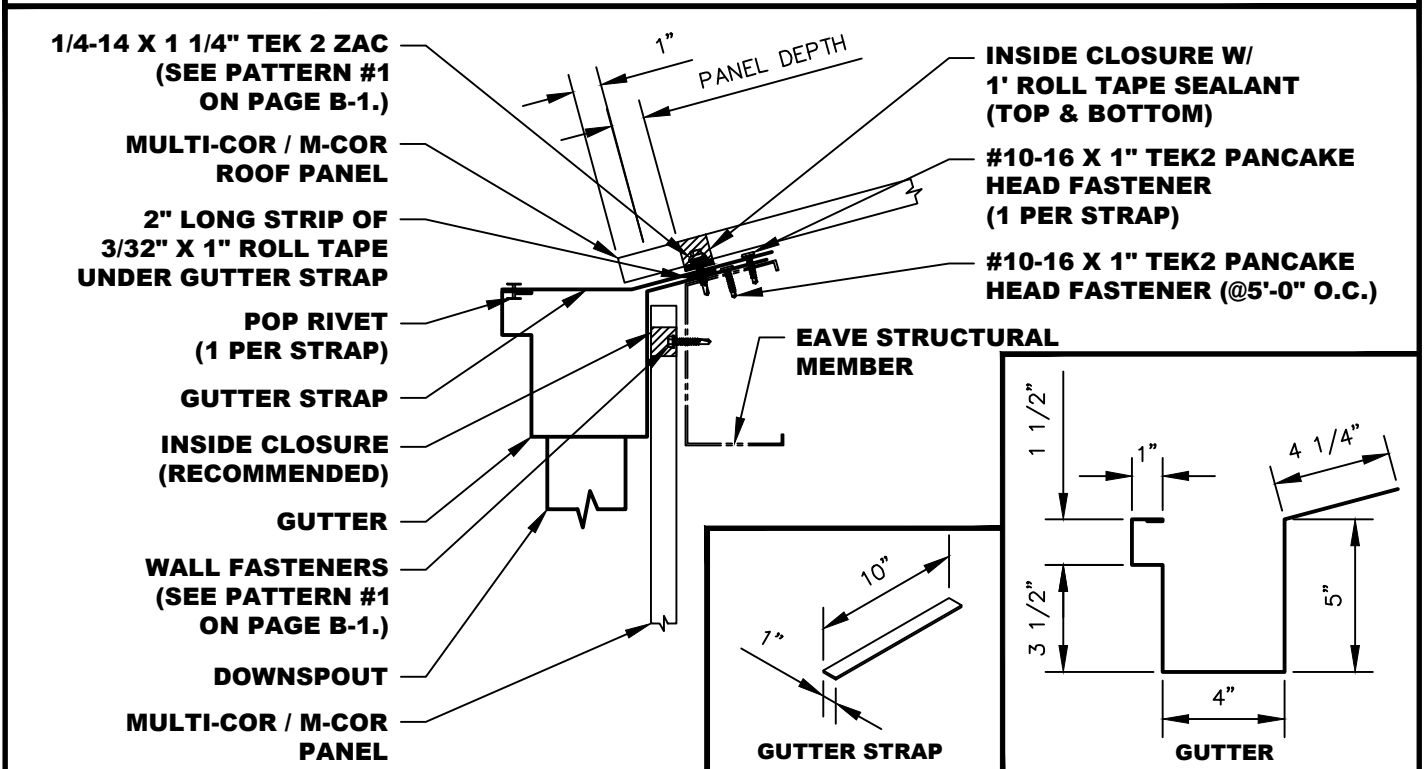

- NOTES:**
1. Attach Multi-Cor / M-Cor Wall Panel to Eave Structural Member with Wall Fasteners. (See Fastener Pattern #1 On Page B-1)
  2. Gutter to run from out of wall to out of wall. Attach to Eave Structural Member with #10-16 x 1" Tek2 Pancake Head Fasteners at 5'-0" O.C.
  3. Trim pieces lap 2". Apply 3/32" x 3/8" Butyl Tape or Butyl Tube Sealant at trim laps and Pop Rivet trims as shown on page C-17.
  4. Place a 2" long piece of 3/32" x 1" Roll Tape on gutter flange where Gutter Straps will fall. Attach Gutter Strap to Gutter with (1) 43D Pop Rivet and attach to Eave Structural Member with (1) #10-16 x 1" Tek2 Pancake Head Fastener at 5'-0" O.C.
  5. Apply a continuous run of 1" Roll Tape Sealant on top of gutter flange.
  6. Set Inside Closures in tape and apply another continuous run of 1" Roll Tape Sealant on top of closures.
  7. Attach Multi-Cor / M-Cor Roof Panels with 1/4-14 x 1 1/4" TEK 2 ZAC. (See Fastener Pattern #1 on page B-1).

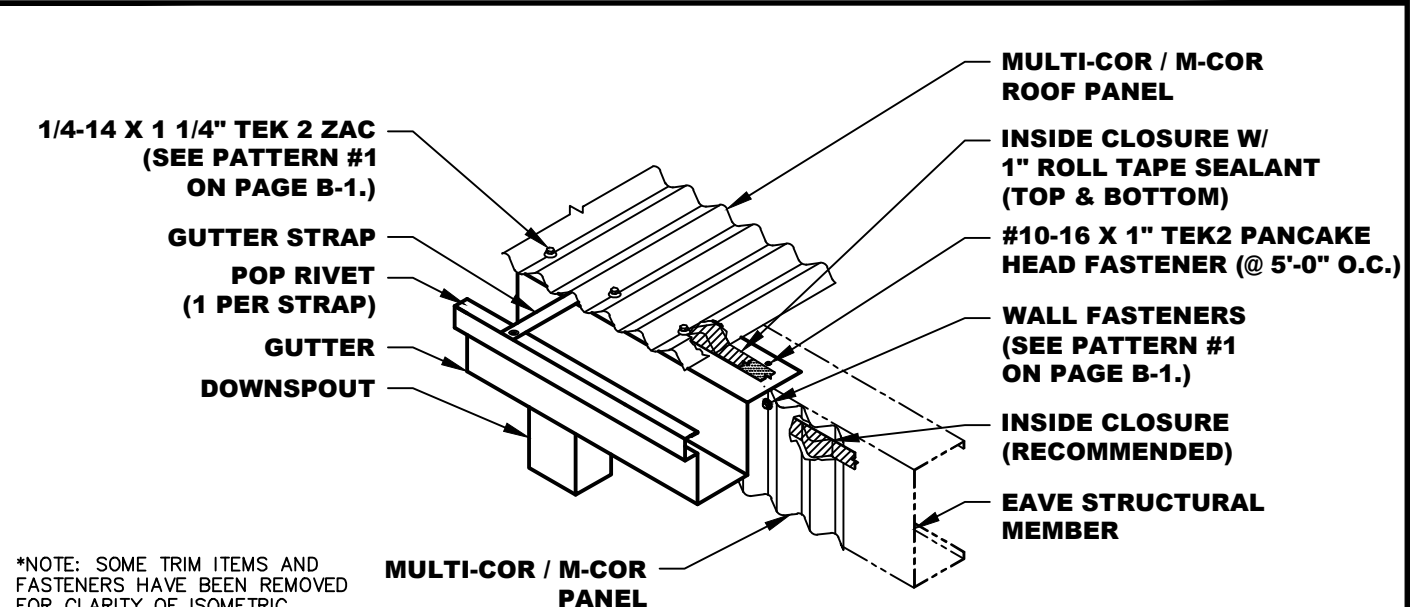

\*NOTE: SOME TRIM ITEMS AND FASTENERS HAVE BEEN REMOVED FOR CLARITY OF ISOMETRIC

## END LAP DETAIL

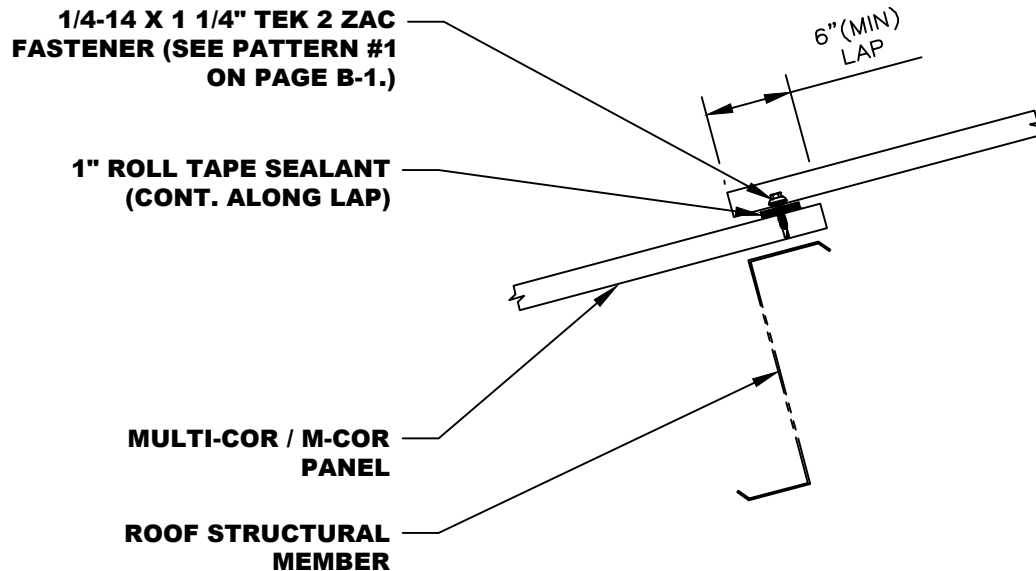

- NOTES:**
1. Extend lower Multi-Cor / M-Cor Roof Panel 6" past web of Roof Structural Member.
  2. Apply continuous run of 1" Roll Tape Sealant on top of lower Multi-Cor / M-Cor panel 5 3/4" down from end of panel.
  3. Install upper Multi-Cor / M-Cor panel and fasten with 1/4-14 x 1 1/4" TEK 2 ZAC Fasteners with Washer. (See Fastener Pattern #1 On Page B-1).

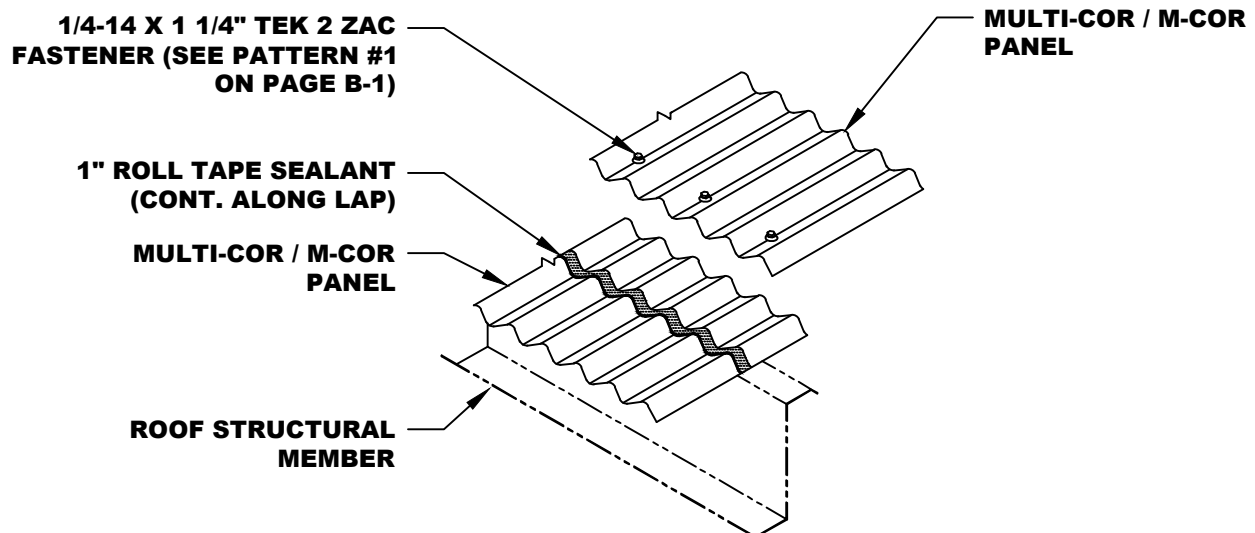

\*NOTE: SOME TRIM ITEMS AND FASTENERS HAVE BEEN REMOVED FOR CLARITY OF ISOMETRIC

## INTERMEDIATE PURLIN DETAIL

1/4-14 X 1 1/4" TEK 2 ZAC  
FASTENER (SEE PATTERN #2  
ON PAGE B-1.)

MULTI-COR / M-COR  
ROOF PANEL

ROOF STRUCTURAL  
MEMBER

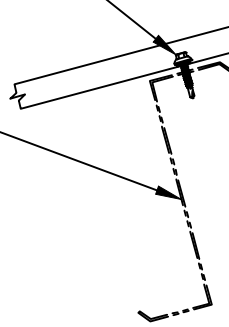

**NOTES: 1. Attach Multi-Cor / M-Cor Roof Panels with 1/4-14 x 1 1/4" TEK 2 ZAC Fasteners with Washer.**  
(See Fastener Pattern #2 On Page B-1).

1/4-14 X 1 1/4" TEK 2 ZAC  
FASTENER (SEE PATTERN #2  
ON PAGE B-1.)

MULTI-COR / M-COR  
PANEL

ROOF STRUCTURAL  
MEMBER

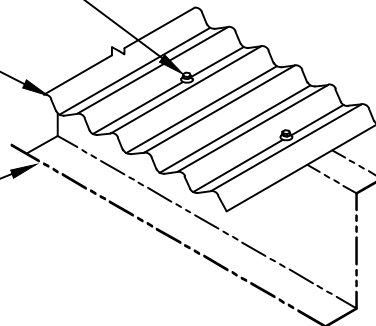

\*NOTE: SOME TRIM ITEMS AND  
FASTENERS HAVE BEEN REMOVED  
FOR CLARITY OF ISOMETRIC

## RIDGE DETAIL

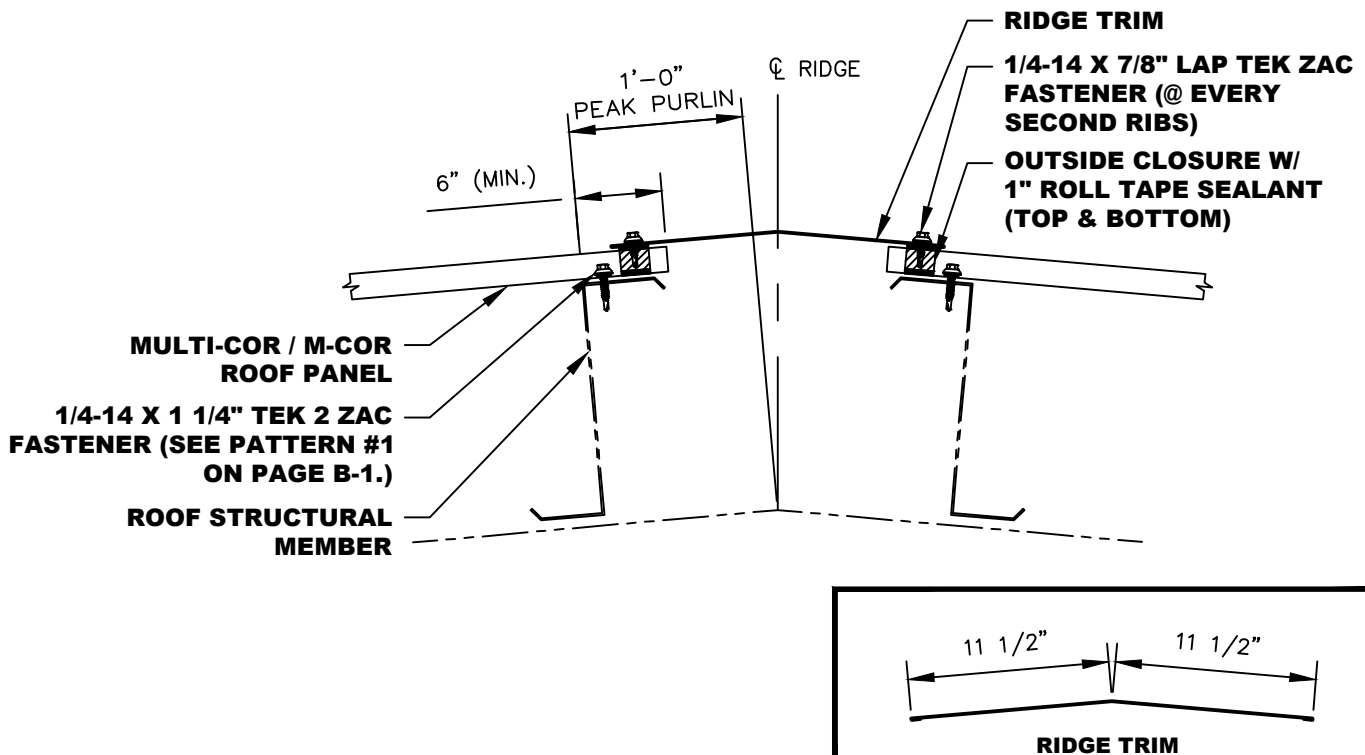

- NOTES:**
1. Attach Multi-Cor / M-Cor Roof Panels with #12-14 x 1 1/4" Lap TEK 2 Fastener with Washer (See Fastener Pattern #1 On Page B-1).
  2. Install a continuous line of 1" Butyl Tape Sealant above fasteners. Seat Outside Closures in tape sealant. Install another continuous line of 1" Tape Sealant on top of closures.
  3. Attach Ridge Trim to roof panels with #12-14 x 7/8" Lap TEK ZAC Fastener with Washer at major ribs. Make sure fastener penetrates sealant.
  4. Trim pieces lap 2". Apply 3/32" x 3/8" Butyl Tape or Butyl Tube Sealant at trim laps and secure trim joint with #12-14 x 7/8" Lap TEK ZAC Fastener with Washer at every second rib.

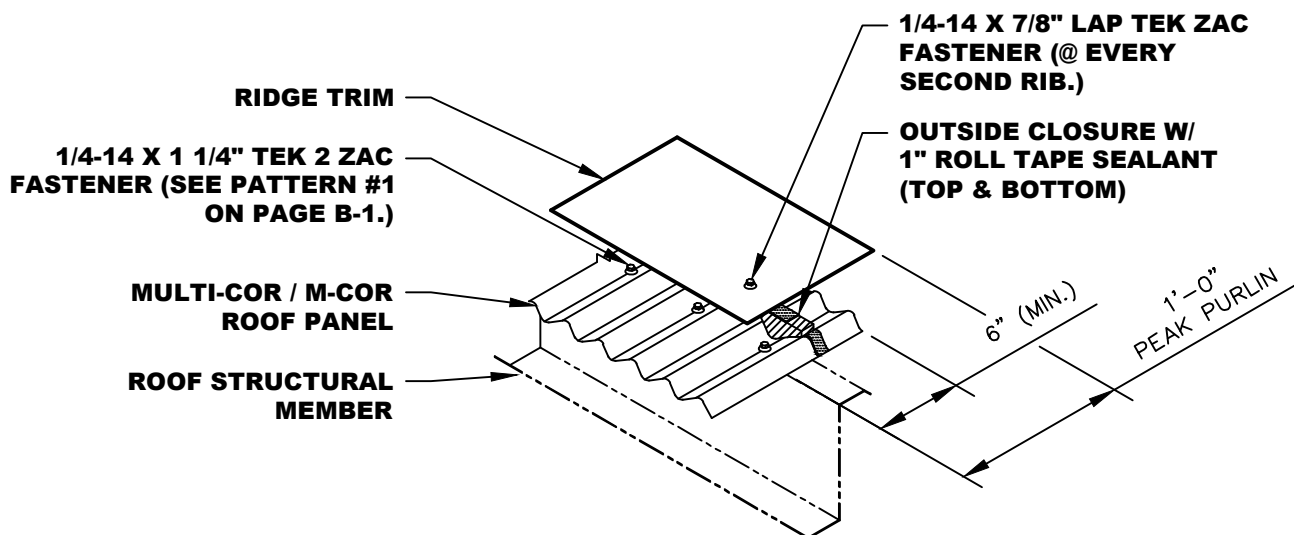

\*NOTE: SOME TRIM ITEMS AND FASTENERS HAVE BEEN REMOVED FOR CLARITY OF ISOMETRIC

## RAKE DETAIL

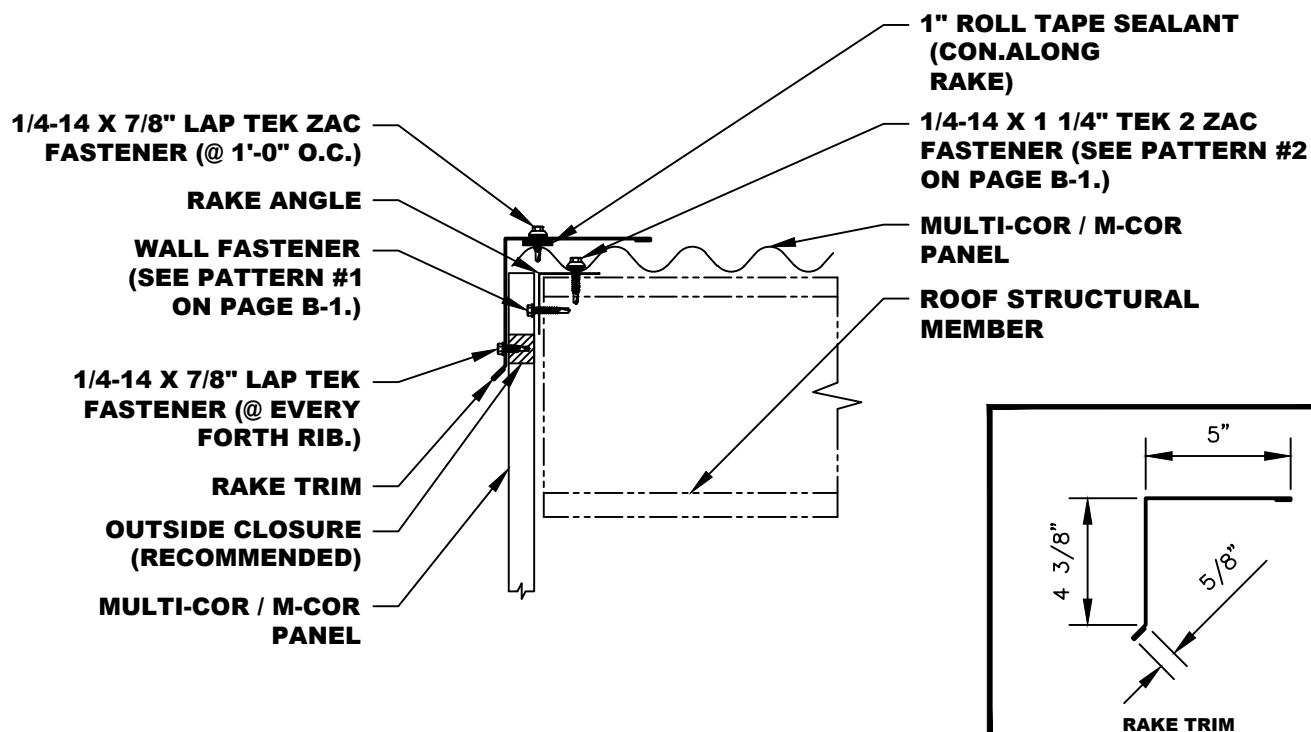

- NOTES:**
1. Attach Multi-Cor / M-Cor Panel to Rake Angle with Wall Fasteners using Fastener Pattern #1 on page B-1.
  2. Attach Multi-Cor / M-Cor Panel Roof Panels in place with 1/4"-14 x 1 1/4" TEK 2 ZAC Fastener with washer (See Fastener pattern #2 On Page B-1).
  3. Install a continuous line of 1" Butyl Tape Sealant were Rake Trim rest on roof panel.
  4. Attach Rake Trim to roof panels with 1/4-14 x 7/8" Lap TEK ZAC Fasteners with Washers @ 1'-0" O.C.
  5. Attach Rake Trim to Multi-Cor / M-Cor Panels with 1/4-14 x 7/8" Lap TEK Fasteners with Washer (See Fastener pattern #2 On Page B-1).
  6. Trim lap 2". Apply 3/32" x 3/8" Butyl Tape or Butyl Tube Sealant at trim laps and secure trim joint with 1/4-14 x 7/8" Lap TEK with washer at every forth rib.

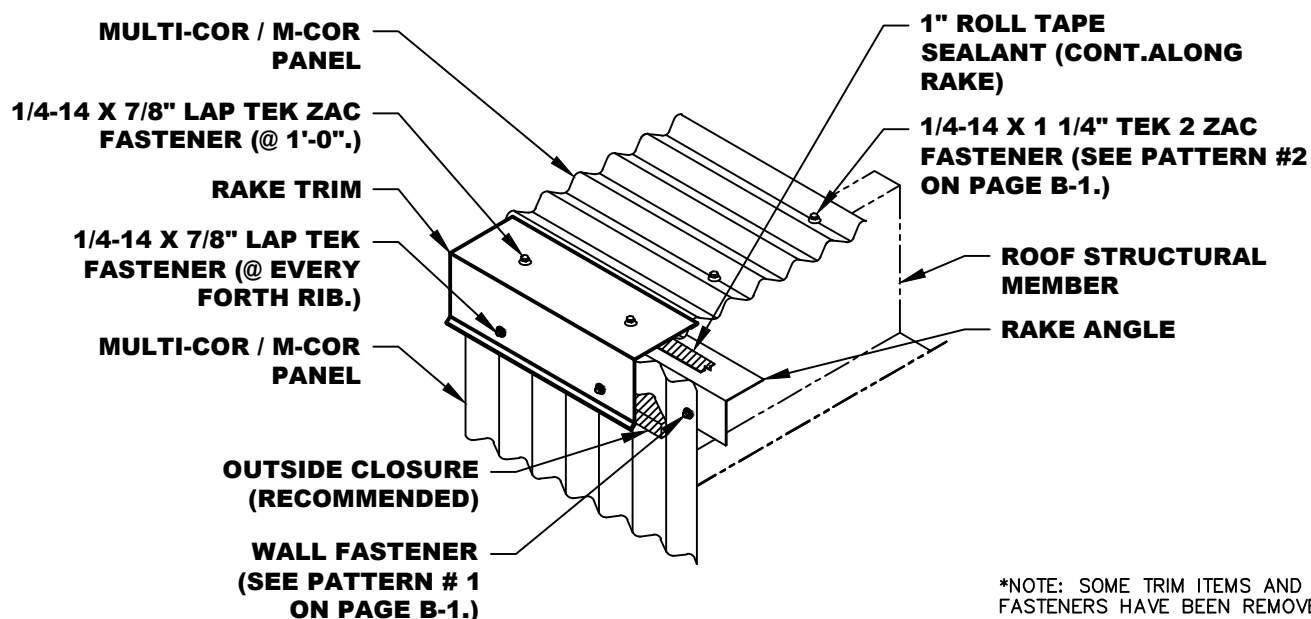

\*NOTE: SOME TRIM ITEMS AND FASTENERS HAVE BEEN REMOVED FOR CLARITY OF ISOMETRIC



## RAKE TIE-IN DETAIL

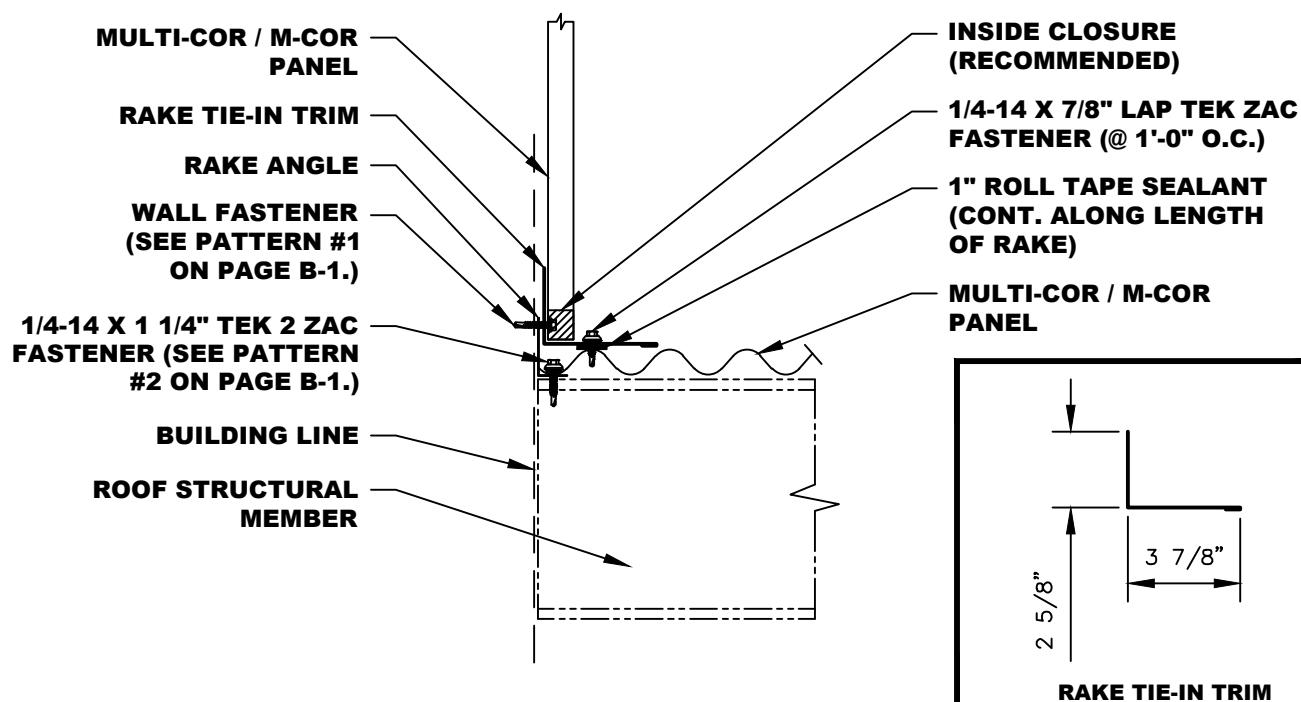

- NOTES:**
1. Attach Multi-Cor / M-Cor Panels with Wall Fastener. (See Fastener Pattern #2 on page B-1)
  2. Install a continuous line of 1" Butyl Tape Sealant where Rake Tie-In Trim rest on roof panel.
  3. Attach Rake Trim to roof panels with #1/4"-14 x 7/8" Lap TEK ZAC Fastener at 1' O.C.
  4. Trim pieces lap 2". Apply 3/32" x 3/8" Butyl Tape or Butyl Tube Sealant at trim laps and secure trim joint with 1/4-14 x 7/8" Lap TEK ZAC.

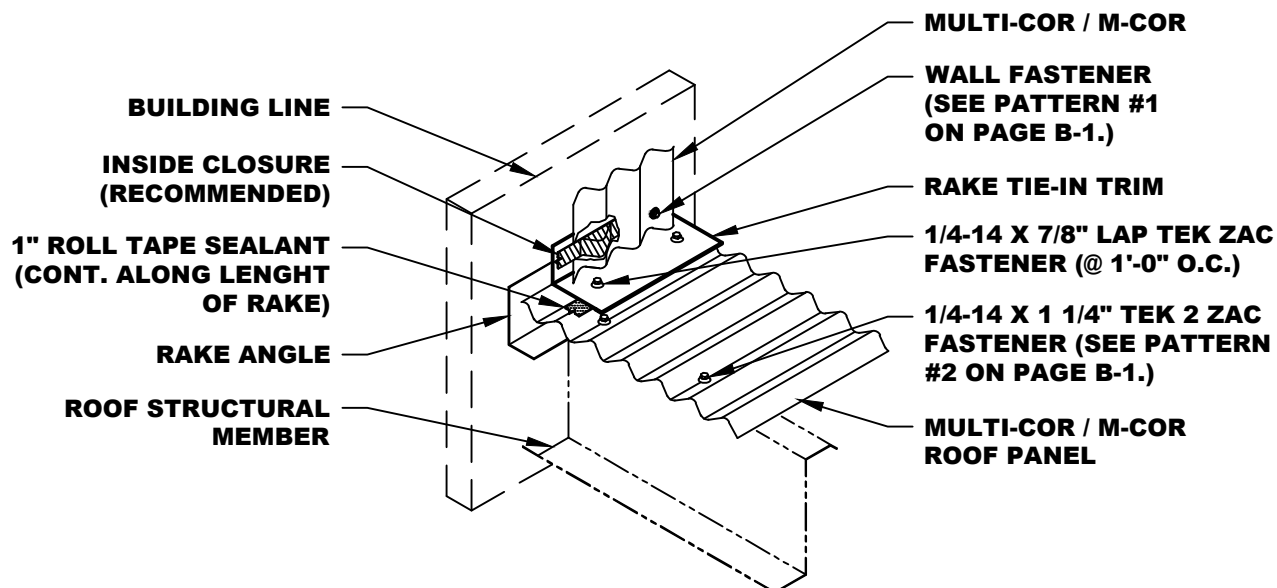

\*NOTE: SOME TRIM ITEMS AND FASTENERS HAVE BEEN REMOVED FOR CLARITY OF ISOMETRIC

# HIGH SIDE EAVE DETAIL

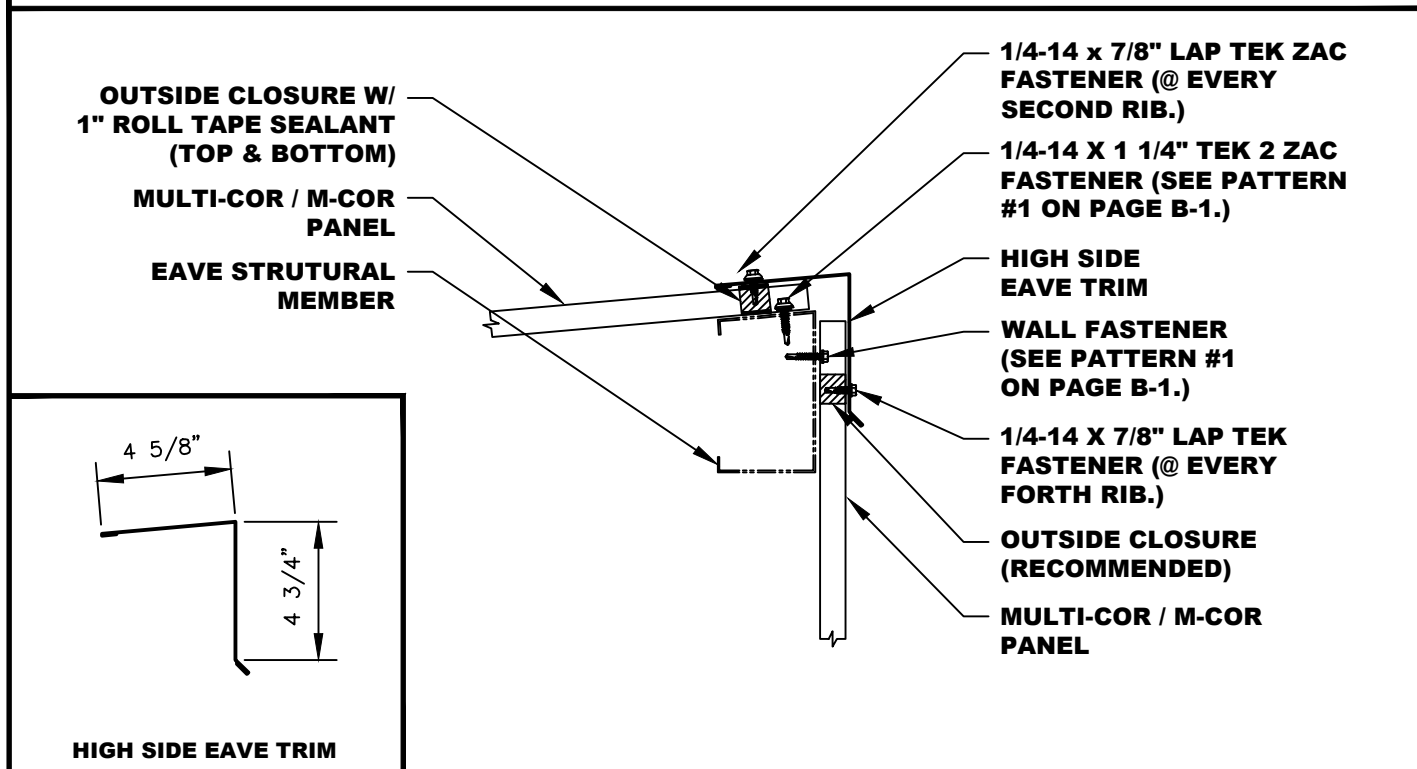

- NOTES:**
1. Attach Wall Panel to Eave Structural Member with Wall Fasteners. (See Fastener Pattern #1 on Page B-1).
  2. Attach Multi-Cor / M-Cor Roof Panels with 1/4-14 x 1 1/4" Tek2 ZAC Fastener. (See Fastener Pattern #1 On Page B-1).
  3. Install a continuous line of 1" Butyl Tape Sealant below fasteners. Seat Outside Closures in tape sealant. Install another continuous line of 1" Tape Sealant on top of closures.
  4. Attach High Side Eave Trim to roof panels with 1/4-14 x 7/8" Lap TEK ZAC with washer at major ribs. Make sure fastener penetrates sealant.
  5. Trim pieces lap 2". Apply 3/32" x 3/8" Butyl Tape or Butyl Tube Sealant at trim laps and secure trim joint with 1/4-14 x 7/8" Lap TEK ZAC with Washer at major ribs.

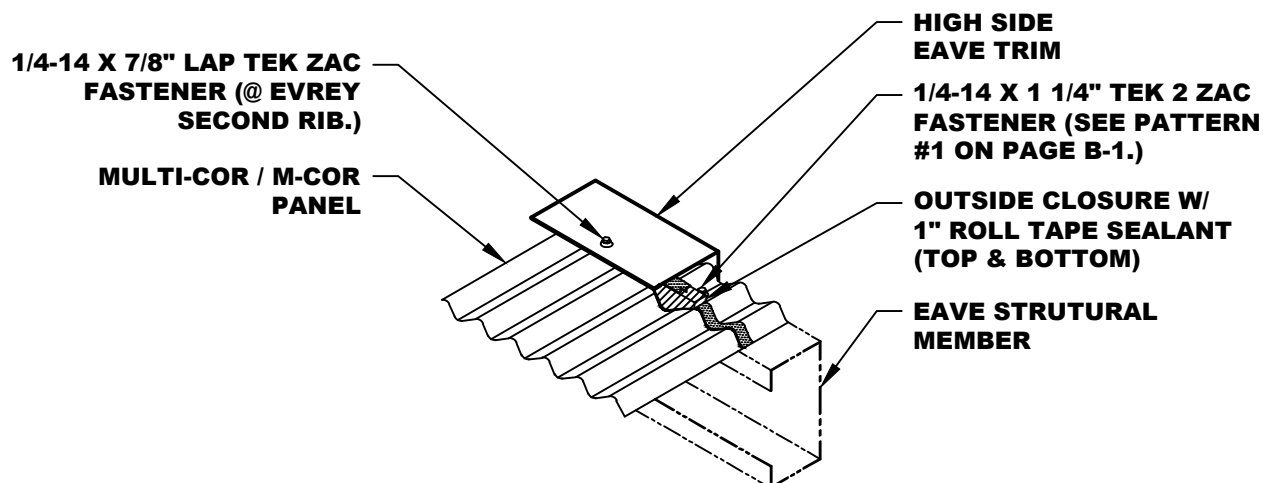

\*NOTE: SOME TRIM ITEMS AND FASTENERS HAVE BEEN REMOVED FOR CLARITY OF ISOMETRIC

## HIGH SIDE TIE-IN DETAIL

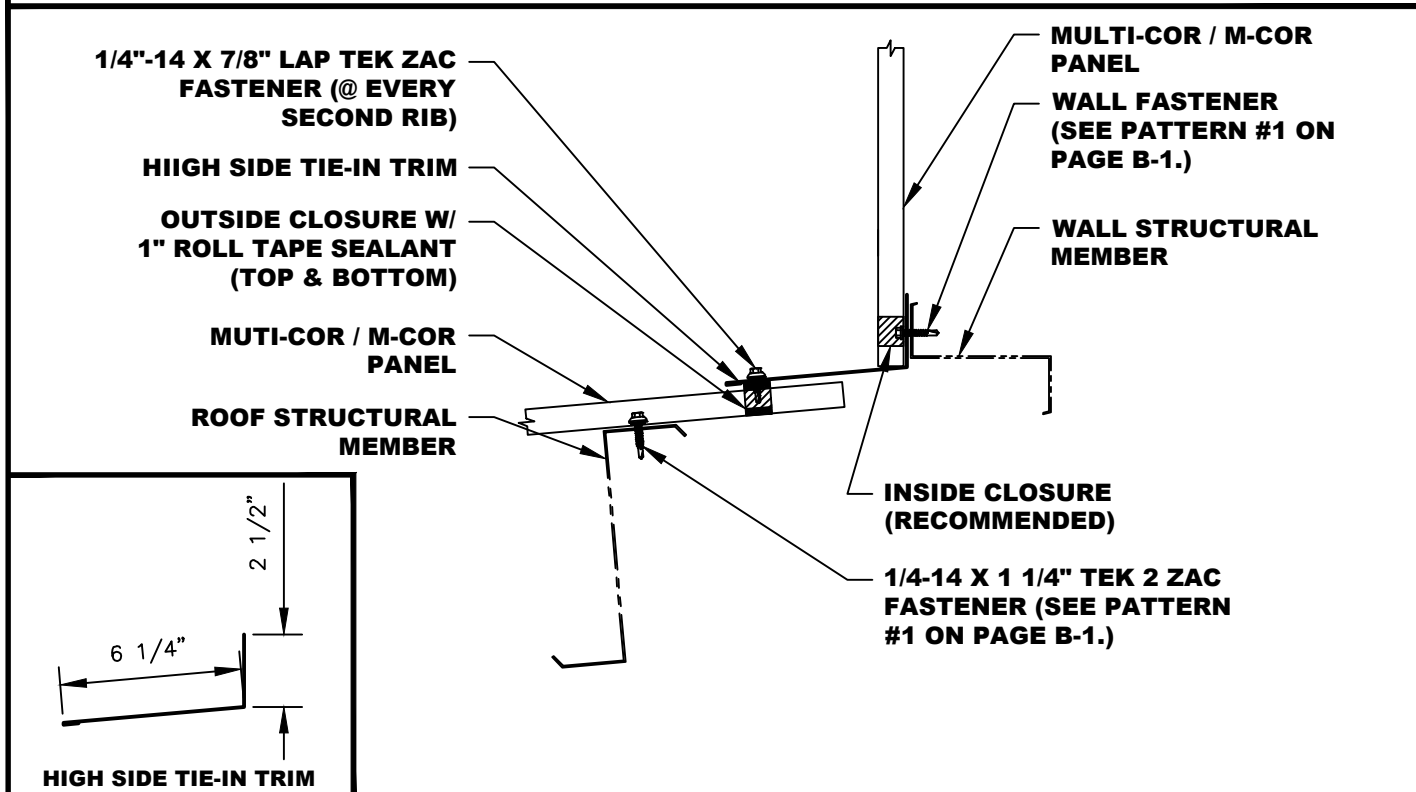

- NOTES:**
1. Attach Multi-Cor / M-Cor Panels with Wall Fasteners using Fastener Pattern #1. (See Fastener Patterns On Page B-1).
  2. Install a continuous line of 1" Butyl Tape Sealant. Seat Outside Closures in tape sealant. Install another continuous line of 1" Butyl Tape Sealant on top of closures.
  3. Attach High Side Tie-In Trim to roof panels with 1/4-14 x 7/8" Lap TEK ZAC with washer at major ribs. make sure fastener penetrates sealant.
  4. Trim pieces lap 2". Apply 3/32" x 3/8" Butyl Tape or Butyl Tube Sealant at trim laps and secure trim joint with 1/4-14 x 7/8" Lap TEK ZAC at major ribs.

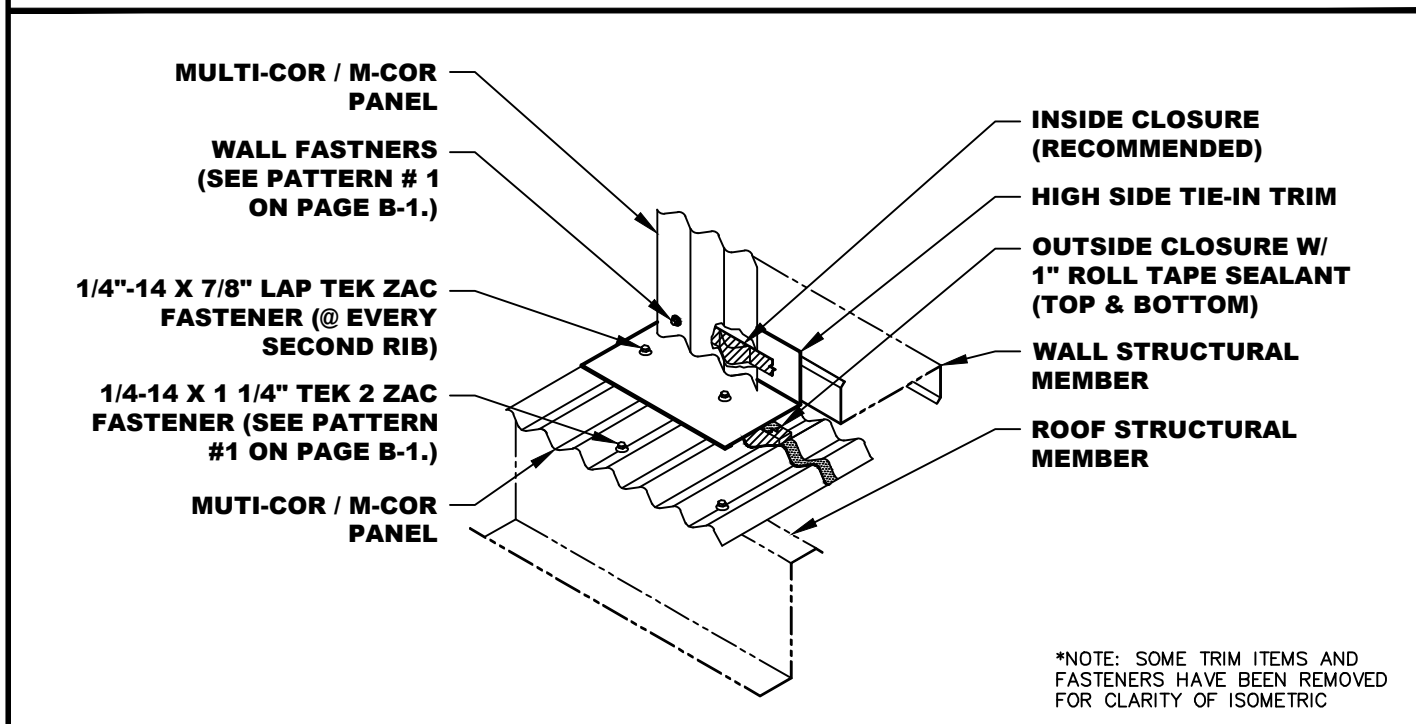

# MASONRY WAINSCOAT DETAIL

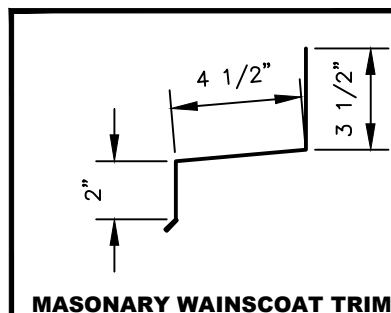
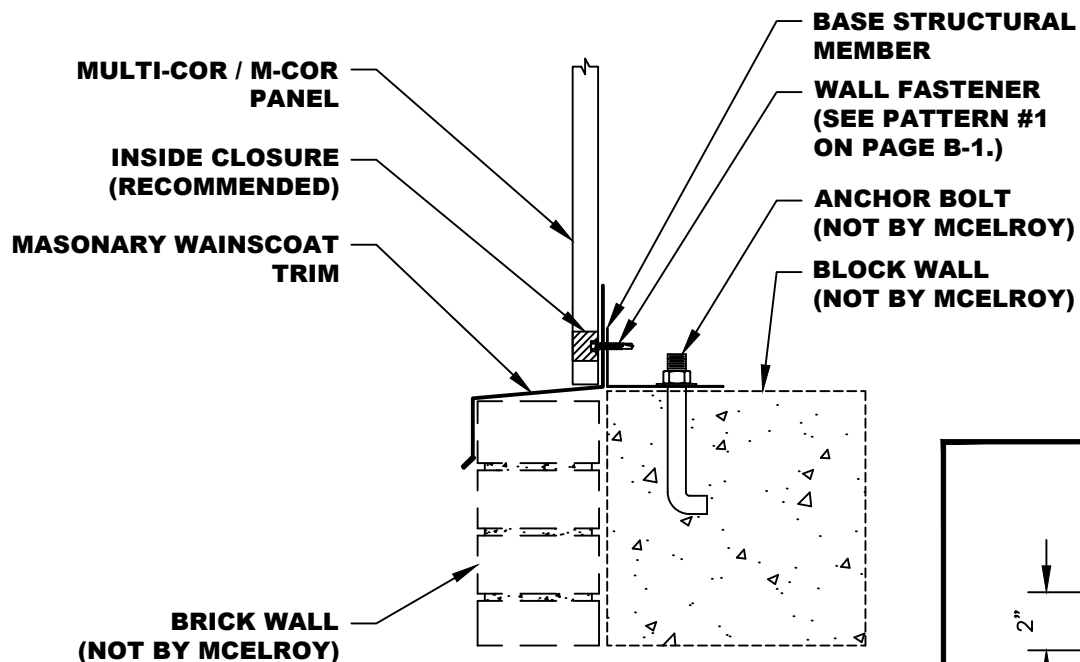

- NOTES:**
1. Attach Masonry Wainscoat Trim to Base Structural Member with Temporary Framing Fasteners.
  2. Set Inside Closure in place.
  3. Attach Multi-Cor / M-Cor Wall Panels with Wall Fasteners using Fastener Pattern #1. (See Fastener Patterns on Page B-1).

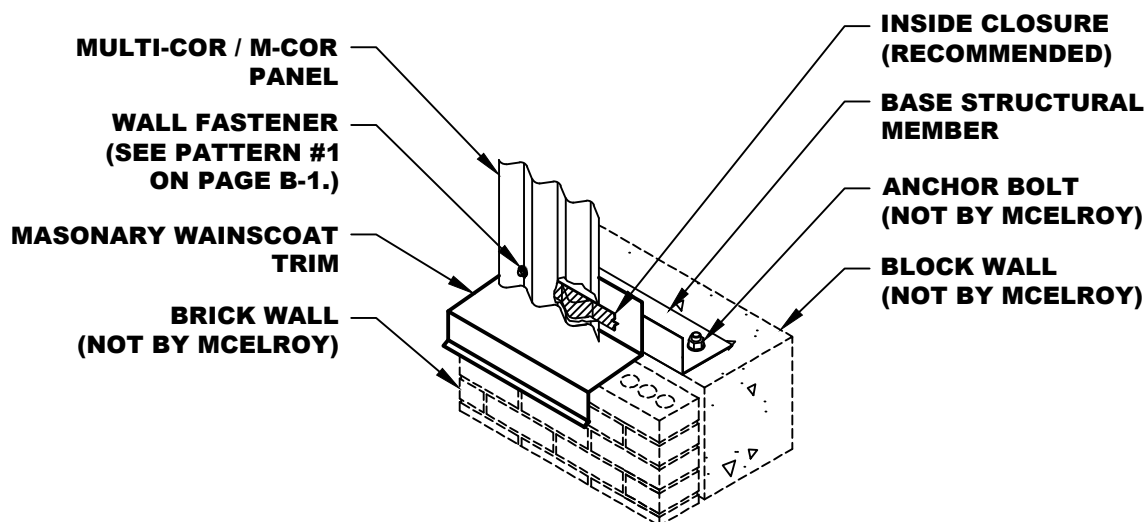

\*NOTE: SOME TRIM ITEMS AND FASTENERS HAVE BEEN REMOVED FOR CLARITY OF ISOMETRIC

## TYPICAL TRIM LAP DETAIL

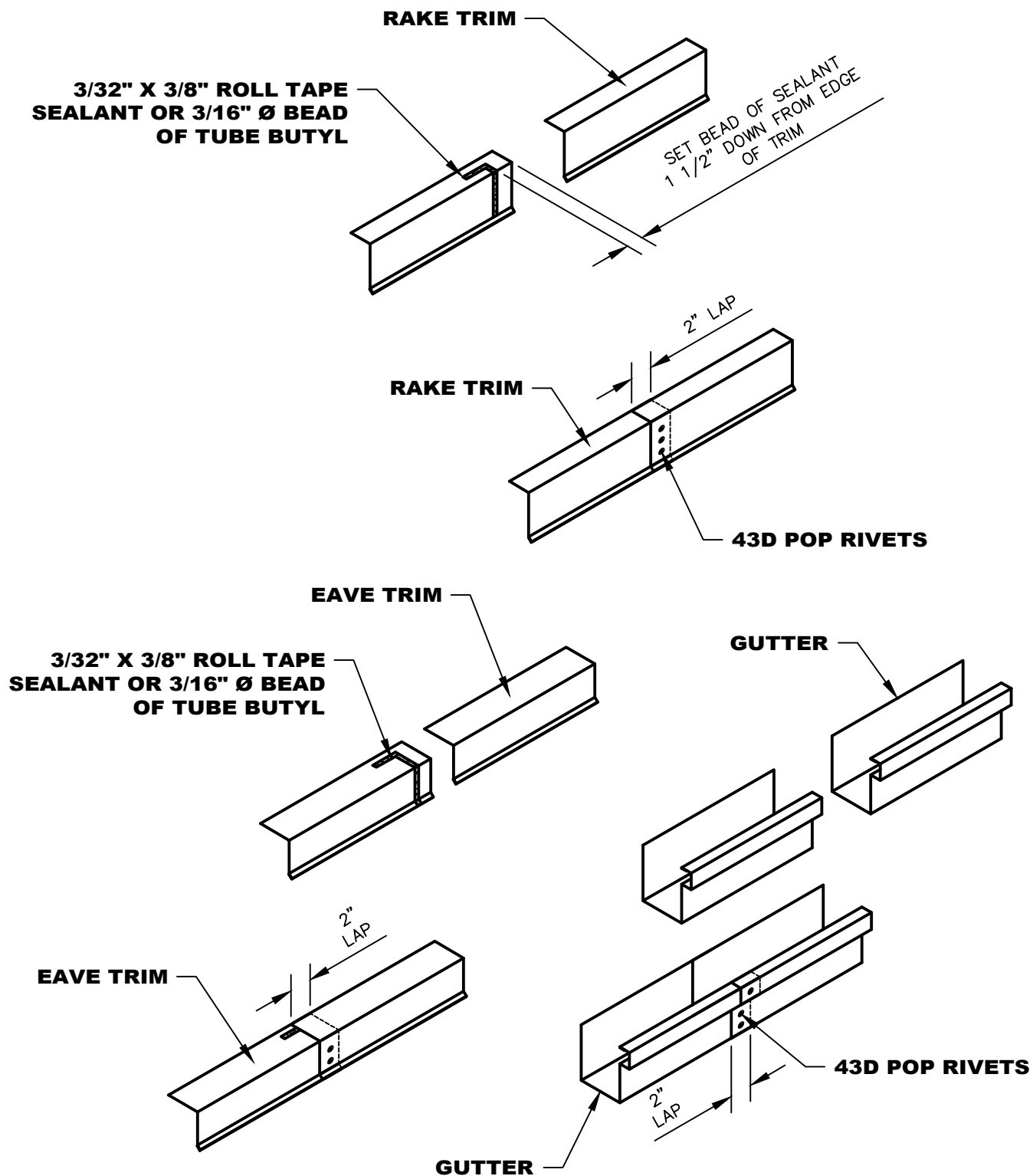

- NOTES:**
1. Apply 3/32 x 3/8" Roll Tape Sealant or a 3/16" bead of Tube Butyl 1 1/2" back from the edge of the trim. Also, apply a piece of tape sealant or bead of Tube Butyl as a Pigtail to completely seal joint.
  2. Notch the hems on the upper trim piece 2" so that the trim will fit flat in the lap joint.
  3. Secure trim laps with Pop Rivets as shown above.



☆ MANUFACTURING LOCATIONS ● SERVICE CENTERS ★ MANUFACTURING AND SERVICE CENTER



**CORPORATE OFFICE**  
1500 HAMILTON RD.  
BOSSIER CITY, LA 71111

## MANUFACTURING LOCATIONS

ADELANTO, CA	ASHBURN, GA	BOSSIER CITY, LA	CLINTON, IL	DIAMOND, MO
HOUSTON, TX	LEWISPORT, KY	LOCKHART, TX	MARSHALL, MI	MAUSTON, WI
MERKEL, TX	PEACHTREE CITY, GA	SUNNYVALE, TX	WINCHESTER, VA	

**McELROY METAL**  
**SERVICE**  
**CENTER**  
EMPLOYEE OWNED

17031 Koala Road Adelanto, CA 92301	5215 Leo St. Alexandria, LA 71301	1007 Wilso Dr, Baltimore, MD 21223	1500 Hamilton Rd. Bossier City, LA 71111
3052 Yadkin Road Chesapeake, VA 23323	9476 Meadowbrook Rd. Clinton, IL 61727	3215 Highway 59 Diamond, MO 64840	390 N. Valley Dell Dr. Fenton, MO 63026
409 Lovejoy Road Ft. Walton Beach, FL 32548	3014 Lincoln Court Garland, TX 75041	1440 Aldine Bender Road Houston, TX 77032	221 Benelli Drive Hutto, TX 78634
10504 E. 59th Street Indianapolis, IN 46236	32 Industrial Circle Lancaster, PA 17601	9435 US Hwy. 60 W. Lewisport, KY 42351	2701 Cahill Street Lockhart, TX 78644
1020 Veterans Street Mauston, WI 53948	5123 Terminal Dr. McFarland, WI 53558	514 Cave Road Nashville, TN 37210	8304 Hwy. 70 E. North Little Rock, AR 72117
613 North Bierdeman Rd. Pearl, MS 39208	8511 Industrial Drive Pearland, TX 77584	2755 Hwy 60 Pendergrass, GA 30567	7450 Tower Street Richland Hills, TX 76118
8200 Berry Ave. Suite 100 Sacramento, CA 95828	1365 Dean Forest Rd. Savannah, GA 31405	7355 Oakley Industrial Blvd. Union City, GA 30291	1144 Silstar Rd. West Columbia, SC 29170
325 McGhee Rd. Winchester, VA 22603			

Website: [www.mcelroymetal.com](http://www.mcelroymetal.com) • E-mail: [info@mcelroymetal.com](mailto:info@mcelroymetal.com)