

U-PANEL

INSTALLATION

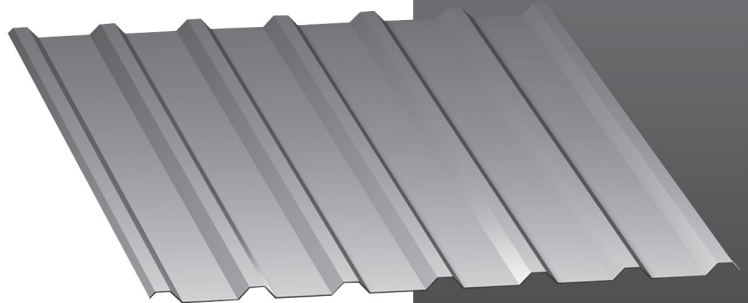

TABLE OF CONTENTS

PAGE NUMBER:	DETAIL DESCRIPTION
A-1.....	TABLE OF CONTENTS
A-2.....	GENERAL NOTES
B-1.....	FASTENER PATTERNS
C-1.....	SIMPLE BASE w/o CONCRETE NOTCH TRIM DETAIL
C-2.....	BASE TRIM DETAIL
C-3.....	SIMPLE BASE w/ CONCRETE NOTCH DETAIL
C-4.....	WALL PANEL TO GIRT DETAIL
C-5.....	OUTSIDE CORNER DETAIL
C-6.....	INSIDE CORNER DETAIL
C-7.....	HEAD TRIM DETAIL
C-8.....	JAMB TRIM DETAIL
C-9.....	EAVE DETAIL
C-10.....	EAVE w/ GUTTER DETAIL
C-11.....	ROOF PANEL LAP DETAIL
C-12.....	INTERMEDIATE PURLIN DETAIL
C-13.....	RIDGE DETAIL
C-14.....	RAKE DETAIL
C-15.....	RAKE TIE-IN DETAIL
C-16.....	HIGH SIDE EAVE DETAIL
C-17.....	HIGH SIDE TIE-IN DETAIL
C-18.....	MASONRY WAINSCOAT DETAIL
C-19.....	DIE-FORMED RIDGE CAP DETAIL
C-20.....	TYPICAL TRIM LAP DETAILS

GENERAL NOTES

The details shown on the following pages are suggestions or guidelines for installing the U-Panel wall and roof panel system. The installation details shown here are proven methods of construction, but they are not intended to cover all building requirements, designs or codes. The details may require changes or revisions due to individual project conditions.

Installation procedures shall be in accordance with the manufacturer's printed instructions, details or approved shop drawings. Installers should thoroughly familiarized themselves with all instructions prior to beginning the installation process.

The designer/installer is responsible to ensure the following:

That the details here meet the particular building requirements.

That adequate water tightness is maintained.

That a proper uniform substructure is used to avoid panel distortion and that the substructure meets necessary code requirements.

That all supporting members have been examined and are straight, level and plumb.

McElroy Metal can provide all flashings and accessories shown in the installation drawings unless noted otherwise. Panels, flashing and trim shall be installed true and in proper alignment with any exposed fasteners equally spaced for the best appearance. Sealant shall be field applied on a clean, dry surface.

Some field cutting and fitting of panels and flashings is to be expected and to be considered a part of normal installation work. Workmanship shall be of the best industry standards and with installation performed by experienced metal craftsmen.

Oil canning of metal panels is inherent in the product and is not a cause for rejection.

Contents of this manual are subject to change without notice. To confirm this book is the most current copy, please visit McElroy Metal's website at www.mcelroymetal.com.

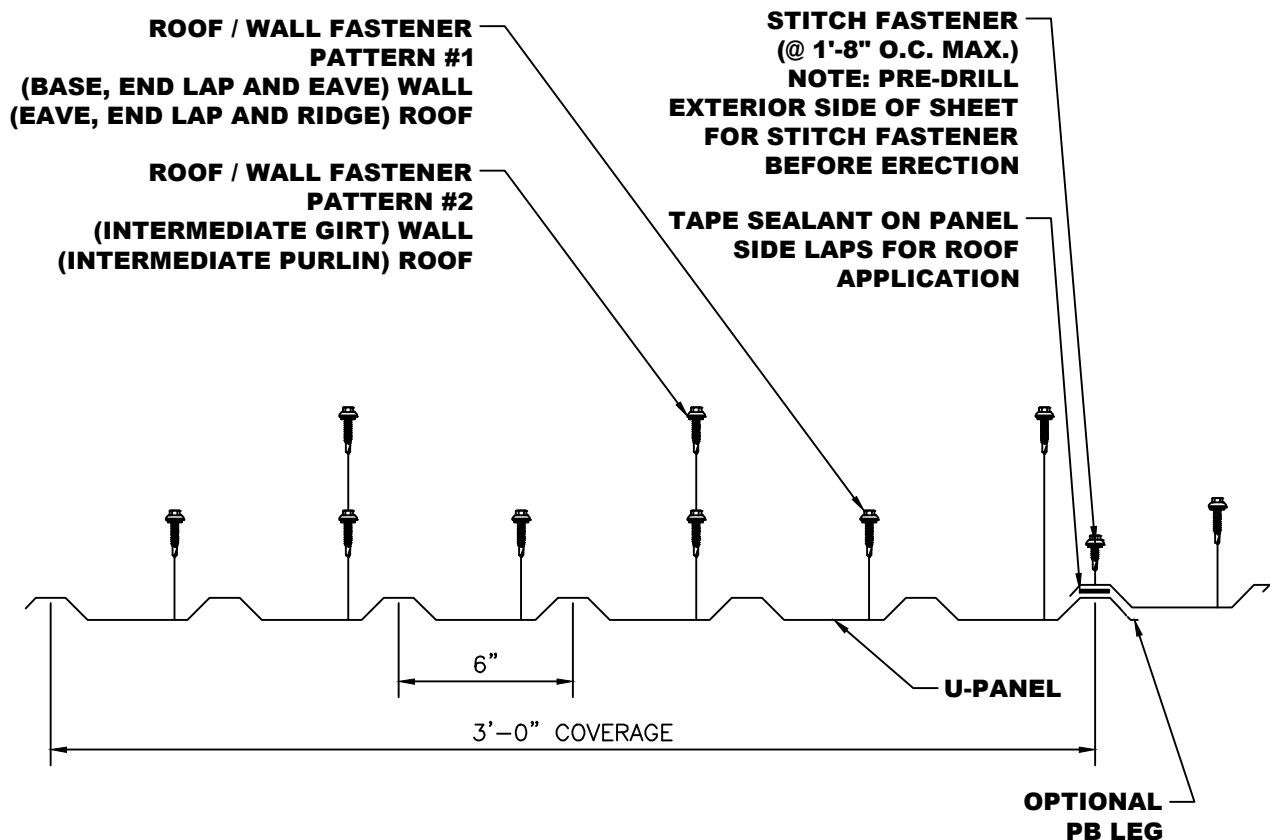
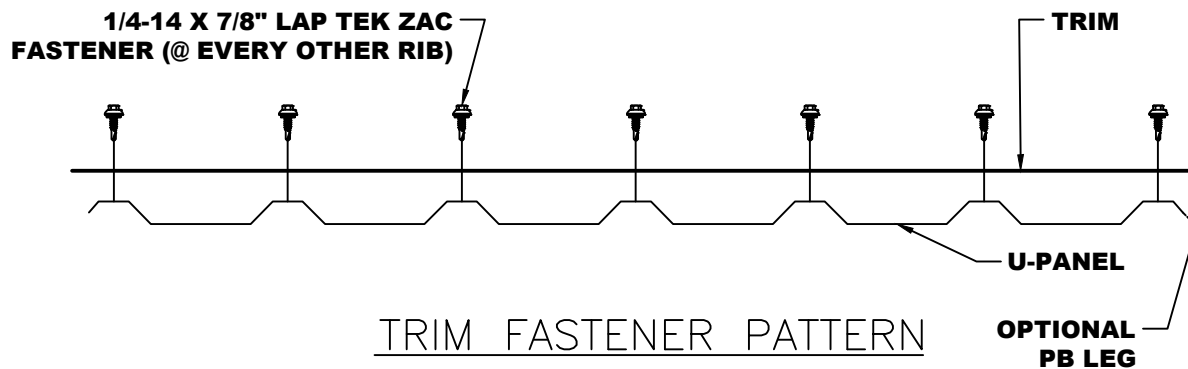

PANEL FRAMING AND STITCH FASTENER PATTERNS

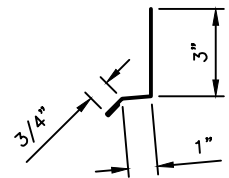
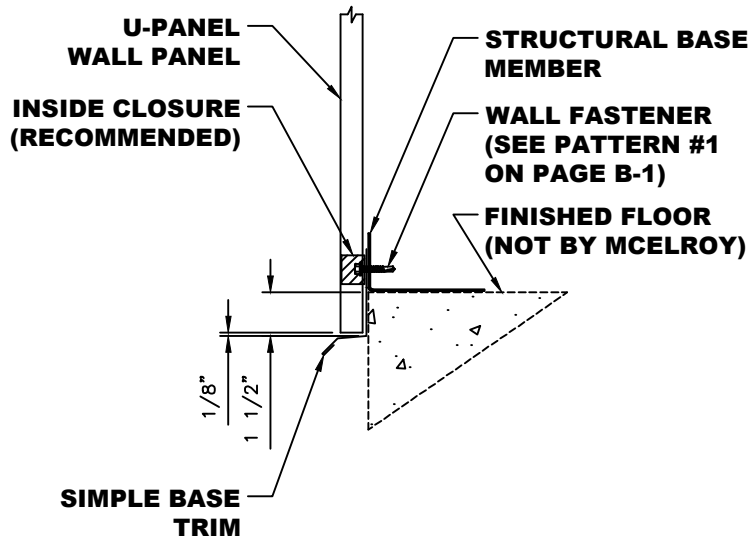

SIMPLE BASE TRIM

- NOTES:**
1. Structural Base Member set flush with edge of Finished Floor.
 2. Set Simple Base Trim 1 1/2" down face of finished floor.
 3. Set Closure in position on Simple Base Trim.
 4. Set U-Panel Wall Panel into place. Make sure to leave a 1/8" gap between trim and panel.
 5. Attach panel with Wall Fasteners per Fastening Pattern #1 shown on page B-1.

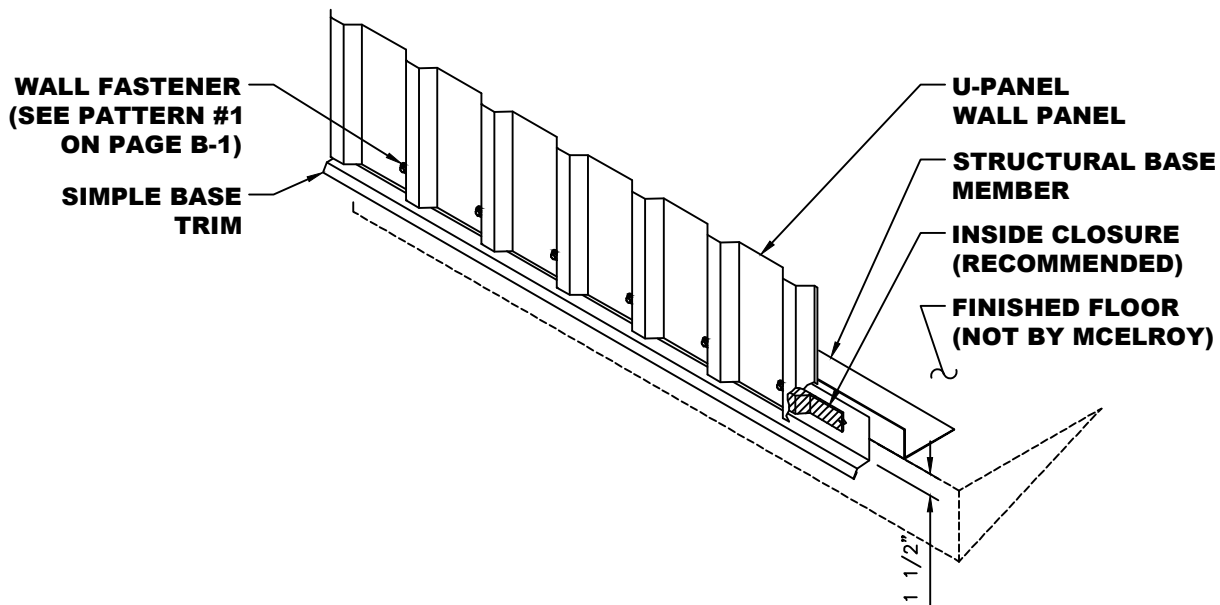

*NOTE: SOME TRIM ITEMS AND FASTENERS HAVE BEEN REMOVED FOR CLARITY OF ISOMETRIC DETAIL.

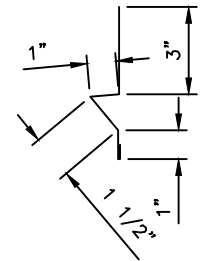
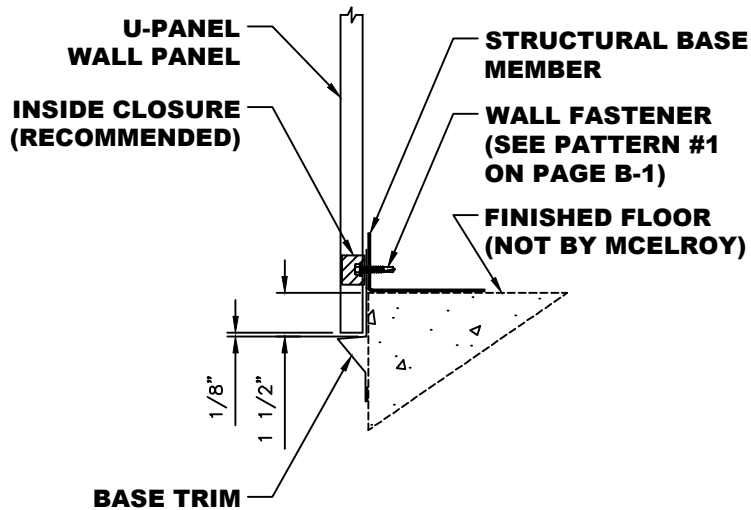

BASE TRIM

- NOTES:**
1. Structural Base Member set flush with edge of Finished Floor.
 2. Set Base Trim 1 1/2" down face of finished floor.
 3. Set Closure in position on Base Trim.
 4. U-Panel Wall Panel into place. Make sure to leave a 1/8" gap between trim and panel.
 5. Attach panel with Wall Fasteners per Fastening Pattern #1 shown on page B-1.

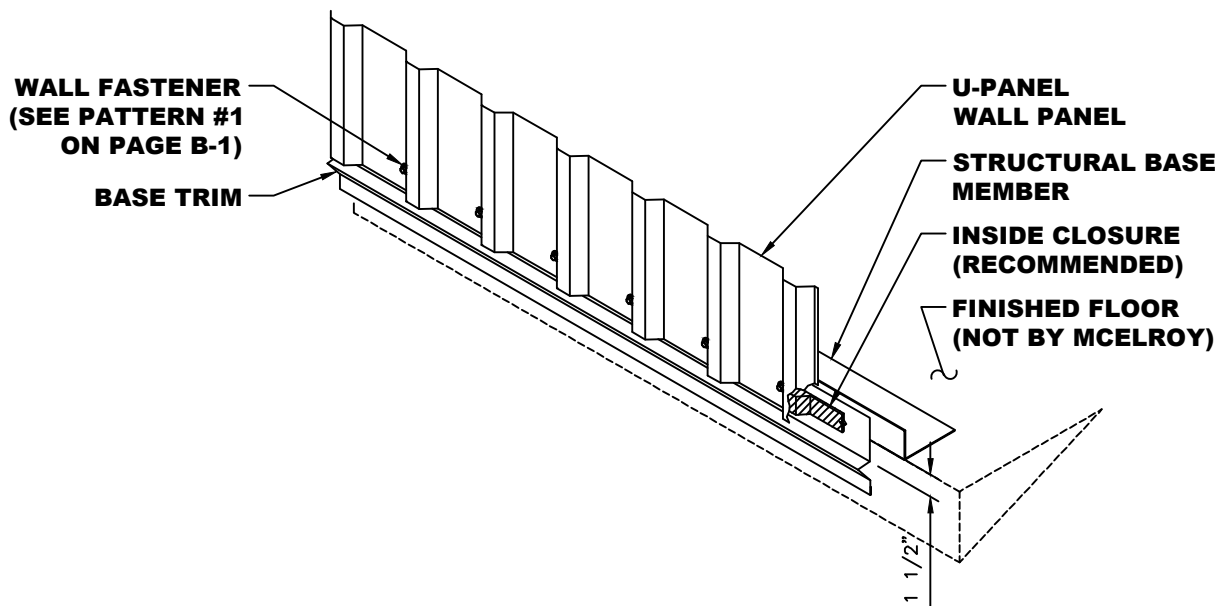

*NOTE: SOME TRIM ITEMS AND FASTENERS HAVE BEEN REMOVED FOR CLARITY OF ISOMETRIC DETAIL.

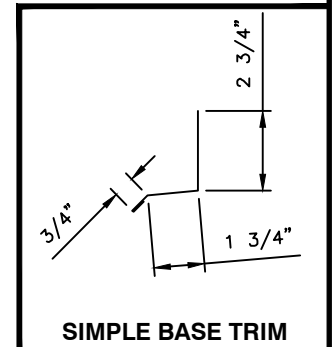
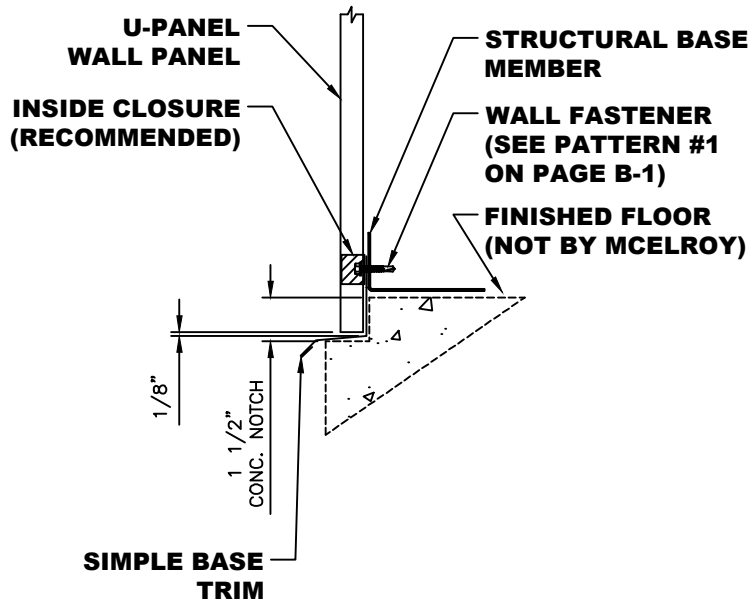

- NOTES:**
1. Structural Base Member set flush with edge of Finished Floor.
 2. Set Simple Base Trim into concrete notch of slab.
 3. Set Closure in position on Simple Base Trim.
 4. Set U-Panel Wall Panel into place. Make sure to leave a 1/8" gap between trim and panel.
 5. Attach panel with Wall Fasteners per Fastening Pattern #1 shown on page B-1.

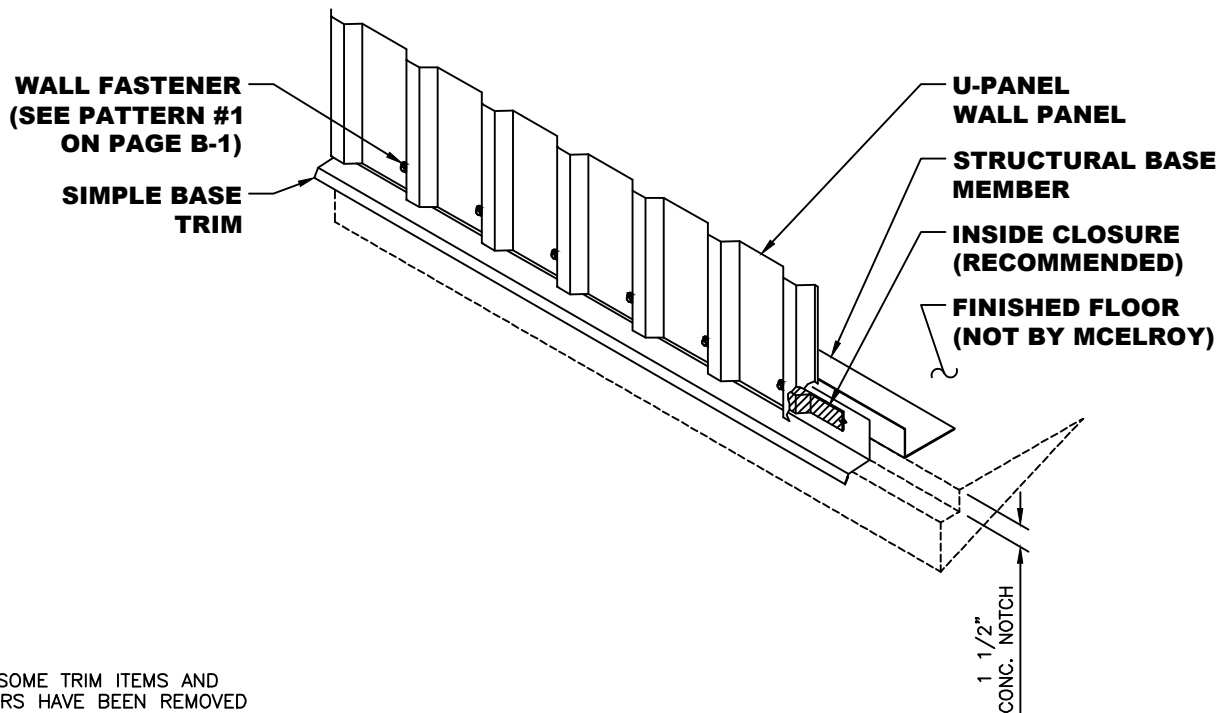

*NOTE: SOME TRIM ITEMS AND FASTENERS HAVE BEEN REMOVED FOR CLARITY OF ISOMETRIC DETAIL.

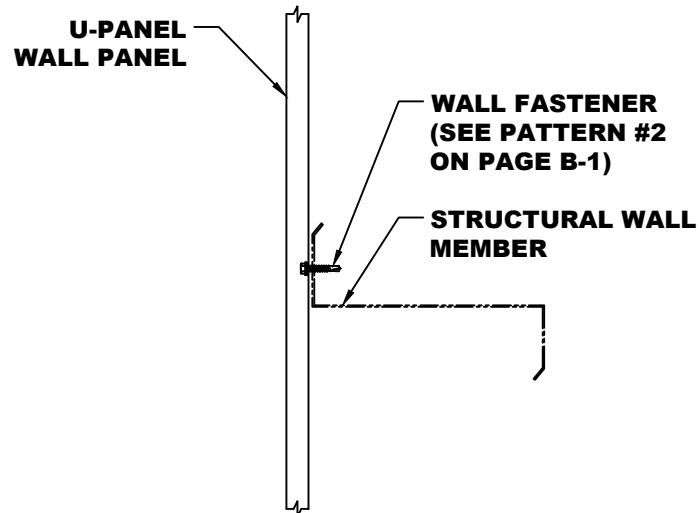

NOTES: 1. Attach U-Panel Wall panel to Structural Wall Member with Wall Fasteners using Fastener Pattern #2 as shown on page B-1.

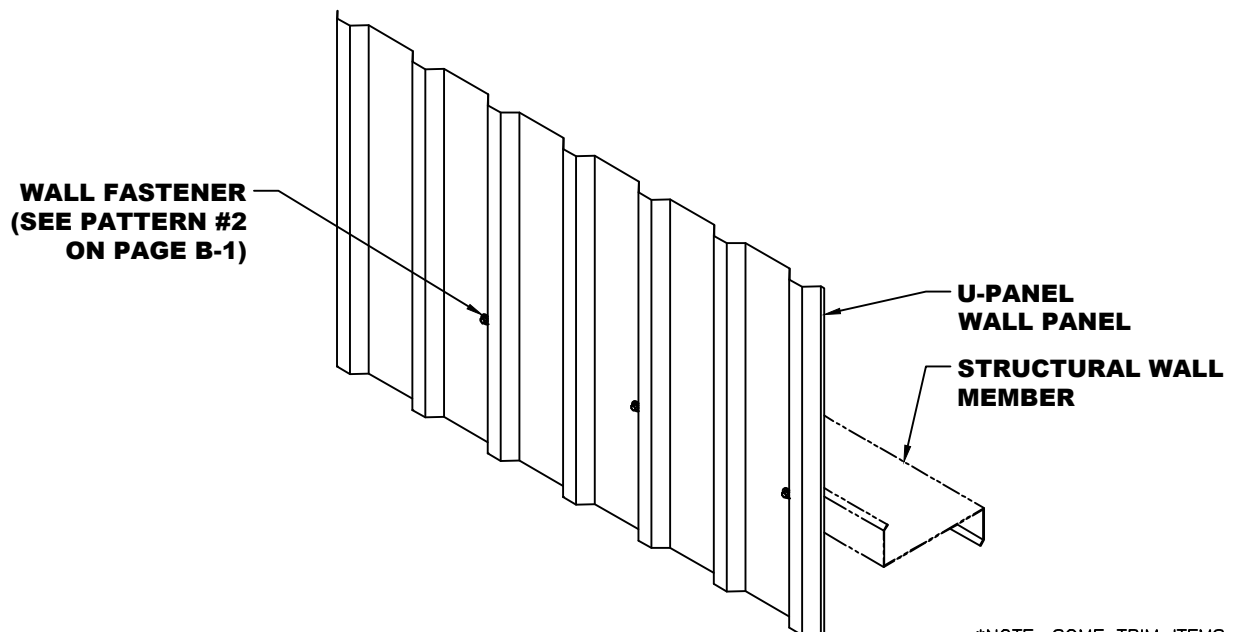

*NOTE: SOME TRIM ITEMS AND FASTENERS HAVE BEEN REMOVED FOR CLARITY OF ISOMETRIC DETAIL.

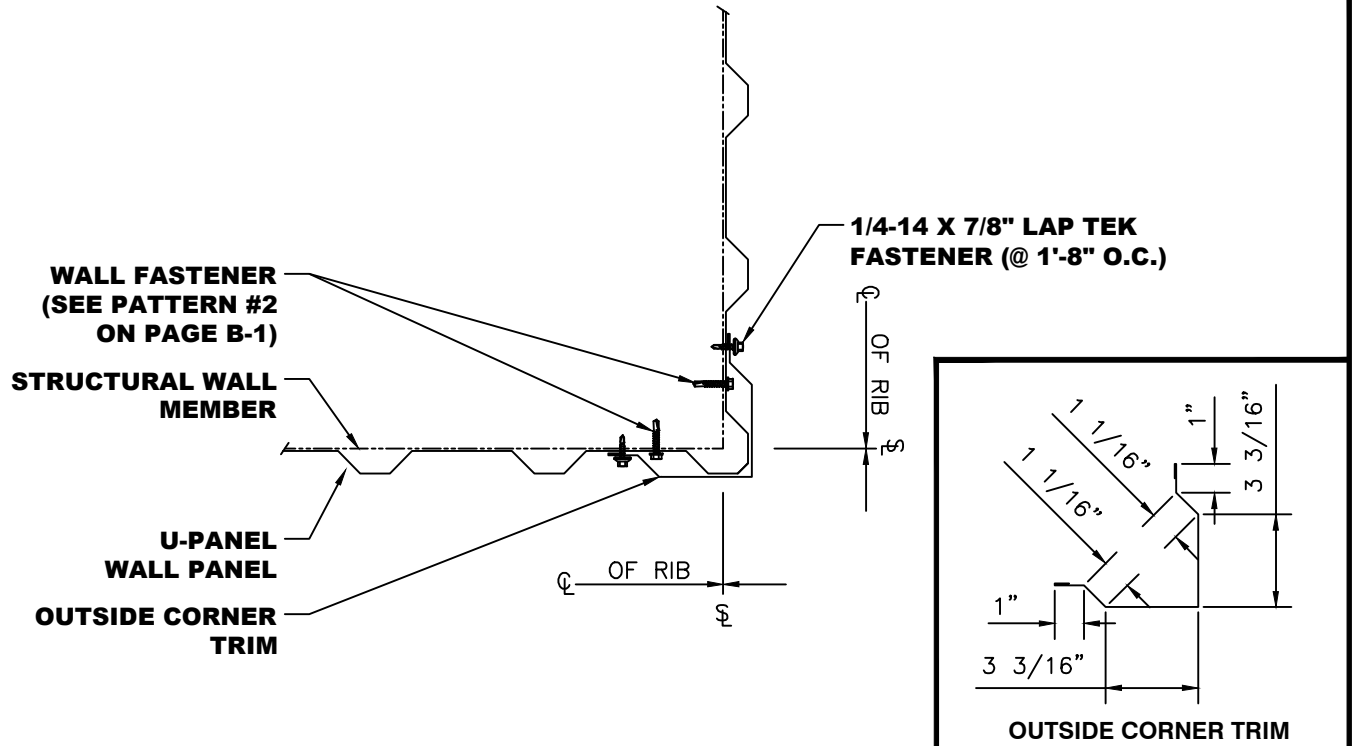

NOTES: 1. Attach U-Panel Wall panel to Wall Structural Member with Wall Fasteners using Fastener Pattern #2 as shown on page B-1.

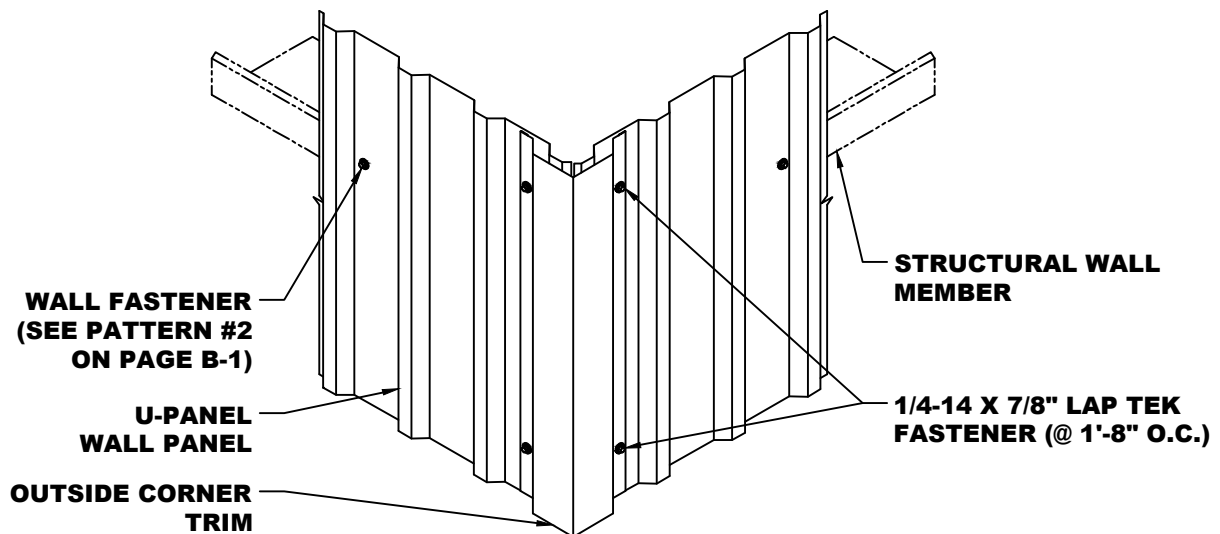

*NOTE: SOME TRIM ITEMS AND FASTENERS HAVE BEEN REMOVED FOR CLARITY OF ISOMETRIC DETAIL.

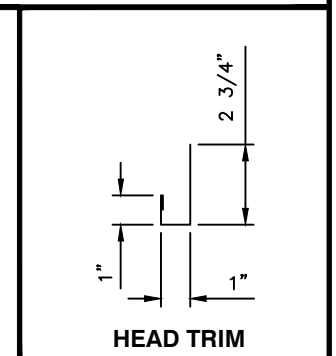
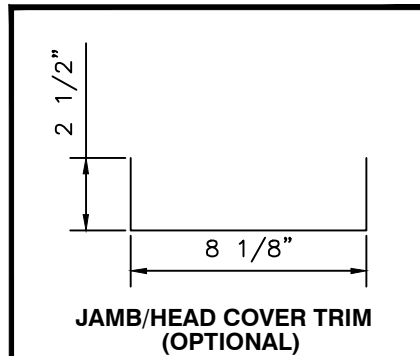
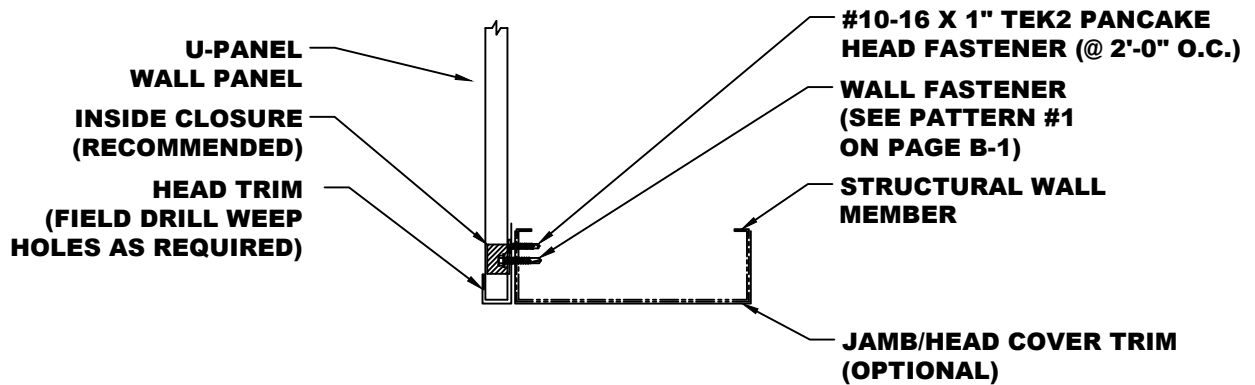

- NOTES:** 1. Attach Head Trim to Header using #10-16 x 1" TEK2 Pancake Head Fasteners every 2'-0" O.C.
 2. Set Inside Closure in position on Head Trim.
 3. Install U-Panel to Structural Wall Member with Wall Fasteners using Fastener. Pattern #1 on page B-1.

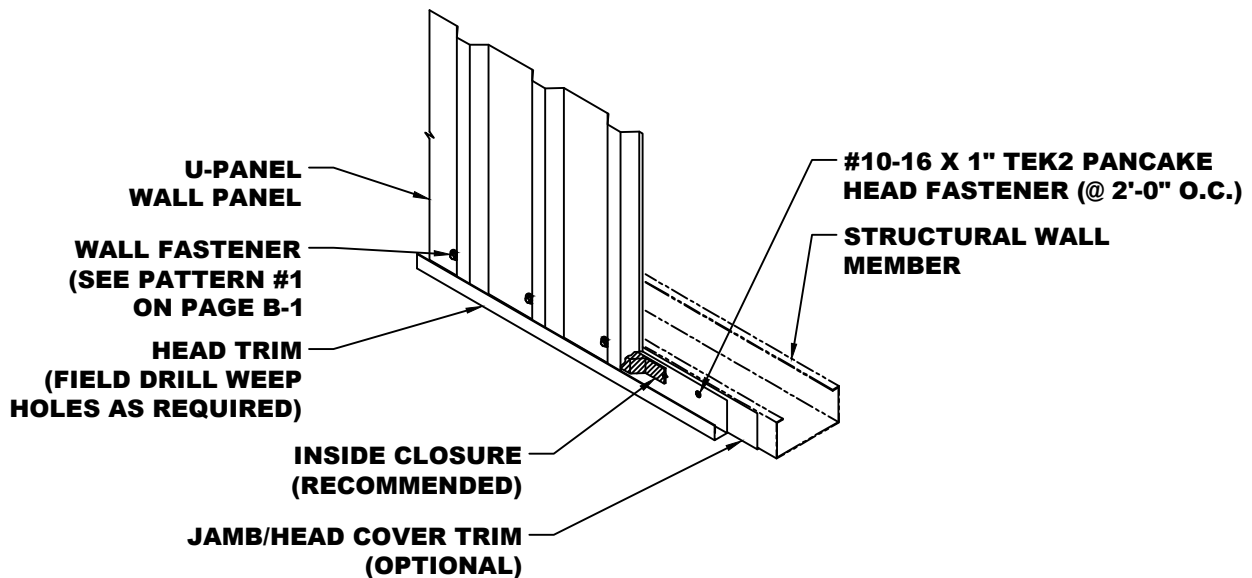

*NOTE: SOME TRIM ITEMS AND FASTENERS HAVE BEEN REMOVED FOR CLARITY OF ISOMETRIC DETAIL.

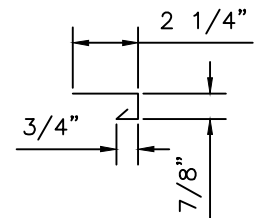
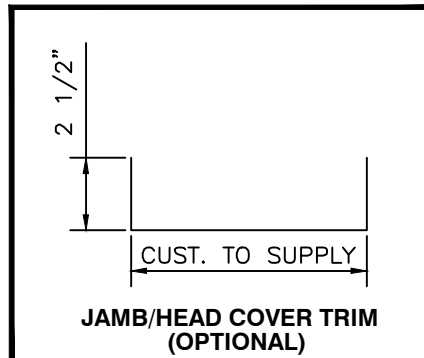
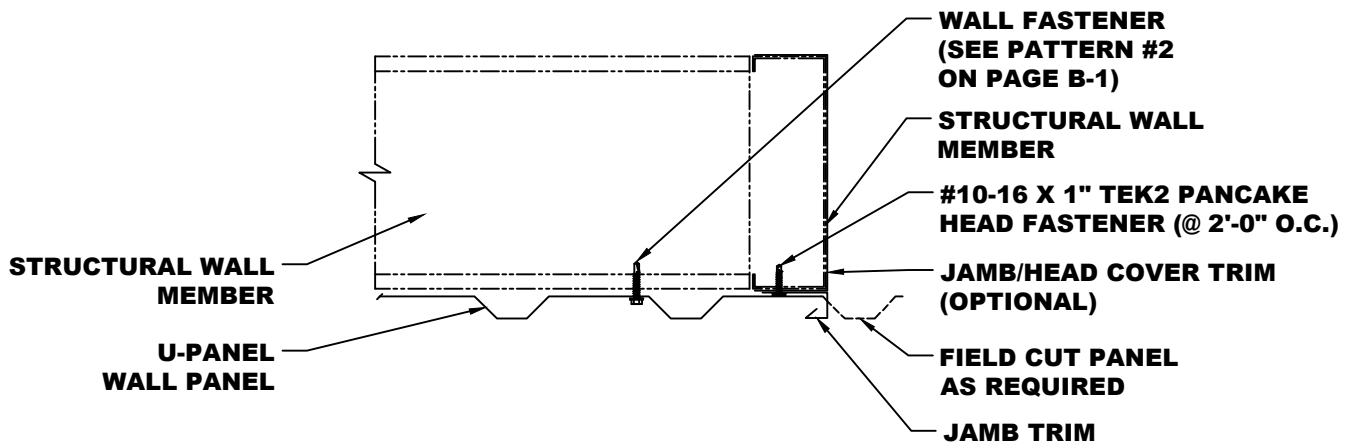

- NOTES:**
1. Attach Jamb Trim to Structural Wall Member using #10-16 x 1" TEK2 Pancake Head Fasteners every 2'-0" O.C.
 2. Install U-Panel to Structural Wall Member with Wall Fasteners using Fastener Pattern #2 on page B-1.

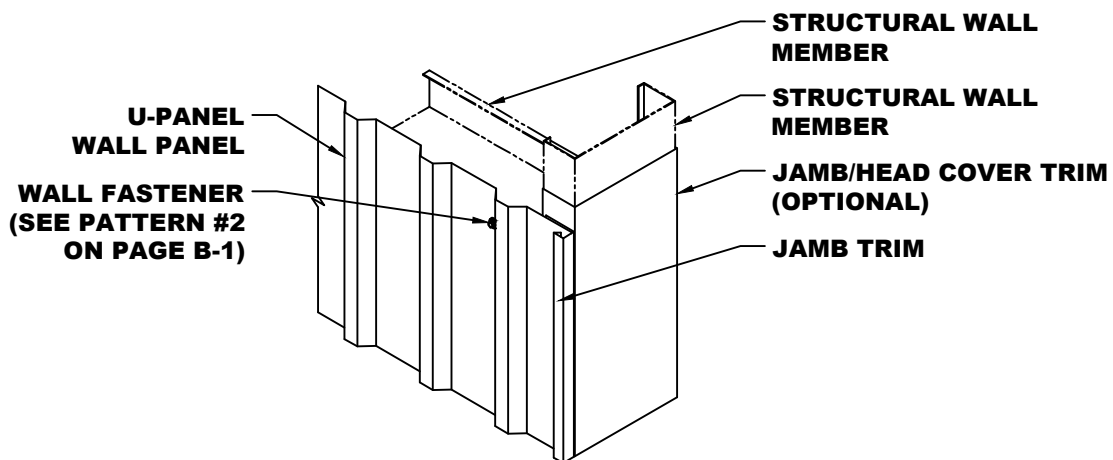

*NOTE: SOME TRIM ITEMS AND FASTENERS HAVE BEEN REMOVED FOR CLARITY OF ISOMETRIC DETAIL.

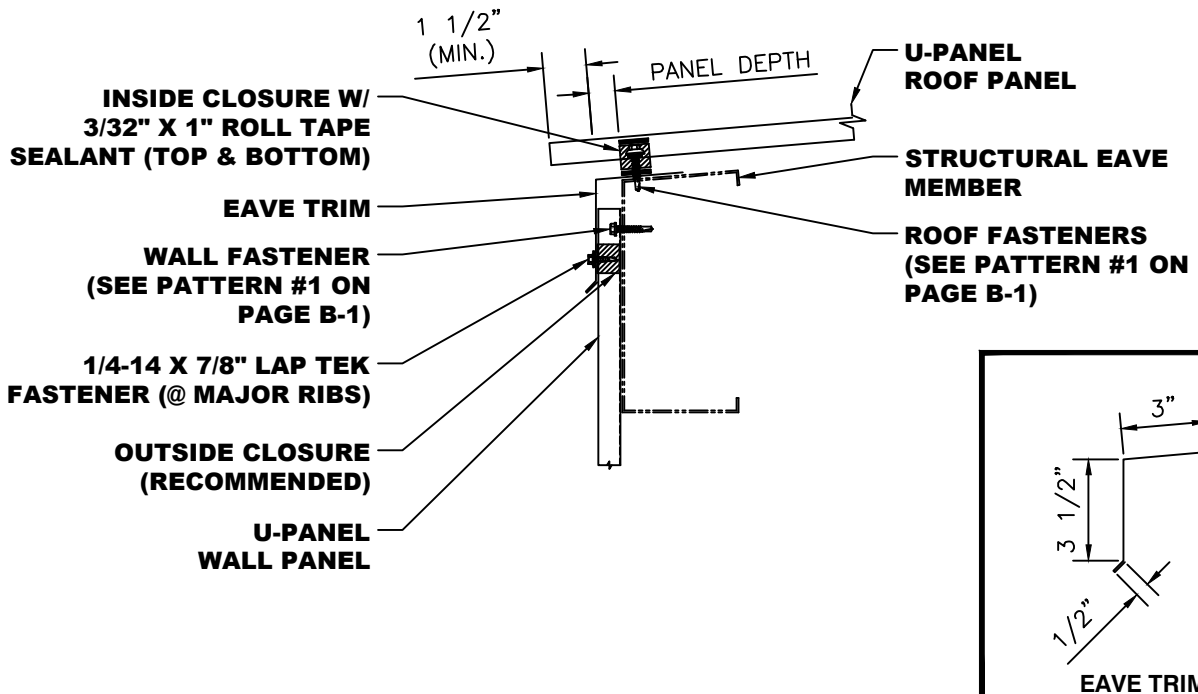

- NOTES:**
1. Attach Wall Panel to Structural Eave Member with Framing Fasteners using Fastener Pattern #1 on page B-1.
 2. Eave Trim to run from out of wall to out of wall.
 3. Trim pieces lap 2". Apply 3/32" x 3/8" Butyl Tape Sealant in trim laps and Pop Rivet trims as shown on page C-18.
 4. Attach Eave Trim to Wall Panel at major ribs with 1/4-14 x 7/8" Lap Tek Fasteners.
 5. Apply continuous run of 1" Butyl Tape Sealant on top of Eave Trim.
 6. Set Closures in tape and apply another continuous run of 1" Butyl Tape Sealant on top of closures.
 7. Attach U-Panel Roof Panels in place with Roof Fasteners. See Fastener Pattern #1 on page B-1.

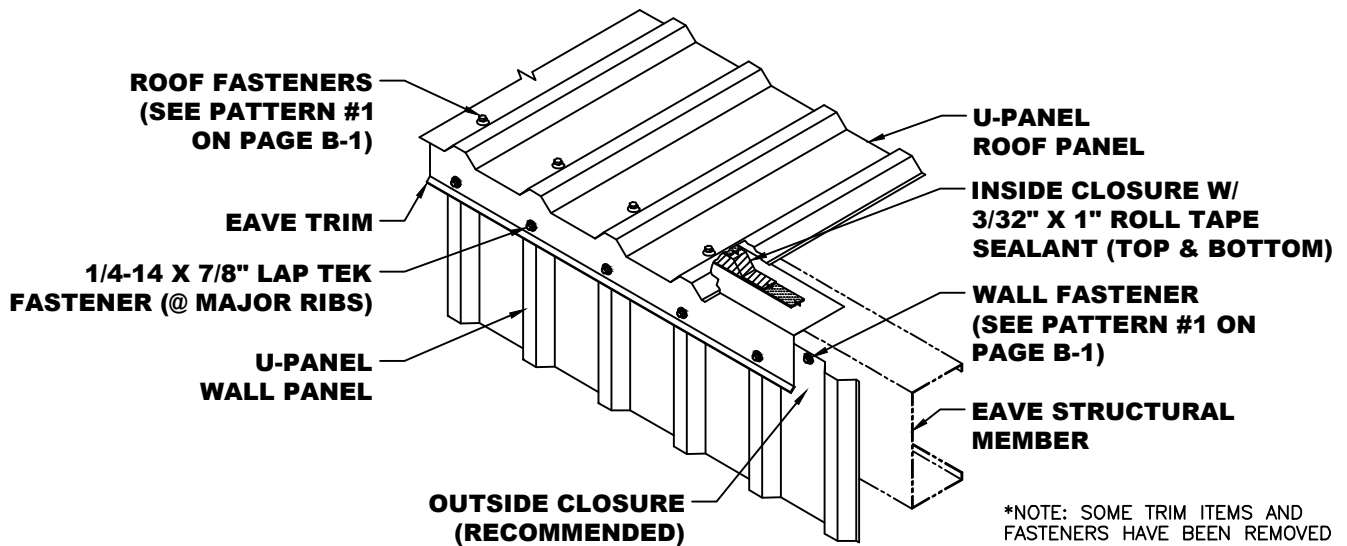

*NOTE: SOME TRIM ITEMS AND FASTENERS HAVE BEEN REMOVED FOR CLARITY OF ISOMETRIC DETAIL.

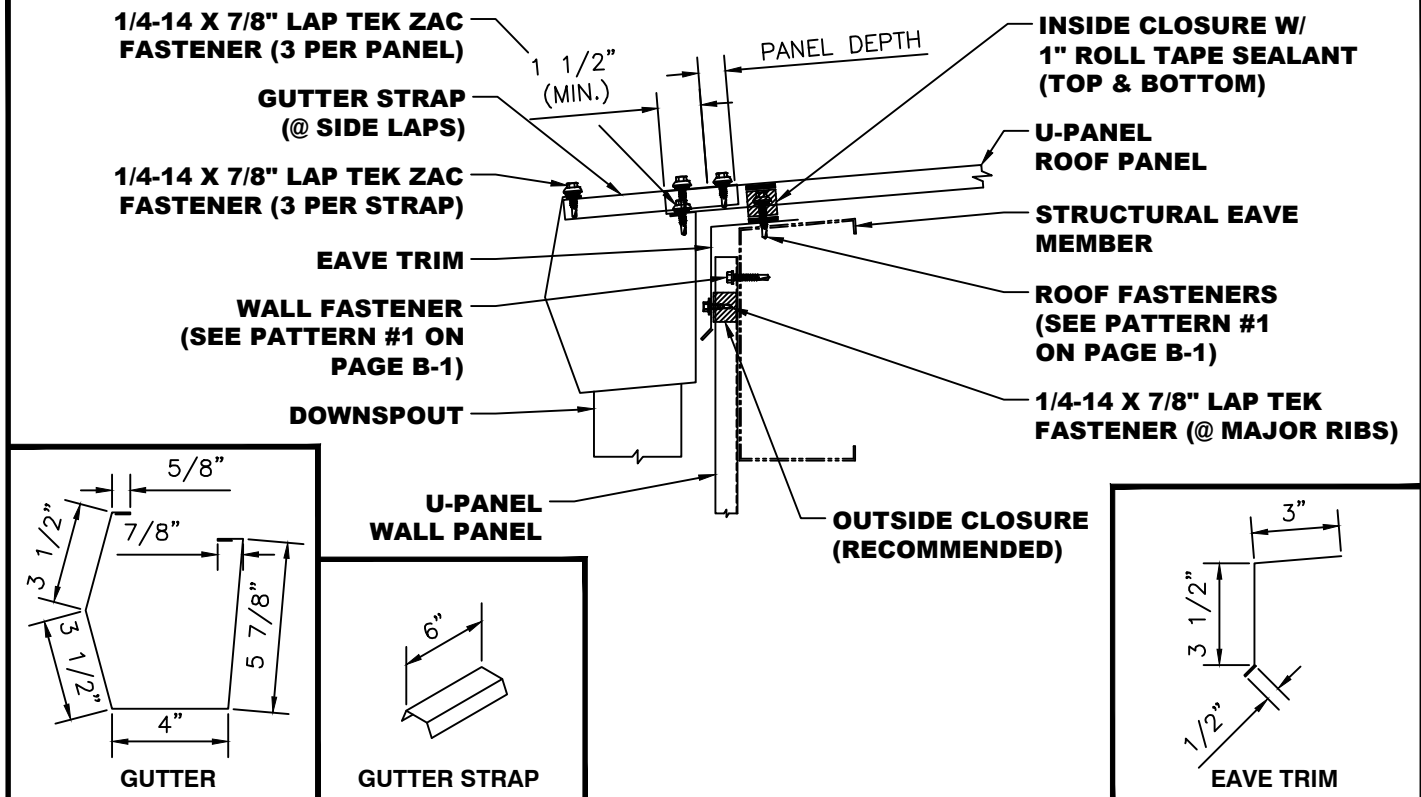

- NOTES:**
1. Attach U-Panel Wall Panel to Structural Eave Member with Wall Fasteners using Fastener Pattern #1 on page B-1.
 2. Eave Trim and Gutter to run from out of wall to out of wall.
 3. Trim pieces lap 2". Apply 3/32" x 3/8" Butyl Tape or Butyl Tube Sealant at trim laps and Pop Rivet trims as shown on page C-18.
 4. Attach Eave Trim to wall panels at major ribs with 1/4-14 x 7/8" Lap Tek fasteners.
 5. Apply continuous run of 1" Roll Tape Sealant on top of Eave Trim.
 6. Set Inside Closures in tape and apply another continuous run of 1" Roll Tape Sealant on top of closures.
 7. Attach U-Panel Roof Panels with Roof Fasteners. See Fastener Pattern #1 on page B-1.
 8. Attach Gutter to roof panels with 1/4-14 x 7/8" Lap Tek ZAC Fasteners. (3 per panel) Attach Gutter Straps to panel ribs with (2) 1/4-14 x 7/8" Lap Tek ZAC Fastener. Then attach Gutter to Gutter Strap with (1) 1/4-14 x 7/8" Lap Tek ZAC Fasteners.

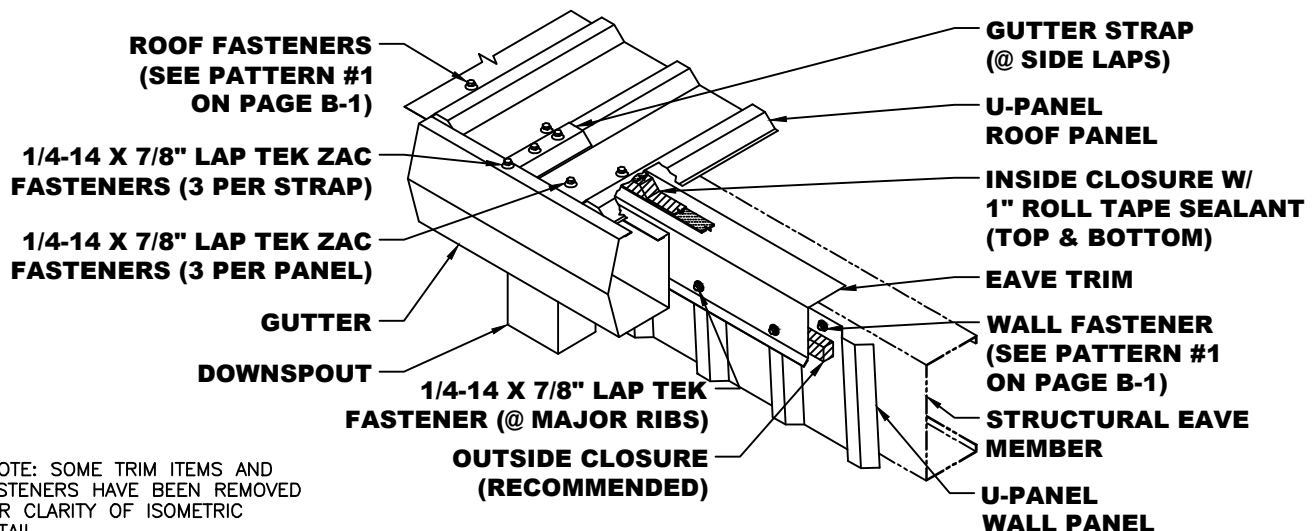

*NOTE: SOME TRIM ITEMS AND FASTENERS HAVE BEEN REMOVED FOR CLARITY OF ISOMETRIC DETAIL.

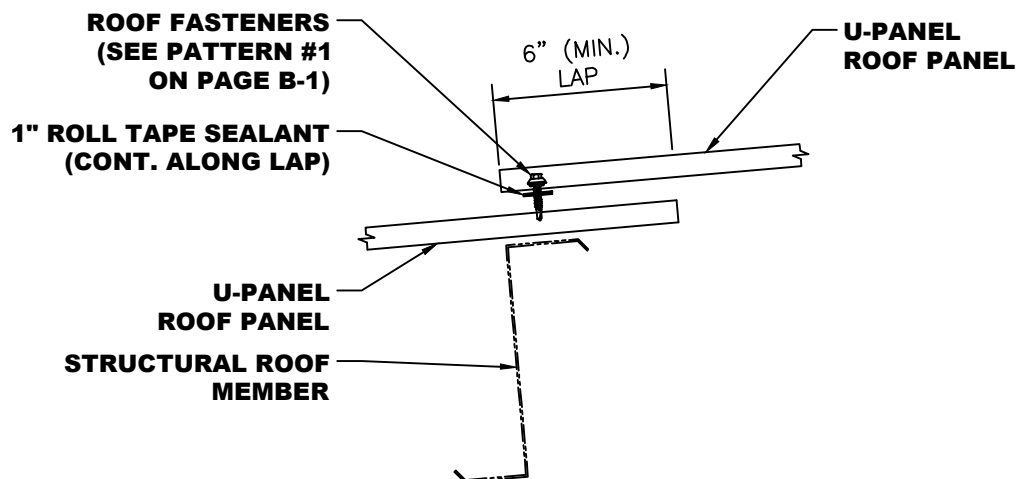

- NOTES:**
1. Extend lower U-Panel Roof Panel 6" past web of Roof Structural Member.
 2. Apply continuous run of 1" Roll Tape Sealant on top of lower U-Panel panel 5 3/4" down from end of panel.
 3. Install upper U-Panel panel and fasten with Roof Fasteners. See Fastener Pattern #1 on page B-1

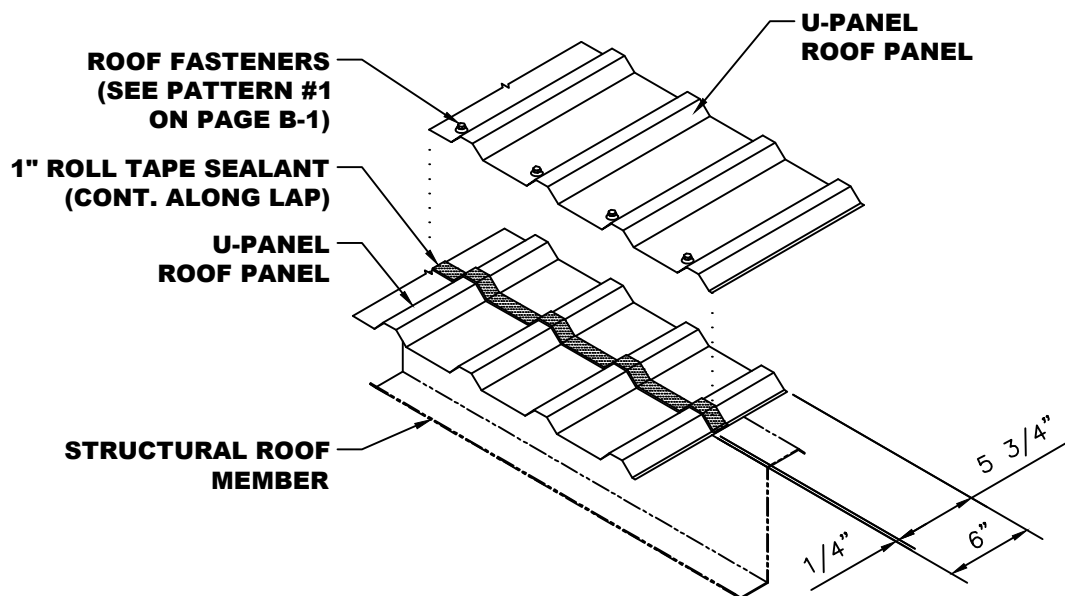

*NOTE: SOME TRIM ITEMS AND FASTENERS HAVE BEEN REMOVED FOR CLARITY OF ISOMETRIC DETAIL.

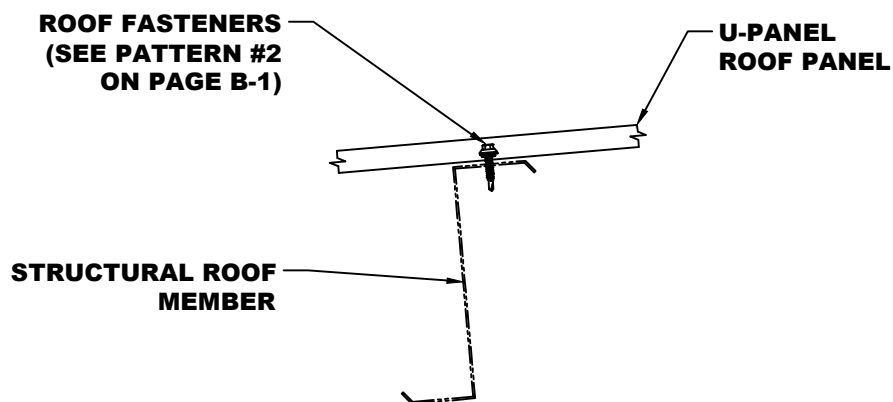

NOTES: 1. Attach U-Panel Roof Panels with Roof Fasteners. See Fastener Pattern #2 on page B-1.

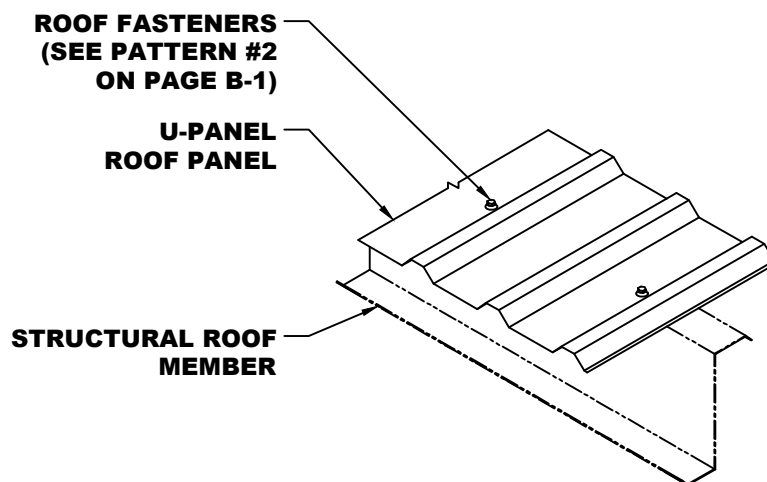

*NOTE: SOME TRIM ITEMS AND FASTENERS HAVE BEEN REMOVED FOR CLARITY OF ISOMETRIC DETAIL.

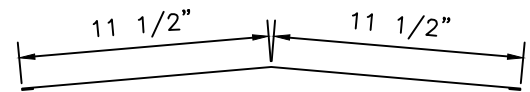
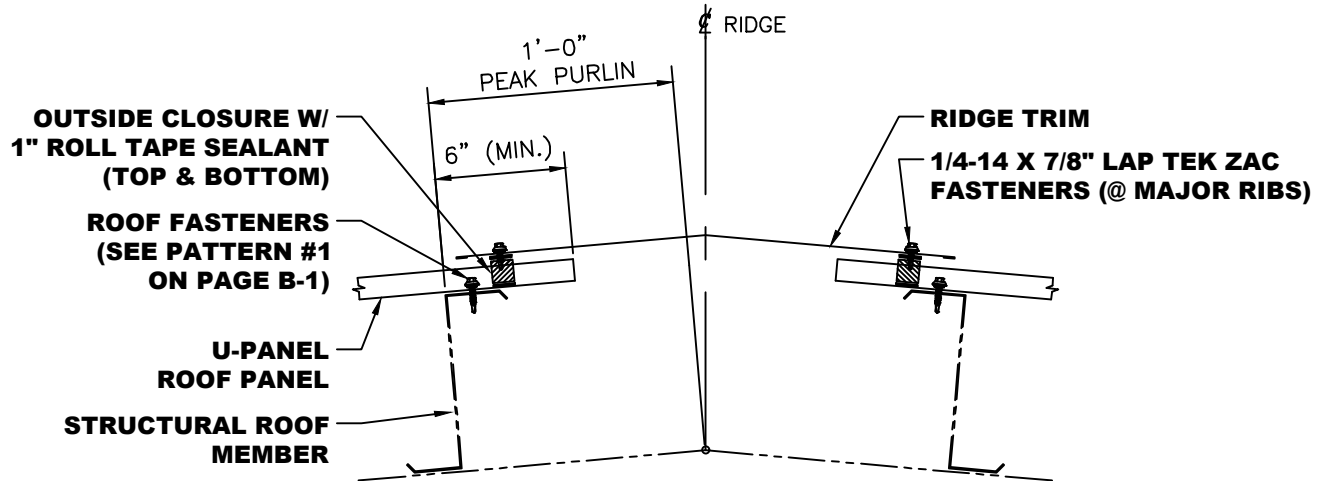

RIDGE TRIM

- NOTES:**
1. Attach U-Panel Roof Panels with Roof Fasteners. See Fastener Pattern #1 on page B-1.
 2. Install a continuous line of 1" Butyl Tape Sealant above fasteners. Seat Outside Closures in tape sealant. Install another continuous line of 1" Tape Sealant on top of closures.
 3. Attach Ridge Trim to roof panels with 1/4-14 x 7/8" Lap Tek ZAC Fasteners at major ribs. Make sure fastener penetrates sealant.
 4. Trim pieces lap 2". Apply 3/32" x 3/8" Butyl Tape or Butyl Tube Sealant at trim laps and secure trim joint with 1/4-14 x 7/8" Lap Tek ZAC Fasteners at 4" O.C.

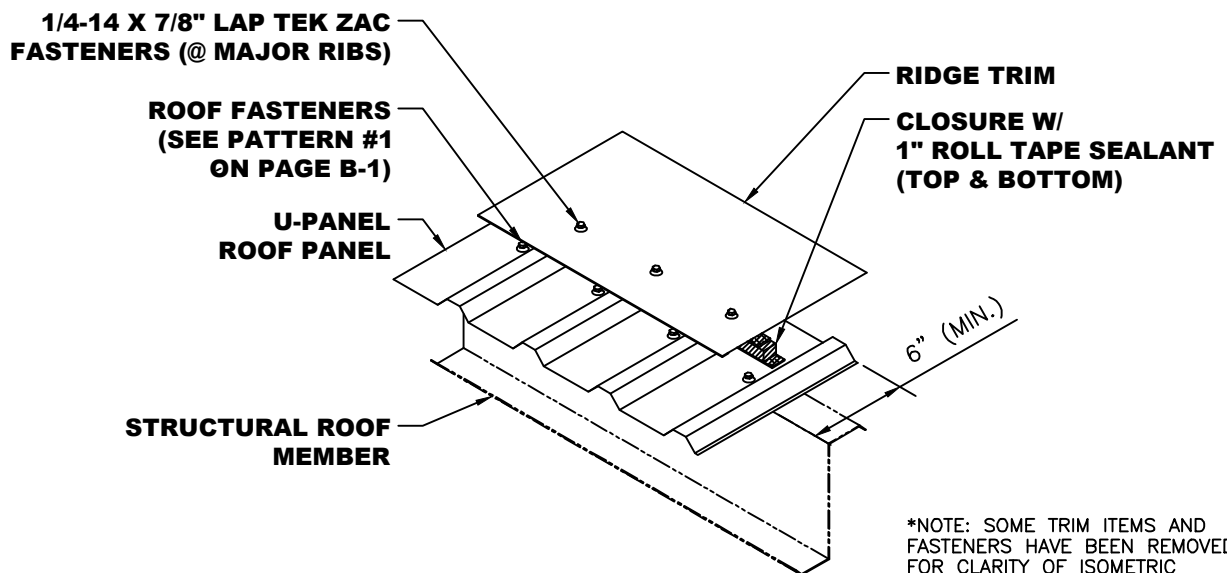

*NOTE: SOME TRIM ITEMS AND FASTENERS HAVE BEEN REMOVED FOR CLARITY OF ISOMETRIC DETAIL.

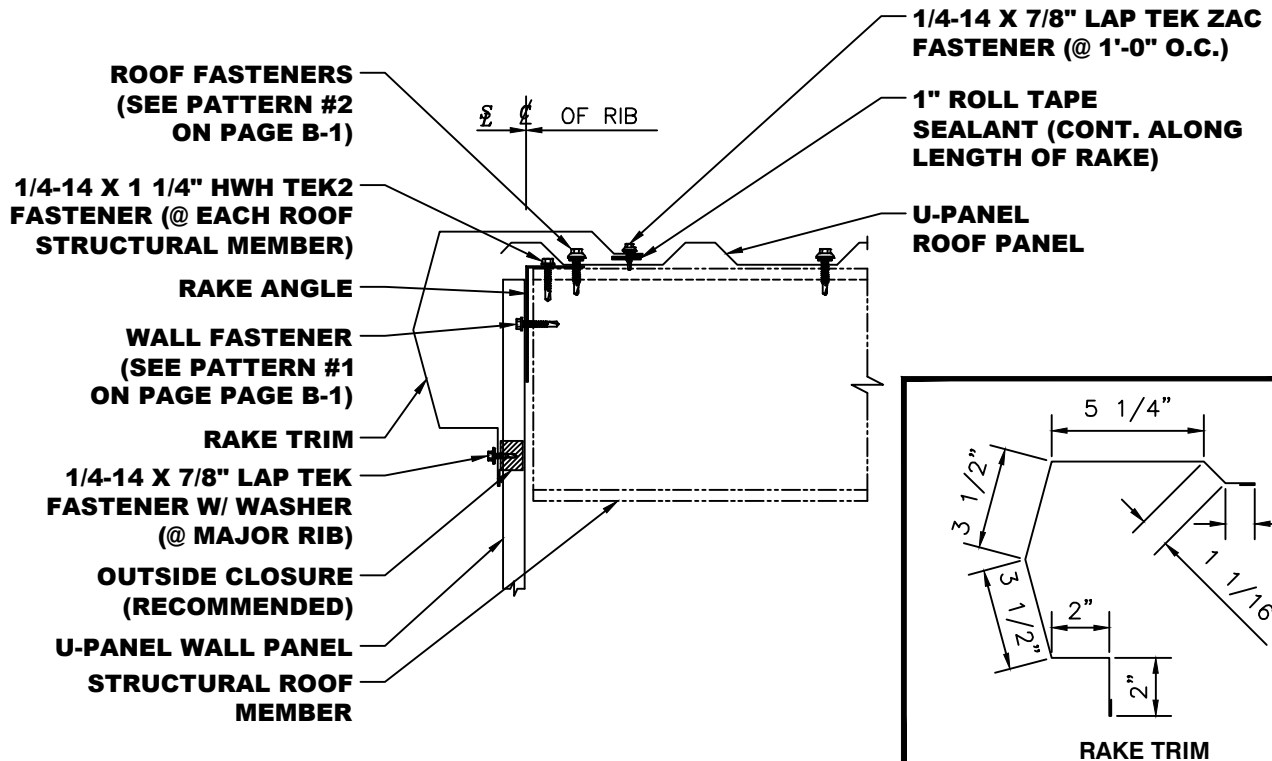

- NOTES:**
1. Attach U-Panel Wall Panel to Rake Angle with Wall Fasteners using Fastener Pattern #1 on page B-1.
 2. Attach U-Panel Roof Panels in place with Roof Fasteners. See Fastener Pattern #2 on page B-1.
 3. Install a continuous line of 1" Butyl Tape Sealant where Rake Trim rest on roof panel.
 4. Attach Rake Trim to roof panels with 1/4-14 x 7/8" Lap Tek ZAC Fasteners at 1'-0" O.C. Make sure fastener penetrates sealant.
 5. Attach Rake Trim to Wall Panels with 1/4-14 x 7/8" Lap Tek Fasteners with Washer at major ribs.
 6. Trim pieces lap 2". Apply 3/32" x 3/8" Butyl Tape or Butyl Tube Sealant at trim laps and secure trim joint with 1/4-14 x 7/8" Lap Tek ZAC Fasteners at 4" O.C.

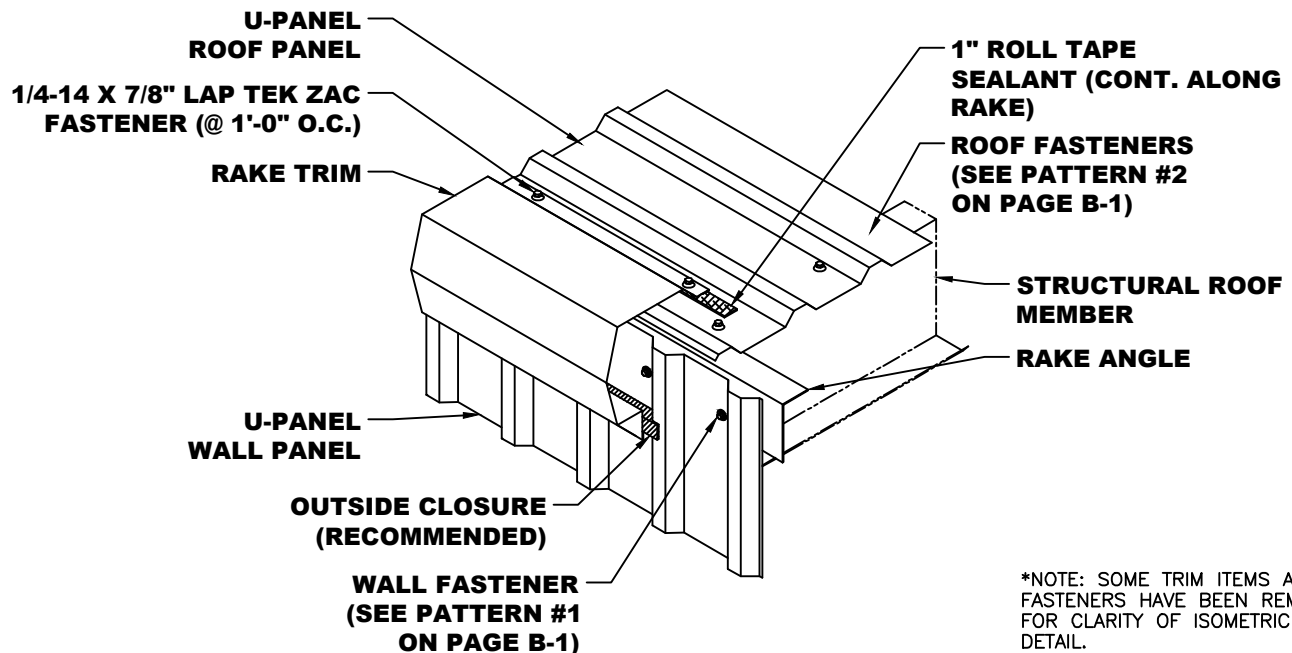

*NOTE: SOME TRIM ITEMS AND FASTENERS HAVE BEEN REMOVED FOR CLARITY OF ISOMETRIC DETAIL.

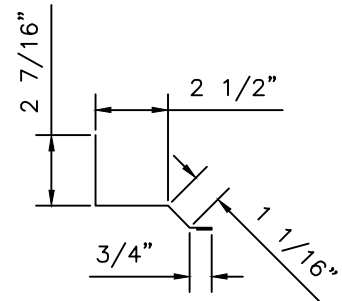
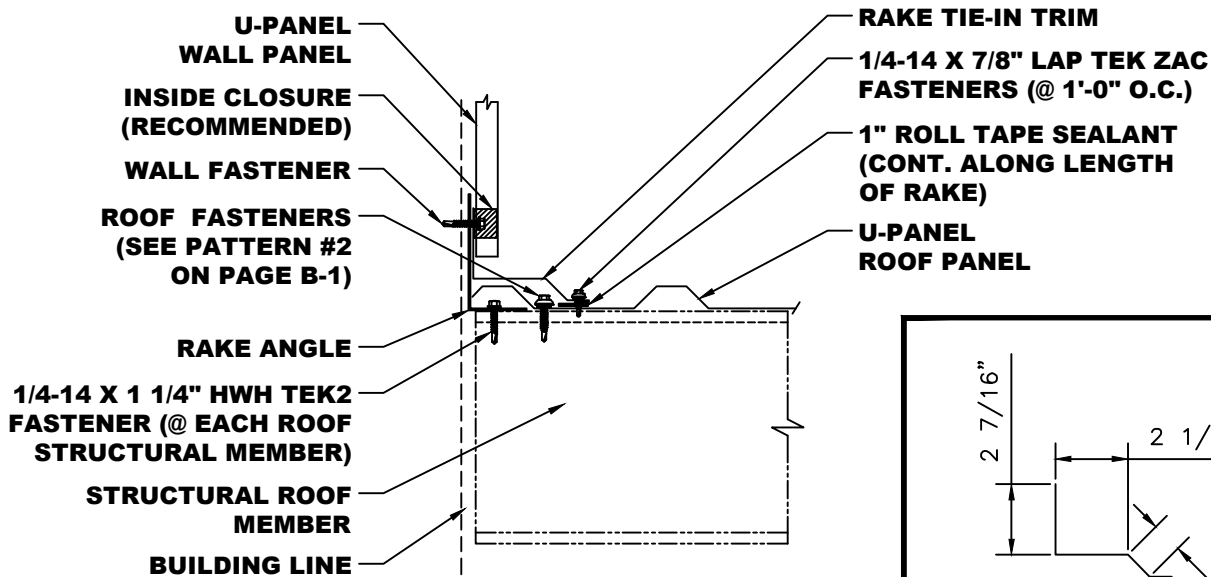

RAKE TIE-IN TRIM

- NOTES:**
1. Attach U-Panel Roof Panels with Roof Fasteners. See Fastener Pattern #2 on page B-1.
 2. Install a continuous line of 1" Butyl Tape Sealant where Rake Tie-In Trim rest on roof panel.
 3. Attach Rake Trim to roof panels with 1/4-14 x 7/8" Lap Tek ZAC Fasteners at 1'-0" O.C. Make sure fastener penetrates sealant.
 4. Trim pieces lap 2". Apply 3/32" x 3/8" Butyl Tape or Butyl Tube Sealant at trim laps and secure trim joint with 1/4-14 x 7/8" Lap Tek ZAC Fasteners at 4" O.C.

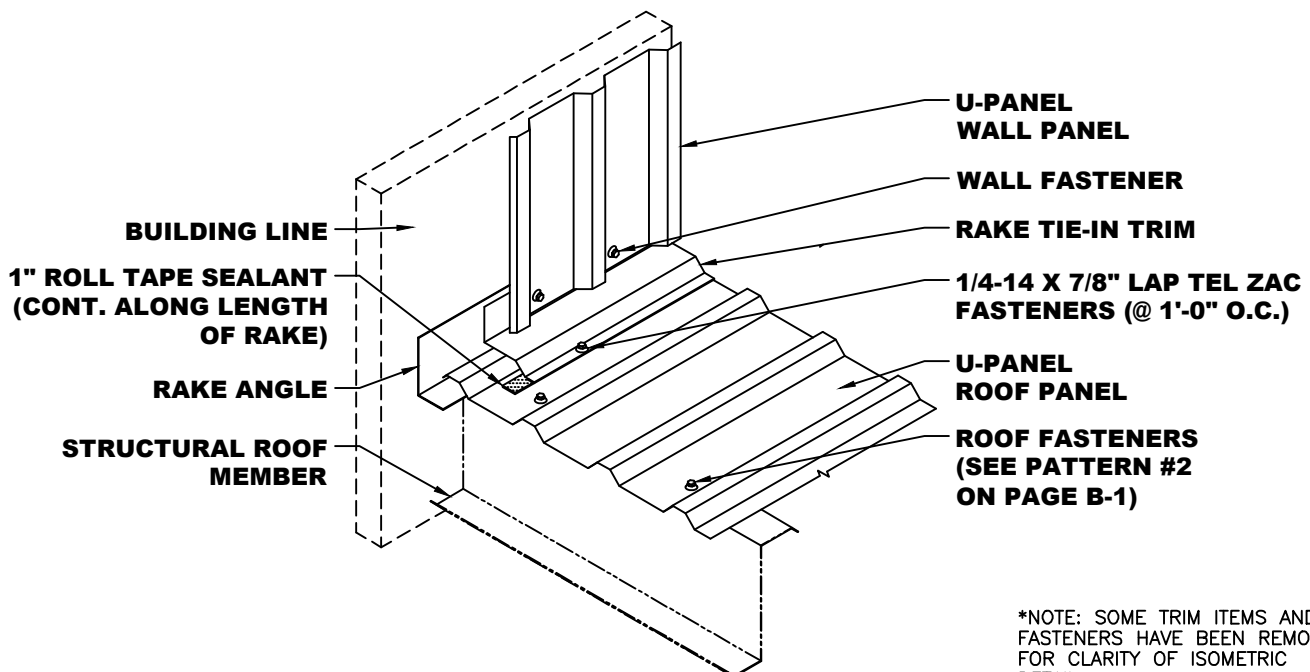

*NOTE: SOME TRIM ITEMS AND FASTENERS HAVE BEEN REMOVED FOR CLARITY OF ISOMETRIC DETAIL.

**OUTSIDE CLOSURE W/
1" ROLL TAPE SEALANT
(TOP & BOTTOM)**

**U-PANEL
ROOF PANEL**

**STRUCTURAL EAVE
MEMBER**

**1/4-14 X 7/8" LAP TEK ZAC
FASTENERS (@ MAJOR RIBS)**

**ROOF FASTENERS
(SEE PATTERN #1
ON PAGE B-1)**

**HIGH SIDE
EAVE TRIM**

**WALL FASTENER
(SEE PATTERN #1
ON PAGE B-1)**

**1/4-14 X 7/8" LAP TEK
FASTENERS (@ MAJOR RIBS)**

**OUTSIDE CLOSURE
(RECOMMENDED)**

**U-PANEL
WALL PANEL**

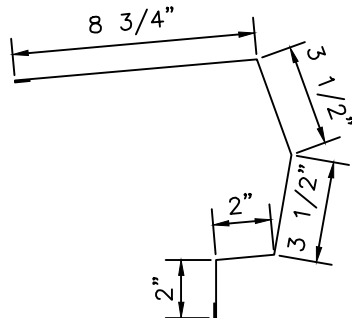

HIGH SIDE EAVE TRIM

- NOTES:**
1. Attach Wall Panels to Eave Structural Member with Wall Fasteners using Fastener Pattern #1 on page B-1.
 2. Attach U-Panel Roof Panels with Roof Fasteners. See Fastener Pattern #1 on page B-1.
 3. Install a continuous line of 1" Butyl Tape Sealant below fasteners. Seat Outside Closures in tape sealant. Install another continuous line of 1" Tape Sealant on top of closures.
 4. Attach High Side Eave Trim to roof panels with 1/4-14 x 7/8" Lap Tek ZAC Fasteners at major ribs. Make sure fastener penetrates sealant.
 5. Trim pieces lap 2". Apply 3/32" x 3/8" Butyl Tape or Butyl Tube Sealant at trim laps and secure trim joint with 1/4-14 x 7/8" Lap Tek ZAC Fasteners at 4" O.C.

**1/4-14 X 7/8" LAP TEK ZAC
FASTENERS (@ MAJOR RIBS)**

**U-PANEL
ROOF PANEL**

**HIGH SIDE
EAVE TRIM**

**OUTSIDE CLOSURE W/
1" ROLL TAPE SEALANT
(TOP & BOTTOM)**

**ROOF FASTENERS
(SEE PATTERN #1
ON PAGE B-1)**

**STRUCTURAL EAVE
MEMBER**

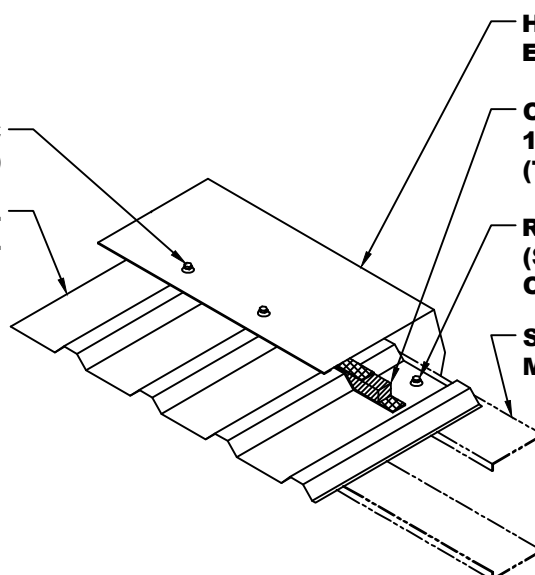

*NOTE: SOME TRIM ITEMS AND
FASTENERS HAVE BEEN REMOVED
FOR CLARITY OF ISOMETRIC
DETAIL.

**1/4-14 X 7/8" LAP TEK ZAC
FASTENER (@ MAJOR RIBS)**

HIGH SIDE TIE-IN TRIM

**OUTSIDE CLOSURE W/
1" ROLL TAPE SEALANT
(TOP & BOTTOM)**

**U-PANEL
ROOF PANEL**

**U-PANEL
WALL PANEL**

WALL FASTENER

**WALL STRUCTURAL
MEMBER**

**INSIDE CLOSURE
(RECOMMENDED)**

**ROOF FASTENERS
(SEE PATTERN #1
ON PAGE B-1)**

**ROOF STRUCTURAL
MEMBER**

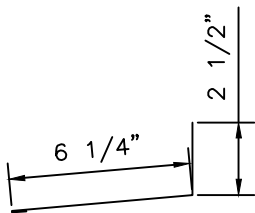

HIGH SIDE TIE-IN TRIM

- NOTES:**
1. Attach U-Panel Roof Panels with Roof Fasteners. See Fastener Pattern #1 on page B-1.
 2. Install a continuous line of 1" Butyl Tape Sealant. Seat Outside Closures in tape sealant. Install another continuous line of 1" Tape Sealant on top of closures.
 3. Attach High Side Tie-In Trim to roof panels with 1/4-14 x 7/8" Lap Tek Fasteners at major ribs. Make sure fastener penetrates sealant.
 4. Trim pieces lap 2". Apply 3/32" x 3/8" Butyl Tape or Butyl Tube Sealant at trim laps and secure trim joint with 1/4-14 x 7/8" Lap Tek Fasteners at 4" O.C.

**U-PANEL
WALL PANEL**

WALL FASTENER

**1/4-14 X 7/8" LAP TEK ZAC
FASTENER (@ MAJOR RIBS)**

HIGH SIDE TIE-IN TRIM

**U-PANEL
ROOF PANEL**

**ROOF FASTENER
(SEE PATTERN #1
ON PAGE B-1)**

**OUTSIDE CLOSURE W/
1" ROLL TAPE SEALANT
(TOP & BOTTOM)**

**STRUCTURAL WALL
MEMBER**

**STRUCTURAL EAVE
MEMBER**

*NOTE: SOME TRIM ITEMS AND
FASTENERS HAVE BEEN REMOVED
FOR CLARITY OF ISOMETRIC
DETAIL.

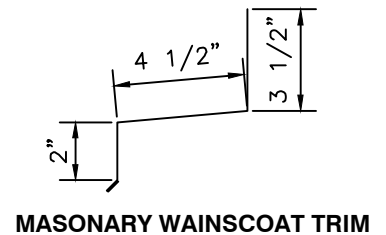
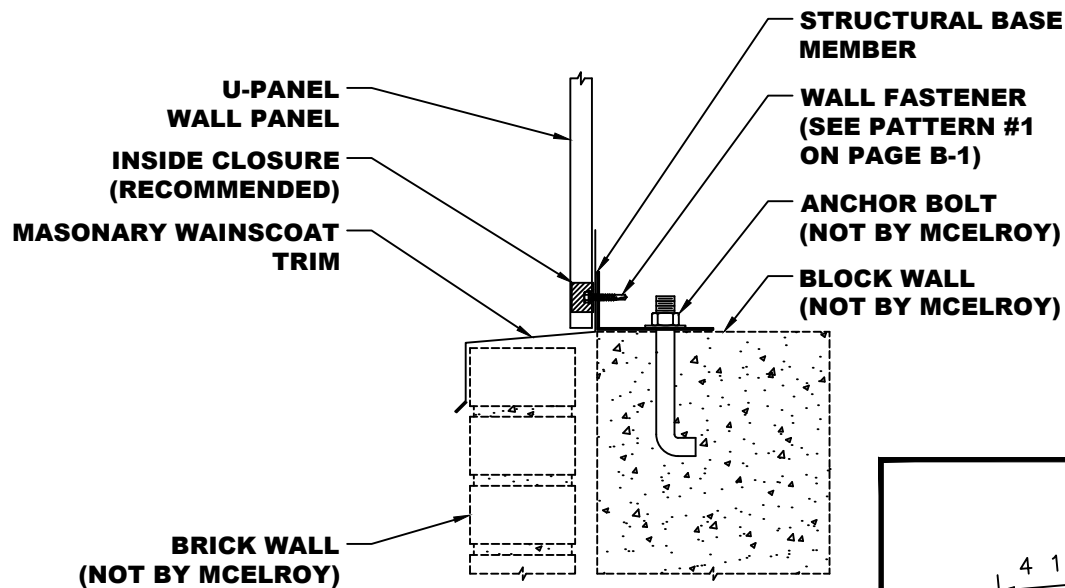

- NOTES:**
1. Attach Masonry Waincoat Trim to Base Structural Member with Temporary Framing Fasteners.
 2. Set Inside Closure in place.
 3. Attach U-Panel Wall Panels with Wall Fasteners. See Fastener Pattern #1 on page B-1.

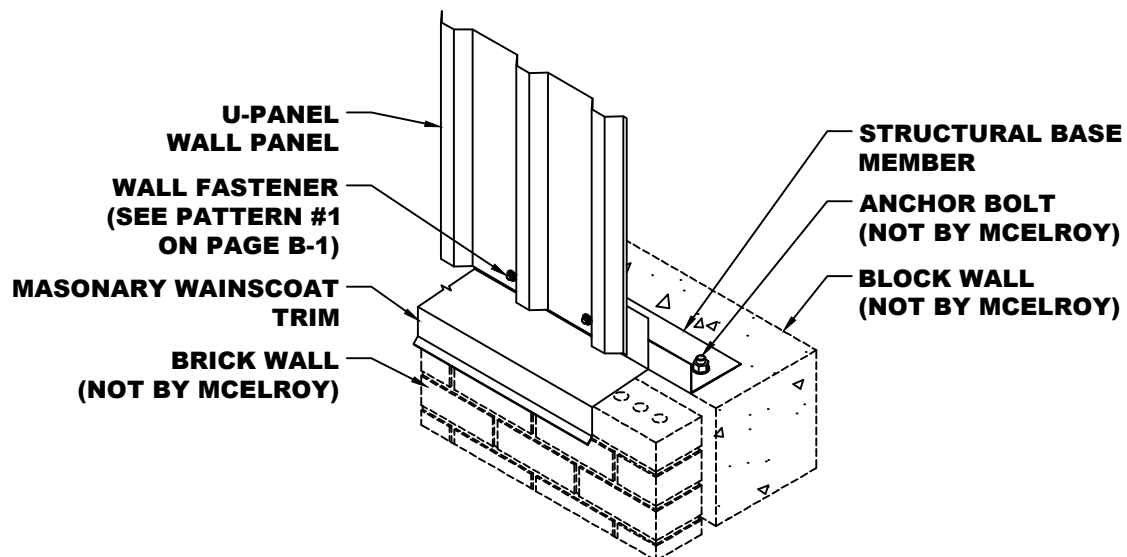

*NOTE: SOME TRIM ITEMS AND FASTENERS HAVE BEEN REMOVED FOR CLARITY OF ISOMETRIC DETAIL.

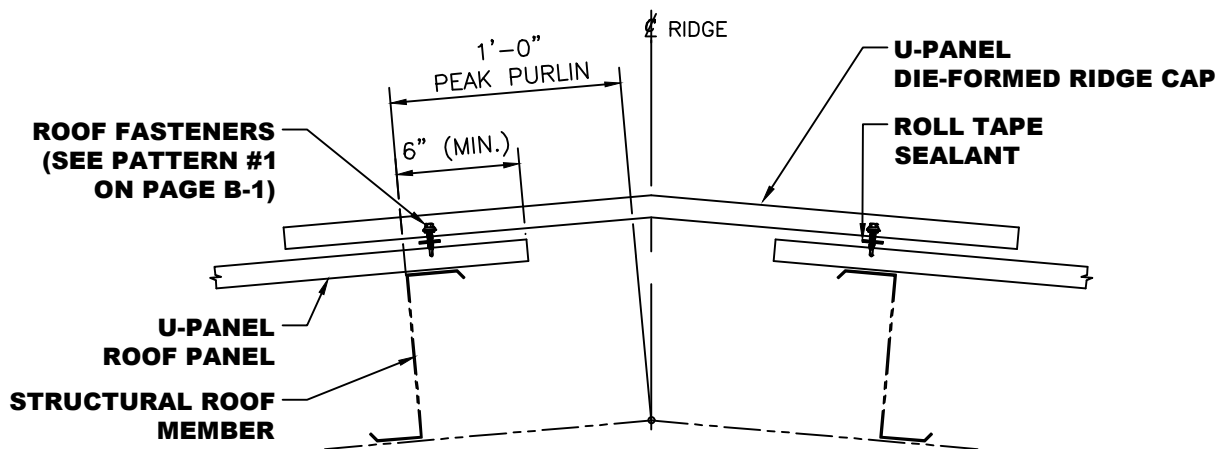

- NOTES:** 1. Install a continuous line of 1" Butyl Tape Sealant along Ridge.
 2. Attach U-Panel Die-Formed Ridge Cap using Roof Fasteners. See Fastener Pattern #1 on page B-1. (Make sure fasteners penetrate Butyl Tape Sealant.)

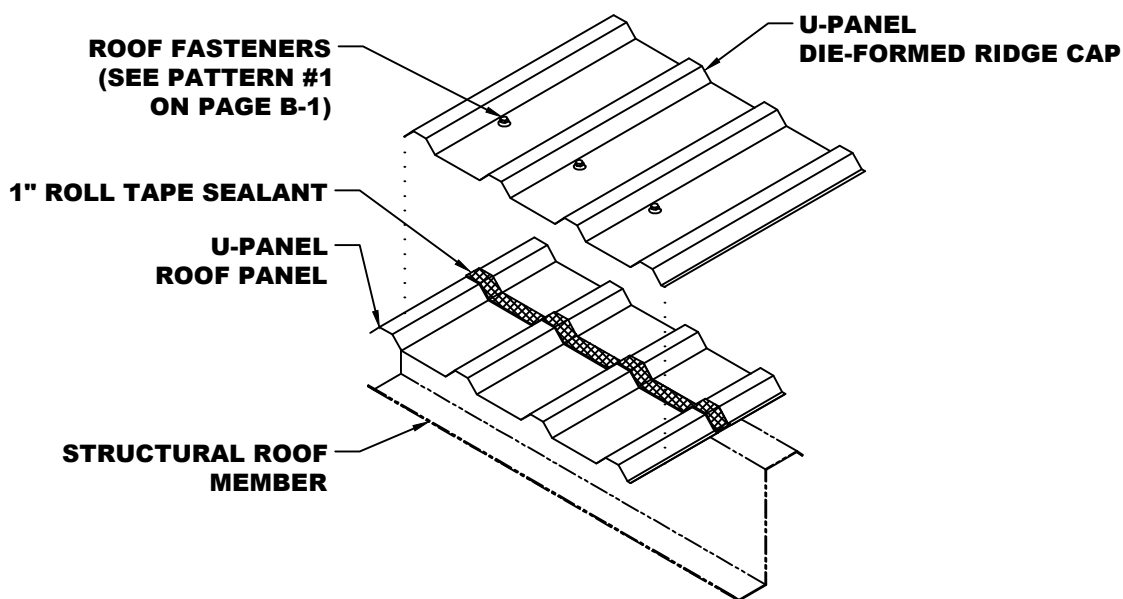

*NOTE: SOME TRIM ITEMS AND FASTENERS HAVE BEEN REMOVED FOR CLARITY OF ISOMETRIC DETAIL.

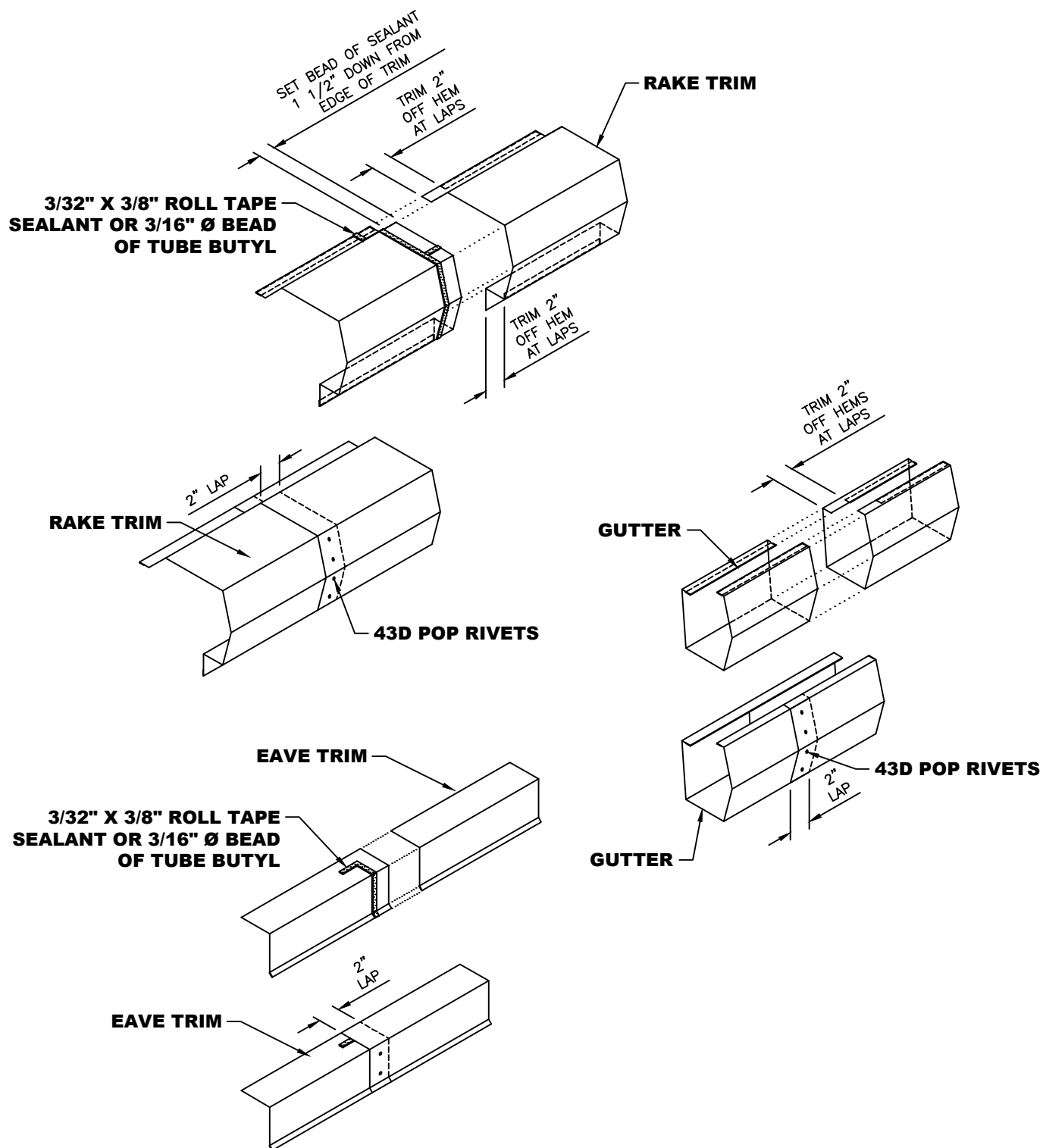

NOTE: 1. Apply 3/32" x 3/8" Roll Tape Sealant or a 3/16" Ø bead of Tube Butyl 1 1/2" back from the edge of the trim. Also, apply a piece of tape sealant or bead of Tube Butyl as a Pigtail to completely seal joint.
 2. Notch the hems on the upper trim piece 2" so that the trim will fit flat in the lap joint.
 3. Secure trim laps with Pop Rivets as shown above.



☆ MANUFACTURING LOCATIONS ● SERVICE CENTERS ★ MANUFACTURING AND SERVICE CENTER



CORPORATE OFFICE
1500 HAMILTON RD.
BOSSIER CITY, LA 71111

MANUFACTURING LOCATIONS

ADELANTO, CA	ASHBURN, GA	BOSSIER CITY, LA	CLINTON, IL	DIAMOND, MO
HOUSTON, TX	LEWISPORT, KY	LOCKHART, TX	MARSHALL, MI	MAUSTON, WI
MERKEL, TX	PEACHTREE CITY, GA	SUNNYVALE, TX	WINCHESTER, VA	

MCELROY METAL
SERVICE
CENTER
EMPLOYEE OWNED

17031 Koala Road
Adelanto, CA 92301

3052 Yadkin Road
Chesapeake, VA 23323

409 Lovejoy Road
Ft. Walton Beach, FL 32548

10504 E. 59th Street
Indianapolis, IN 46236

1020 Veterans Street
Mauston, WI 53948

613 North Bierdeman Rd.
Pearl, MS 39208

8200 Berry Ave. Suite 100
Sacramento, CA 95828

325 McGhee Rd.
Winchester, VA 22603

5215 Leo St.
Alexandria, LA 71301

9476 Meadowbrook Rd.
Clinton, IL 61727

3014 Lincoln Court
Garland, TX 75041

32 Industrial Circle
Lancaster, PA 17601

5123 Terminal Dr.
McFarland, WI 53558

8511 Industrial Drive
Pearland, TX 77584

1365 Dean Forest Rd.
Savannah, GA 31405

1007 Wilso Dr,
Baltimore, MD 21223

3215 Highway 59
Diamond, MO 64840

1440 Aldine Bender Road
Houston, TX 77032

9435 US Hwy. 60 W.
Lewisport, KY 42351

514 Cave Road
Nashville, TN 37210

2755 Hwy 60
Pendergrass, GA 30567

7355 Oakley Industrial Blvd.
Union City, GA 30291

1500 Hamilton Rd.
Bossier City, LA 71111

390 N. Valley Dell Dr.
Fenton, MO 63026

221 Benelli Drive
Hutto, TX 78634

2701 Cahill Street
Lockhart, TX 78644

8304 Hwy. 70 E.
North Little Rock, AR 72117

7450 Tower Street
Richland Hills, TX 76118

1144 Silstar Rd.
West Columbia, SC 29170

Website: www.mcelroymetal.com • E-mail: info@mcelroymetal.com